

Dryer

User manual

DV45DG6000**

SAMSUNG

Contents

Safety information	4
What you need to know about the safety instructions	4
Important safety symbols	4
CALIFORNIA PROPOSITION 65 WARNING	7
IMPORTANT SAFETY INSTRUCTIONS	8
Warnings	9
Cautions	9
Regulatory notice	11
FCC Notice	11
IC Notice	12
Open Source Announcement	13
Installation requirements	14
Key installation requirements	14
Location considerations	14
Ducting requirements (Not applicable to ventless (heat pump) models)	19
Exhausting requirements (Not applicable to ventless (heat pump) models)	20
Gas requirements (Not applicable to ventless (heat pump) models)	21
Electrical requirements	22
Installation	24
What's included	24
Step-by-step installation	26
Draining directly into a drainage system	30
Installation checklist	33
Before using the dryer	33
Exhaust ducting guide (Not applicable to ventless (heat pump) models)	34
Door reversal	34
Before you start	39
Sort and load	39
Functional prerequisite	39

Operations	40
Control panel	40
Simple steps to start	43
Cycle overview	43
Cycle chart	45
Cycle guide	46
Special features	47
SmartThings	48
Maintenance	49
Emptying the water tank	49
Installing the Micro soft filter (Optional Filter)	50
Cleaning	51
Troubleshooting	57
Checkpoints	57
Information codes	59
Specifications	60
Fabric care chart	60
Protecting the environment	61
Specification sheet	61

Safety information

Congratulations on your new Samsung dryer. This manual contains important information on the installation, use and care of your appliance. Please take some time to read this manual to take full advantage of your dryer's many benefits and features.

What you need to know about the safety instructions

Please read this manual thoroughly to ensure that you know how to safely and efficiently operate the extensive features and functions of your new appliance. Please store the manual in a safe location close to the appliance for future reference. Use this appliance only for its intended purpose as described in this instruction manual.

Warnings and Important Safety Instructions in this manual do not cover all possible conditions and situations that may occur. It is your responsibility to use common sense, caution and care when installing, maintaining and operating your dryer.

Because the following operating instructions cover various models, the characteristics of your dryer may differ slightly from those described in this manual and not all warning signs may be applicable. If you have any questions or concerns, contact your nearest service center or find help and information online at www.samsung.com.

Important safety symbols

What the icons and signs in this user manual mean:

WARNING

Hazards or unsafe practices that may result in severe personal injury, death and/or property damage.

CAUTION

Hazards or unsafe practices that may result in personal injury and/or property damage.

NOTE

Indicates that a risk of personal injury or material damage exists.

These warning signs are here to prevent injury to yourself and others.

Please follow them explicitly.

After reading this manual, store it in a safe place for future reference.

Read all instructions before using the appliance.

As with any equipment that uses electricity and moving parts, potential hazards exist. To safely operate this appliance, familiarize yourself with its operation and exercise care when using it.

SAVE THESE INSTRUCTIONS

WARNING - Risk of Fire

- Clothes dryer installation must be performed by a qualified installer.
- Install the clothes dryer according to the manufacturer's instructions and local codes.
- Do not install a clothes dryer with flexible plastic venting materials. If flexible metal (foil type) duct is installed, it must be of a specific type identified by the appliance manufacturer as suitable for use with clothes dryers. Flexible venting materials are known to collapse, be easily crushed, and trap lint. These conditions will obstruct clothes dryer airflow and increase the risk of fire.
- Do not install a booster fan in the exhaust duct.
- To reduce the risk of severe injury or death, follow all installation instructions.
- Save these instructions.

SAVE THESE INSTRUCTIONS

Safety information

WARNING - To reduce the risk of fire or explosion:

- Do not dry items that have been previously cleaned, washed, soaked, or spotted with gasoline, dry cleaning solvents, or other flammable or explosive substances. They emit vapors that could ignite or explode. Any material that has been in contact with a cleaning solvent or flammable liquids or solids should not be placed in the dryer until all traces of these flammable liquids or solids and their fumes have been removed. There are many highly flammable items used in homes, such as acetone, denatured alcohol, gasoline, kerosene, some liquid household cleaners, some spot removers, turpentine, waxes, and wax removers.
- Items containing foam rubber (which may be labeled latex foam) or similarly textured rubberlike materials must not be dried on a heat setting. Heated foam rubber materials can, under certain circumstances, ignite spontaneously.

SAVE THESE INSTRUCTIONS

WARNING - Fire or explosion hazard

- Failure to follow safety warnings exactly could result in serious injury, death or property damage.
- Do not store or use gasoline or other flammable vapors and liquids near this or any other appliance.
- Installation and service must be performed by a qualified installer, service agency, or the gas supplier.
- Do not install a booster fan in the exhaust duct.

WARNING - What to do if you smell gas:

- Do not try to light any appliance.
- Do not turn on the appliance.
- Do not touch any electrical switch.
- Do not use any phone in your building.
- Clear the room, building or area of all occupants.
- Immediately call your gas supplier from a neighbor's phone. Follow the gas supplier's instructions.
- If you cannot reach your gas supplier, call the fire department.

CALIFORNIA PROPOSITION 65 WARNING

WARNING

Cancer and Reproductive Harm - www.P65Warnings.ca.gov.

SAVE THESE INSTRUCTIONS

Safety information

IMPORTANT SAFETY INSTRUCTIONS

WARNING

To reduce the risk of fire, electric shock, or injury to persons when using your appliance, follow basic precautions, including the following:

1. Read all instructions before using this appliance.
2. Do not dry articles that have been previously cleaned in, washed in, soaked in, or spotted with gasoline, dry-cleaning solvents, or other flammable or explosive substances, as they give off vapours that could ignite or explode.
3. Risk of Suffocation and Injury from Entrapment: Do not allow children to play on or in the appliance. Close supervision of children is necessary when the appliance is used near children.
4. Before the appliance is removed from service or discarded, remove the door to the drying compartment.
5. Do not reach into the appliance if the drum is moving.
6. Do not install or store this appliance where it will be exposed to the weather.
7. Do not tamper with controls.
8. Do not repair or replace any part of the appliance or attempt any servicing unless specifically recommended in the user-maintenance instructions or in published user-repair instructions that you understand and have the skills to carry out.
9. Do not use fabric softeners or products to eliminate static unless recommended by the manufacturer of the fabric softener or product.
10. Do not use heat to dry articles containing foam rubber or similarly textured rubber-like materials.
11. Clean lint screen before or after each load.
12. Keep area around the exhaust opening and adjacent surrounding areas free from the accumulation of lint, dust, and dirt.
13. The interior of the appliance and exhaust duct should be cleaned periodically by qualified service personnel.
14. Do not place items exposed to cooking oils in your dryer. Items contaminated with cooking oils may contribute to a chemical reaction that could cause a load to catch fire. To reduce the risk of fire due to contaminated loads, the final part of a tumble dryer cycle occurs without heat (cool down period). Avoid stopping a tumble dryer before the end of the drying cycle unless all items are quickly removed and spread out so that the heat is dissipated.
15. Do not use replacement parts that have not been recommended by the manufacturer (e.g. parts made at home using a 3D printer).
16. (For Heat pump Clothes dryer) Sharp Edges – to reduce the risk of injury, use care when cleaning the condenser or evaporator coil fins.

SAVE THESE INSTRUCTIONS

Warnings

WARNING

- Ensure pockets are free of small, irregularly shaped hard objects and foreign material, i.e. coins, knives, pins, etc. These objects could damage your dryer.
- Gas leaks may occur in your system, resulting in a dangerous situation.

Cautions

CAUTION

- Do not allow children or pets to play on, in, or in front of the appliance. Close supervision is necessary when the appliance is used near children and pets.
- Before discarding or removing your dryer from service, remove the door to the drying compartment to prevent children or animals from becoming trapped inside.
- Do not reach into the appliance when the drum is moving.
- Do not install or store this appliance where it will be exposed to the weather.
- Do not tamper with the controls.
- Do not repair, replace, or attempt to service any part of the appliance unless specifically instructed to in the user-repair instructions and you have the understanding and skills to carry out the procedure.
- Do not use fabric softeners or products to eliminate static unless the softener or product is recommended for dryer use by the manufacturer of the fabric softener or product.
- Clean the lint screen before or after each load.
- Keep the area around the exhaust opening and surrounding areas free from lint, dust, and dirt.
- The interior of the dryer and exhaust duct should be cleaned periodically by qualified service personnel.
- This appliance must be properly grounded. Never plug the power cord into a receptacle that is not grounded adequately or not in accordance with local and national codes. See the installation instructions for information about grounding this appliance.
- Do not sit on top of the dryer.
- Do not dry clothing with large buckles, buttons, or other heavy metal or solid objects.
- Gas leaks may not be detected by smell alone.
- Gas suppliers recommend you purchase and install a UL-approved gas detector.
- Install and use in accordance with the manufacturer's instructions.
- Do not place items in your dryer that have been spotted or soaked with vegetable oil or cooking oil. Even after being washed, these items may contain significant amounts of these oils.

SAVE THESE INSTRUCTIONS

Safety information

- Residual oil on clothing can ignite spontaneously. The potential for spontaneous combustion increases when items containing vegetable oil or cooking oil are exposed to heat. Heat sources such as your dryer can warm these items, allowing an oxidation reaction in the oil to occur. Oxidation creates heat. If this heat cannot escape, the items can become hot enough to catch fire. Piling, stacking, or storing these kinds of items may prevent heat from escaping and can create a fire hazard.
- All washed and unwashed fabrics that contain vegetable oil or cooking oil can be dangerous. Washing these items in hot water with extra detergent will reduce, but not eliminate, the hazard. Always use the Cool Down cycle for these items to reduce their temperature. Never remove these items from the dryer hot or interrupt the drying cycle until the items have run through the Cool Down cycle. Never pile or stack these items when they are hot.

SAVE THESE INSTRUCTIONS

Regulatory notice

FCC Notice

CAUTION

Any changes or modifications not expressly approved by the party responsible for compliance could void the user's authority to operate the equipment.

This device complies with Part 15 of FCC Rules. Operation is Subject to following two conditions:

1. This device may not cause harmful interference, and
2. This device must accept any interference received including interference that cause undesired operation.

For products sold in the US and Canadian markets, only channels 1–11 are available. You cannot select any other channels.

FCC STATEMENT:

This equipment has been tested and found to comply within the limits for a Class B digital device, pursuant to part 15 of the FCC Rules. These limits are designed to provide reasonable protection against harmful interference in a residential installation.

This equipment generates, uses, and can radiate radio frequency energy and, if not installed and used in accordance with the instructions, may cause harmful interference to radio communications. However, there is no guarantee that interference will not occur in a particular installation. If this equipment does cause harmful interference to radio or television reception, which can be determined by turning the equipment off and on, the user is encouraged to try to correct the interference by one or more of the following measures:

- Reorienting or relocating the receiving antenna
- Increasing the separation between the equipment and receiver
- Connecting the equipment to an outlet that is on a different circuit than the radio or TV.
- Consulting the dealer or an experienced radio/TV technician for help.

FCC RADIATION EXPOSURE STATEMENT:

This equipment complies with FCC radiation exposure limits set forth for an uncontrolled environment. This equipment should be installed and operated so there is at least 8 inches (20 cm) between the radiator and your body. This device and its antenna(s) must not be colocated or operated in conjunction with any other antenna or transmitter.

SAVE THESE INSTRUCTIONS

Regulatory notice

IC Notice

The term "IC" before the radio certification number only signifies that Industry Canada technical specifications were met. Operation is subject to the following two conditions:

1. This device may not cause interference, and
2. This device must accept any interference, including interference that may cause undesired operation of the device.

This Class B digital apparatus complies with Canadian ICES-003.

Cet appareil numérique de la classe B est conforme à la norme NMB-003 du Canada.

For products sold in the US and Canadian markets, only channels 1–11 are available. You cannot select any other channels.

IC RADIATION EXPOSURE STATEMENT:

This equipment complies with IC RSS-102 radiation exposure limits set forth for an uncontrolled environment. This equipment should be installed and operated so there is at least 8 inches (20 cm) between the radiator and your body. This device and its antenna(s) must not be colocated or operated in conjunction with any other antenna or transmitter.

SAVE THESE INSTRUCTIONS

Open Source Announcement

The software included in this product contains open source software. You may obtain the complete corresponding source code for a period of three years after the last shipment of this product by sending an email to <mailto:oss.request@samsung.com>.

It is also possible to obtain the complete corresponding source code in a physical medium such as a CD-ROM; a minimal charge will be required.

The following URL http://opensource.samsung.com/opensource/SMART_AT_051/seq/0 leads to the download page of the source code made available and open source license information as related to this product. This offer is valid to anyone in receipt of this information.



NOTE

Hereby, Samsung Electronics, declares that the radio equipment type appliance is in compliance with Directive 2014/53/EU. The full text of the EU declaration of conformity is available at the following internet address: The official Declaration of conformity may be found at <http://www.samsung.com>, go to Support > Search Product Support and enter the model name.

Wi-Fi max transmitter power : 20 dBm at 2.412 GHz – 2.472 GHz

SAVE THESE INSTRUCTIONS

Installation requirements

Read through the following instructions before installing the dryer and keep this manual for future reference.

WARNING

Certain internal parts are intentionally not grounded and may present a risk of electric shock only during servicing.

Service Personnel - Do not contact the following parts while the appliance is energized: Control board and inlet valve.

Key installation requirements

- A grounded electrical outlet.
- A power cord for electric dryers (except in Canada).
- Gas lines (for gas models) that meet national and local regulations.
- An exhaust system made of rigid metal or flexible stiff-walled metal exhaust duct. (Not applicable to ventless (heat pump) models)

WARNING

Remove the door from all discarded appliances to prevent a child from suffocating.

Location considerations

The dryer should be located where there is enough space at the front for loading the dryer and behind space behind for the exhaust system. This dryer is factory-ready for the rear exhaust option. To exhaust out the bottom, right or the left, use the accessory exhaust kit. Instructions are included with the kit. Make sure the room in which the dryer is located has enough fresh air. The dryer must be located where there are no air-flow obstructions. For gas dryers, adequate clearance must be maintained as noted on the data plate to ensure adequate air for combustion and the proper dryer operation.

The dryer must not be installed or stored in an area where it will be exposed to water and/or weather. The dryer area must be kept clear of combustible materials, gasoline, and other flammable vapors and liquids. A dryer produces combustible lint. The area around the dryer should be kept lint-free.

Dimensions

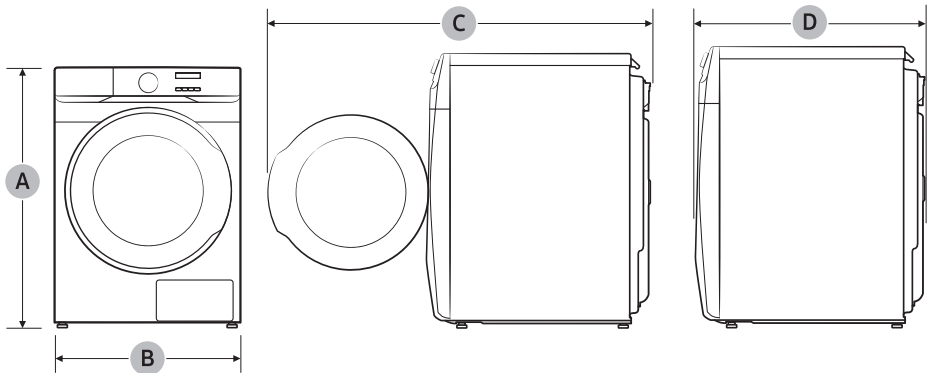

Type		Front loading dryer
Models		DV45DG6000**
Dimensions (in. (mm))	A. Overall height	38.7 (984)
	B. Width	27 (686)
	C. Depth with the door open	54.2 (1378)
	D. Depth	33.2 (844)

Installation requirements

Clearance requirement

This clearance requirement is applicable for dryers only.

 **NOTE**

- For the washer's clearance requirement, see the washer's user manual.
- If the washer and dryer have different clearance requirements, use the one with the larger value.

Alcove or closet installations

 **WARNING**

- The dryer must be exhausted to the outside to reduce the risk of fire when installed in an alcove or closet.
- No other fuel-burning appliance should be installed in the same closet as the dryer.
- Place the dryer at least 18 in. (460 mm) above the floor for a garage installation.

Minimum clearance for stable operation:

Sides	Top	Rear	Front
1 in. (25 mm)	1 in. (25 mm)	2 in. (50 mm)	1 in. (25 mm)

If both the washer and a dryer are installed in the same location, the front of the alcove or closet must have two unobstructed air openings for a combined minimum total area of 72 in.² (465 cm²).

Undercounter installation

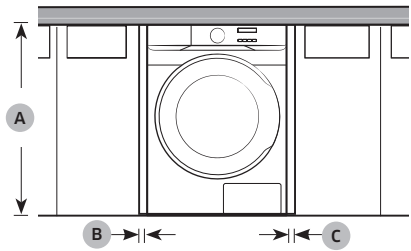

A	39.7 in. (1009 mm)
B	1 in. (25 mm)
C	1 in. (25 mm)

Pedestal installation

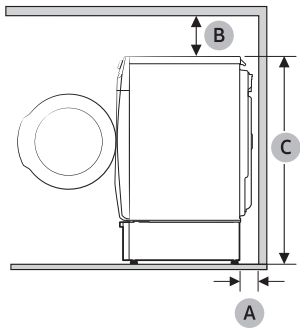

A	2 in. (50 mm)
B	6 in. (152 mm)
C	52.8 in. (1341 mm)

Installation requirements

This clearance requirement is applicable for washer and dryer pair installation.

Side-by-side installation

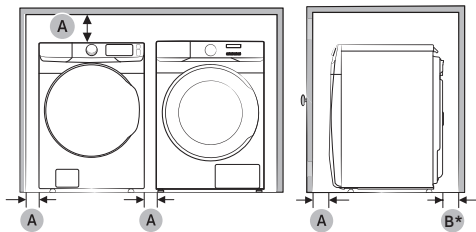

Stacked installation

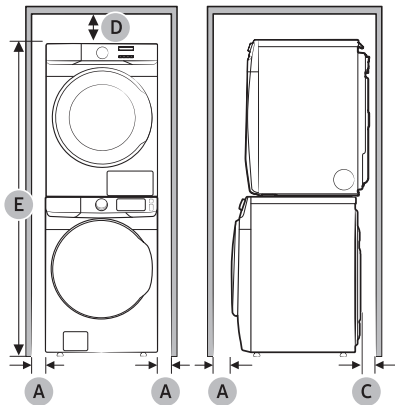

A	1 in. (25 mm)
B*	2 in. (50 mm)
C	5.1 in. (129 mm)
D	6 in. (152 mm)
E	77.5 in. (1968 mm)

(B*): This clearance requirement only applies to the dryer. For the washer's clearance requirement, see the washer's user manual.

NOTE

Stacking (SKK-8HK)

Many of Samsung's washers and dryers can be stacked to maximize usable space. You can purchase an optional stacking kit from your Samsung retailer. For details about stacking and compatible models, refer to the user manual included in the stacking kit you purchase.

Ducting requirements (Not applicable to ventless (heat pump) models)

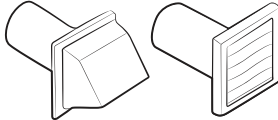
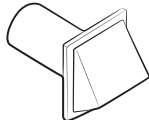
Weather hood type	Recommended	Use only for short-run installation
	 4" (10.2 cm)	 2.5" (6.4 cm)
No. of 90° elbows	Rigid	Rigid
0	80 ft. (24.4 m)	74 ft. (22.6 m)
1	68 ft. (20.7 m)	62 ft. (18.9 m)
2	57 ft. (17.4 m)	51 ft. (15.5 m)
3	47 ft. (14.3 m)	41 ft. (12.5 m)

NOTE

* Use a 4-inch (10.2 cm) diameter rigid aluminum or galvanized steel duct.

If you integrate the dryer's vent system with an existing exhaust system:

- Make sure the exhaust system meets all applicable local, state, and national regulations.
- Verify you are not using a flexible plastic duct.
- Make sure to check for and remove all lint buildup from inside the existing ducts.
- Confirm the duct is not kinked or crushed.
- Make sure the exhaust hood damper opens and closes freely.

Manometer measurements

The static pressure in any exhaust system must not exceed 0.83 inches of water column or be less than 0. Note that these values are measured with the dryer running with a manometer presented to the exhaust duct that connects to the dryer. The dryer's drum must be empty and the lint filter must be clean.

Installation requirements

Exhausting requirements (Not applicable to ventless (heat pump) models)

The dryer must not be exhausted into a chimney, a wall, a ceiling, an attic, a crawl space, or a concealed space of a building. Exhausting the dryer to the outside will prevent large amounts of lint and moisture from being blown into the room.

In the United States and Canada

- All dryers must be exhausted to the outside.
- The required exhaust duct is 4 inches (10.2 cm) in diameter.
- See the **"Ducting requirements (Not applicable to ventless (heat pump) models)"** section for the maximum duct length and number of elbows that can be used.
- The total length of the flexible metal duct must not exceed 7'10½" (2.4 m).
- Do not assemble the duct with screws or other fasteners that extend into the duct and catch lint.
- **For the United States only:** Use only those foil-type flexible ducts, if any, specifically identified for use with the appliance by the manufacturer and that comply with the Outline for Clothes Dryer Transition Duct. Use Subject 2158A.

Outside the United States and Canada

- Refer to the local codes.

WARNING

- You must exhaust the dryer to the outside to reduce the risk of fire when you install the dryer in an alcove or closet.
- Do not use a plastic or non-metal flexible duct.
- If your existing ductwork is plastic, non-metal, or combustible, replace it with metal.
- Use only a metal exhaust duct that is non-flammable to ensure containment of exhaust air, heat, and lint.

Gas requirements (Not applicable to ventless (heat pump) models)

WARNING

- Use only natural or LP (liquid propane) gases.
- The installation must be conformed with local codes, or in the absence of local codes, with the national fuel gas code, ANSI Z223.1/NFPA 54, latest revision (for the UNITED STATES), or with the natural gas and propane installation code, CSA B149.1 (for Canada).
- Gas dryers are equipped with a burner vent for use with natural gas. If you plan to use your dryer with LP (liquid propane) gas, it must be converted for safe and proper performance by a qualified service technician. **(LNG models only)**

You must check the burner of your model and use the proper LP Kit accordingly. To check the detail information of the burner, open the door and check the rating label location on the door frame.

- 20,000 BTU: LPKIT-4/XAA (DC98-04114A)
- 22,000 BTU: LPKIT-3/XAA (DC99-00792A)
- A 1/2" (1.27 cm) gas supply line is recommended and must be reduced to connect to the 3/8" (1 cm) gas line on your dryer. The National Fuel Gas Code requires that an accessible, approved manual gas shut-off valve be installed within 6" of your dryer.
- Gas dryers installed in residential garages must be raised 18 inches (46 cm) above the floor.
- Additionally, a 1/8" (0.3 cm) N.P.T. (National Pipe Thread) plugged tapping, accessible for test gauge connection, must be installed immediately upstream of your dryer's gas supply connection.
- Your dryer must be disconnected from the gas supply pipe system during any pressure testing of the system.
- Do not reuse old flexible metal gas lines. Flexible gas lines must be designed and certified by the standard for connectors for Gas Appliances, ANSI Z21.24 • CSA 6.10.

NOTE

- Your dryer uses an automatic ignition system to ignite the burner. There is no constant burning pilot.
- Any pipe joint compound used must be resistant to the action of any liquefied petroleum gas.
- As a courtesy, most local gas utilities will inspect a gas appliance installation.

Commonwealth of Massachusetts installation instructions

Your dryer must be installed by a licensed plumber or gas fitter. A "T" handle manual gas valve must be installed in the gas supply line to your dryer. If a flexible gas connector is used to install your dryer, the connector can be no longer than 3' (36").

WARNING

- Gas leaks may occur in your system, creating a dangerous situation.
- Gas leaks may not be detected by smell alone.
- Gas suppliers recommend you purchase and install a UL-approved gas detector.
- Install and use in accordance with the manufacturer's instructions.

Installation requirements

Electrical requirements

The wiring diagram is located on the plate under the control panel or rear frame.

WARNING

When local codes allow, you can connect the dryer's electrical supply with a new power supply cord kit, marked for use with a dryer, that is U.L. listed and rated at a minimum of 120 / 240 volts, 30-amperes with three No. 10 copper wire conductors terminated with closed loop terminals, open-end spade lugs with turned up ends, or with tinned leads.

- Improperly connecting the equipment grounding conductor can result in a risk of electric shock. Check with a qualified electrician or serviceman if you are in doubt as to whether your dryer is properly grounded. Do not modify the plug provided with your dryer – if it doesn't fit the outlet, have a proper outlet installed by a qualified electrician.
- To prevent unnecessary risk of fire, electrical shock, or personal injury, all wiring and grounding must be done in accordance with local codes, or in the absence of local codes, in accordance with the National Electrical Code, ANSI/NFPA No. 70-Latest Revision (for the U.S.) or the Canadian Electrical Code CSA C22.1 – Latest Revisions and local codes and ordinances. It is your responsibility to provide adequate electrical service for your dryer.
- All gas installations must be done in accordance with the National Fuel Code ANSI/Z2231 – Latest Revision (for the U.S.) or CAN/CGA – B149 Installation Codes – Latest Revision (for Canada) and local codes and ordinances.

Grounding

This dryer must be grounded. In the event of a malfunction or breakdown, the ground will reduce the risk of electrical shock by providing a path of least resistance for the electrical current.

Gas models

WARNING

- Your dryer has a cord with an equipment-grounding conductor and a grounding plug. The plug must be plugged into an appropriate outlet that is properly installed and grounded in accordance with all local codes and ordinances.
- Do not modify the plug provided with your dryer – if it doesn't fit the outlet, have a proper outlet installed by a qualified electrician.
- Do not connect the ground wire to plastic plumbing lines, gas lines, or hot water pipes.

Electric models

WARNING

- Your dryer has an optional cord with an equipment-grounding conductor and a grounding plug. This cord is sold separately.
- The plug must be plugged into an appropriate outlet that is properly installed and grounded in accordance with all local codes and ordinances.
- Do not modify the plug provided with your dryer – if it doesn't fit the outlet, have a proper outlet installed by a qualified electrician.

-
- If a power cord is not used and the electric dryer is to be permanently wired, the dryer must be connected to a permanently grounded metal wiring system, or an equipment grounding conductor must be run with the circuit conductors and connected to the equipment grounding terminal or lead on the dryer.

Electrical connections

Before operating or testing, follow all grounding instructions in the "**Grounding**" section. An individual branch (or separate) circuit serving only your dryer is recommended.

Do not use an extension cord.

Gas models – U.S. and Canada

A 120 volt, 60 Hz AC approved electrical service with a 15-ampere fuse or circuit breaker is required.

Electric models – U.S. only

Most U.S. dryers require a 120 / 240 volt, 60 Hz AC approved electrical service. Some require 120 / 208 volt, 60 Hz approved electrical service. The electric service requirements can be found on the data label located behind the door. A 30-ampere fuse or circuit breaker on both sides of the line is required.

- If a power cord is used, the cord should be plugged into a 30-ampere receptacle.
- The power cord is not provided with U.S. electric model dryers. This cord is sold separately.

Risk of Electric Shock

WARNING

When local codes allow, you can connect the dryer's electrical supply with a new power supply cord kit, marked for use with a dryer, that is U.L. listed and rated at a minimum of 120 / 240 volts, 30-amperes with three No. 10 copper wire conductors terminated with closed loop terminals, open-end spade lugs with turned up ends, or with tinned leads.

- Do not reuse a power supply cord from an old dryer. The power cord electric supply wiring must be supported at the dryer cabinet by a suitable UL-listed strain relief.
- Grounding through the neutral conductor is prohibited for (1) new branch-circuit installations, (2) mobile homes, (3) recreational vehicles, and (4) areas where local codes prohibit grounding through the neutral conductor. (Use a 4-prong plug for a 4-wire receptacle, NEMA type 14-30R.)

Electric models – Canada Only

A 120 / 240 volt, 60 Hz AC approved electrical service fused through a 30-ampere fuse or circuit breaker on both sides of the line is required.

NOTE

All Canadian models are shipped with the power cord attached. The power cord should be plugged into a 30-ampere receptacle. In Canada, you may convert a dryer to 120 / 208 volts.

Installation

This dryer must be installed by a qualified technician. The installer is responsible for connecting the dryer to the main power while observing the relevant safety regulations of your area.

What's included

Make sure all the parts are included in the product package. If you have a problem with the dryer or the parts, contact a local Samsung customer center or the retailer.

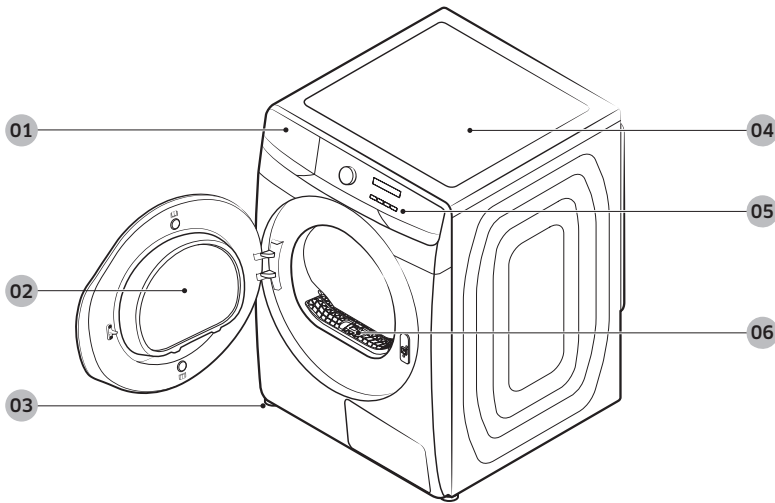

01 Water tank

02 Door

03 Leveling legs

04 Worktop

05 Control panel

06 Lint filter

Accessories (supplied)

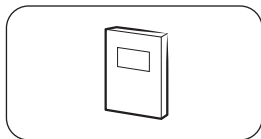

User manual

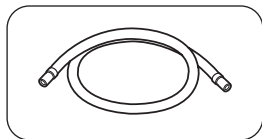

Long drain hose (78.7 in. (2 m))

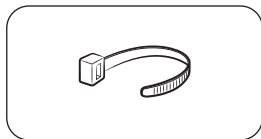

Cable tie

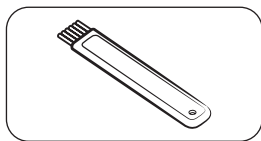

Cleaning brush

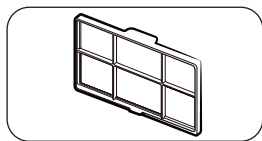

Micro soft filter (Optional Filter)

NOTE

- The stacking kit allows the dryer to be stacked on top of a washer. Please note that the stacking kit can only be used with Samsung washers and dryers. To purchase a stacking kit above, contact a Samsung service center or local appliance retailer. The stacking kit differs with the washer model.
- For stacking instructions with the dryer, see the installation manual included in the stacking kit.
- For information on which stacking kit model you can use to stack your dryer on the washer, see the user manual included in your Samsung washer.

WARNING

Packing materials can be dangerous to children. Keep all packing materials (plastic bags, polystyrene, etc.) out of children's reach.

Installation

Step-by-step installation

Make sure you have a qualified technician install the dryer. Step-by-step installation instructions start below.

- Do not remove the protective film on the door before completing the product installation. If you remove the protective film before the installation is complete, the door may get scratched or damaged during installation.
- Make sure the installation location allows enough space for the dryer door to be fully open.

STEP 1 Install the exhaust system

1. Select a location and move the dryer to the site. For easy access, we recommend you install the dryer in the same location as your washer.
2. To change the door direction, see "**Door reversal**" on page 34.
3. Install the exhaust system as instructed in the "**Exhaust ducting guide (Not applicable to ventless (heat pump) models)**" section. (Not applicable to ventless (heat pump) models)

CAUTION

Before installing your dryer, remove the packing in the duct.

NOTE

- To move the dryer easily, lay two of the carton cushions from the packaging on the floor. Tip the dryer on its side so it lies across both cushion-tops. Push the dryer so that it is near its final location, and then set the dryer upright.
- Secure room around the dryer to facilitate ducting and wiring.

STEP 2 Connect the gas line (for gas models)

Before connecting the gas line, make sure you have read the "**Gas requirements (Not applicable to ventless (heat pump) models)**" section on page 21.

1. Remove the protective cap from the gas pipe.
2. Apply an LPG (Liquefied Petroleum Gas)-safe compound or 1.5 wraps of Teflon tape to all threaded connections.
3. Connect the gas supply to the dryer. An additional fitting is required to connect the $\frac{3}{4}$ " (1.9 cm) female thread end of a flexible connector to the $\frac{3}{8}$ " (1 cm) male threaded end on the dryer. Tighten up the fitting over all threads.
4. Turn on the gas supply, and check for any leaks using a soap solution. If a leak is found, tighten the connections and try again. Do not use an open flame to check for gas leaks.

STEP 3 Connect the electrical wiring (for electric models)

Before connecting the electrical wiring, make sure you have read the "**Electrical requirements**" section on page 22.

3-wire system

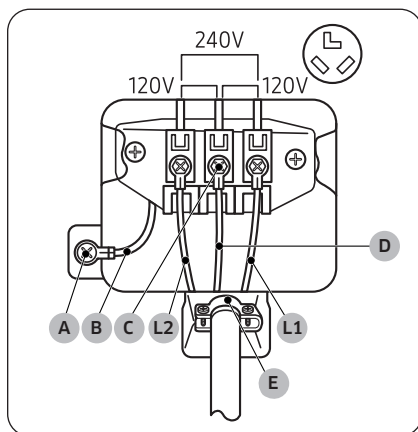

- A. External ground connector
- B. Neutral grounding wire (white)
- C. Center silver-colored terminal block screw
- D. Neutral wire (white or center wire)
- E. $\frac{3}{4}$ " (1.9 cm) UL-listed strain relief

1. Loosen or remove the screws from the center terminal block.
2. Connect the neutral wire (white or center wire) of the power cable to the center, silver-colored terminal screw of the terminal block. Tighten the screws.
3. Connect the other wires to the outer terminal block screws. Tighten the screws.
4. Tighten the strain relief screws.
5. Insert the terminal block cover into the rear panel of the dryer. Then, secure the cover with a hold-down screw.

⚠ CAUTION

- To convert from the 4-wire system to a 3-wire system, connect the ground strap to the terminal block support to ground the dryer frame to the neutral conductor.
- Ring-type terminals are recommended. If using strap terminals, make sure they are tightened.
- Connect the power cord and check the L1/L2/D (N) voltage. If the voltage is low, it may not heat properly. Review the "**Electrical requirements**" section on page 22 if needed.

Installation

4-wire system

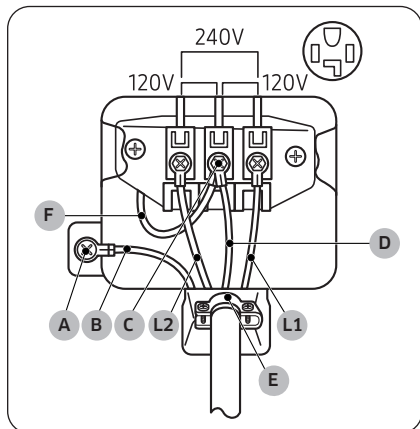

- A. External ground connector
- B. Neutral grounding wire (white)
- C. Center silver-colored terminal block screw
- D. Neutral wire (white or center wire)
- E. $\frac{3}{4}$ " (1.9 cm) UL-listed strain relief
- F. Neutral wire (white or center wire)

1. Remove the external ground connector's screw and connect the ground wire (green or unwrapped) of the power cable to the screw.

⚠ CAUTION

- To connect the ground wire to the neutral position without through contact A (cabinet ground), contact a technician. This is not user serviceable.
- Ring-type terminals are recommended. If using strap terminals, make sure they are tightened.

2. Loosen or remove the screws from the center terminal block.
3. Connect the neutral wire (white or center wire) and ground wire (white) to the center screw of the terminal block. Tighten the screw.
4. Connect the other wires to the outer terminal block screws. Tighten the screws.
5. Tighten the strain relief screws.
6. Insert the tab of the terminal block cover into the rear slot of the dryer. Secure the cover with a hold-down screw.

⚠ CAUTION

Connect the power cord and check the L1/L2/D (N) voltage. If the voltage is low, it may not heat properly. Review the "**Electrical requirements**" section on page 22 if needed.

⚠ WARNING

- All U.S. models are designed for a 3-wire system connection. The dryer frame is grounded to the neutral conductor at the terminal block. A 4-wire system connection is required for new or remodeled construction, mobile homes, or if local codes do not permit grounding through neutral. If you use the 4-wire system, you cannot ground the dryer frame to the neutral conductor at the terminal block.
- Remove the terminal block cover plate. Insert the power cord with a UL-listed strain relief through the hole provided in the cabinet near the terminal block.
- A strain relief must be used. Do not loosen the nuts already installed on the terminal block. Be sure they are tight. Use a $\frac{3}{8}$ " (1 cm) deep well socket.
- Since January 1, 1996, the National Electric Code requires that new wiring (not existing) utilize a 4-wire connection to this dryer.

STEP 4 Level the dryer

To ensure optimal performance, the dryer must be level.

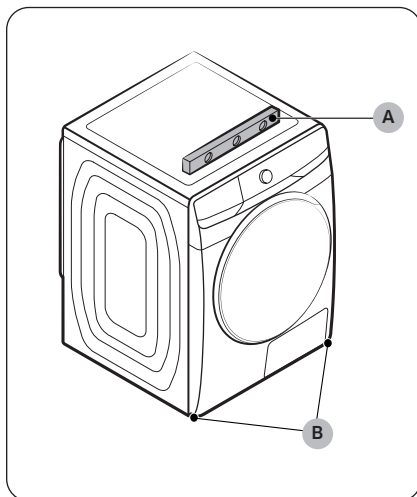

Using a **level (A)**, check if the dryer is level side to side and then front to back. If the dryer is not level, turn the **leveling feet (B)** clockwise to lower the dryer or counterclockwise to raise the dryer.

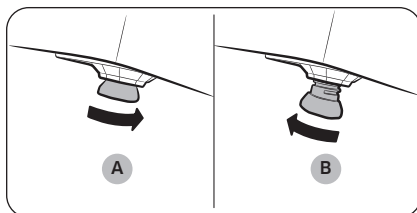

NOTE

- To set the dryer to the same height as your washer, fully **retract (A)** the leveling feet by turning them counterclockwise, then **loosen (B)** the feet by turning them clockwise. Once the dryer is the same height as the washer, follow the directions above to level the dryer.
- Adjust the leveling feet only as much as necessary to level the dryer. Extending the leveling feet more than necessary can cause the dryer to vibrate.

Installation

STEP 5 Power on (for gas models)

Make sure all gas connections, the exhaust line, and all wiring are connected correctly. Then, plug the power cord into a power source and check the dryer's installation and operation using the final checklist in Step 6 below.

STEP 6 Final Check

When the installation is complete, confirm that:

- The dryer is plugged into an electrical outlet and grounded properly.
- The exhaust ductwork is connected, and the joints are taped.
- You have used rigid or stiff-walled flexible metal duct material, not plastic flexible duct.
- The dryer is level and is sitting firmly on the floor.
- The dryer starts, runs, heats, and shuts off properly.
- The gas is supplied properly with no leaks (For gas models only).

CAUTION

The burner may not ignite initially due to air in the gas line. Allowing your dryer to operate on a heat setting will purge the line. If the gas does not ignite within 5 minutes, turn your dryer off and wait 5 minutes. Be sure the gas supply to your dryer has been turned on. To confirm gas ignition, check the exhaust for heat.

Draining directly into a drainage system

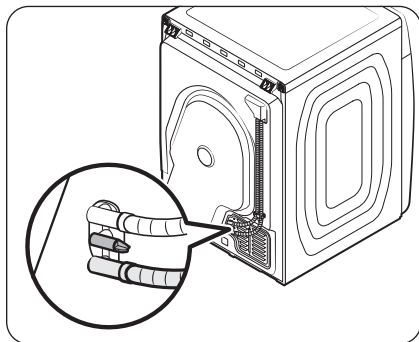

- We strongly recommend draining condensed water directly into your drainage system instead of draining to the built-in water tank.
- Use the provided long drain hose to drain condensed water directly to your drain system instead of draining to the built-in water tank (which is a default method).
- Use the built-in water tank only if you cannot drain the condensed water directly to a drainage system.

NOTE

As a factory default, this dryer is set to use the built-in water tank to drain condensed water.

Using the built-in drain hose for direct draining

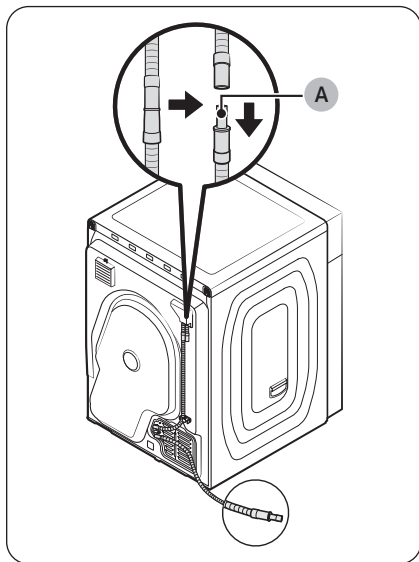

1. Disconnect the built-in drain hose at the **connector (A)** and direct the disconnected end toward the drainage.
 - Do not insert the end of the drain hose directly into the drainage.

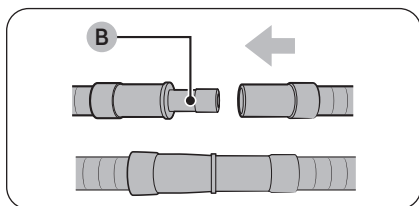

NOTE

- To extend the drain hose further, connect the provided long drain hose to the **connector (B)** at the end of the disconnected built-in drain hose.
- To switch from direct drainage to water tank drainage, follow the instructions in reverse order.

Installation

Using the long drain hose for direct draining

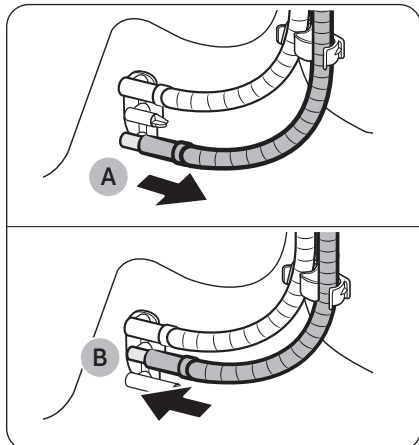

1. Disconnect the built-in drain hose at the **drain water outlet (A)** and then attach it to the **holder (B)**.

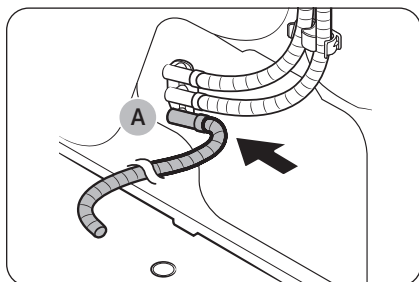

2. Connect one end of the long drain hose to the **drain water outlet (A)**.
3. Place the long drain hose's other end (outlet) toward the drainage.
 - Do not insert the end of the drain hose directly into the drainage.

NOTE

To switch from direct drainage to water tank drainage, follow the instructions in reverse order.

Installation checklist

- The dryer is plugged into a properly grounded outlet.
- All packaging material is completely removed and properly disposed.
- The dryer is level and standing firmly on the floor.
- The long drain hose is installed if you want water captured by the drying process drained automatically.
- Start the dryer to make sure that it runs, heats, and shuts off.
- Run a **TIME DRY** cycle for 20 minutes to see if the **HC** information code is displayed. If this is the case, contact a local service center.
- After installation, we recommend that you wait at least 1 hour before using the dryer.

Before using the dryer

- Make sure no accessory remains inside the drum.
- Plug in the power cord just before operating the dryer.
- Do not block the air inlet hole of the cooling grill at the front of the dryer.
- Do not place flammable objects near the dryer and keep the surrounding area clean.
- Keep the dryer level with the ground.
- Do not remove the adjustable leveling feet of the dryer. They are necessary to keep the dryer level.

Installation

Exhaust ducting guide (Not applicable to ventless (heat pump) models)

Ducting

1. Make sure the dryer is installed properly so the air exhausts freely.
2. Use 4-inch rigid metal ducts. Tape all joints including the dryer connection. Never use lint-trapping screws.
3. To facilitate the exhaust, keep the ducts as straight as possible.

Cleaning

Clean all old ducts before installing the dryer, and make sure the vent flap opens and closes freely. We recommend that you clean the exhaust system annually or on a regular basis.

WARNING

- To prevent fire, do not use plastic, thin-foil, or non-metal flexible ducts of any kind.
- Do not use a poor exhaust system because it slows down the dryer's performance.
- Do not use excessively long ducts that have multiple elbows.
- Do not use crushed or clogged venting or ducts.

Door reversal

CAUTION

- Unplug the power cord before you reverse the door.
- Put a soft rug on the floor to place the door when you remove it. This will prevent the door from being scratched.

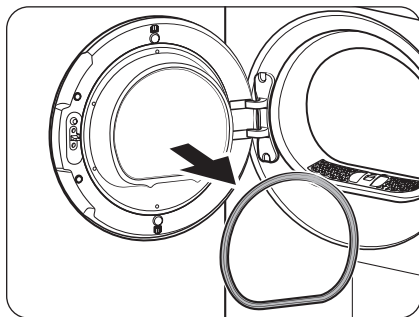

1. Remove the door glass gasket.

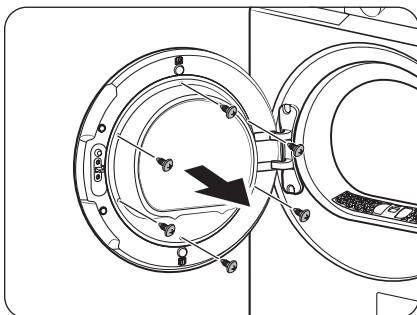

2. Remove the six screws fastening the door glass at the inner side of the door.
 - Remove the bottom three screws first.

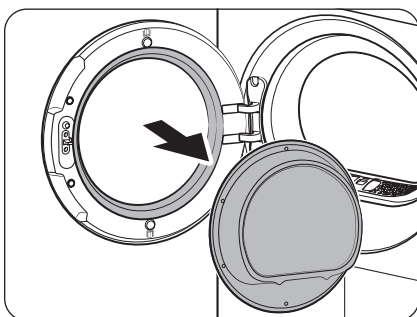

3. Disassemble the door glass.

⚠ CAUTION

Be careful not to drop it during disassembling.

- You may damage the parts, and broken glass parts may lead to injury.

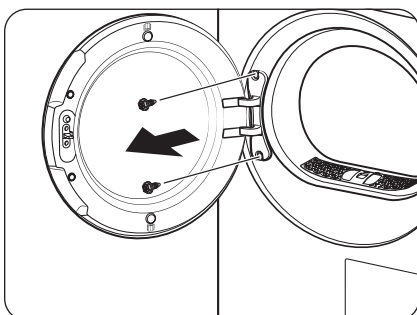

4. Remove the two screws fastening the door to disassemble the door.
 - Use an Allen Wrench to prevent the screws from wearing out.

📖 NOTE

There is a screw on the back side of the hinge that will support the door as you unscrew the hinge screws.

Installation

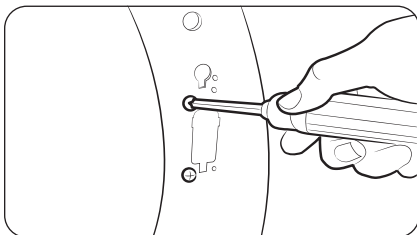

5. Remove the two screws that are above and below the cut-out in the front frame.

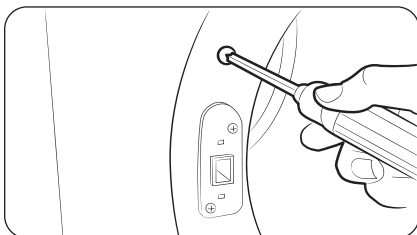

6. Remove the two screws above and below the lever holder on the opposite side of the door opening.

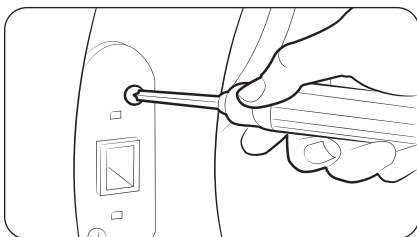

7. Remove the two screws that hold the lever holder in place, and then remove the lever holder.

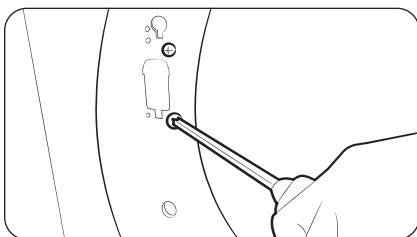

8. Re-insert the two screws that held the lever holder into the same screw holes, and then tighten.

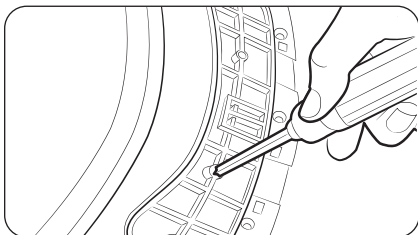

9. Remove the single screw from the back of the door hinge.

NOTE

This is the screw that supports the door against the frame so you can unscrew or screw in the hinge without needing to support the door yourself.

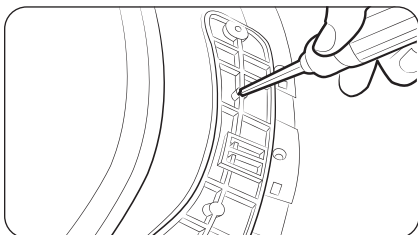

10. Insert the screw you just removed into the other screw hole on the back of the door hinge, and then tighten.

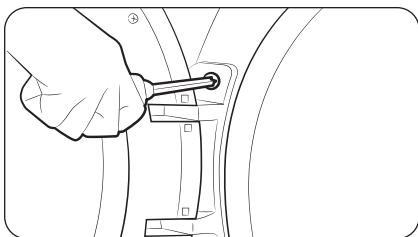

11. Place the door on the other side, and then reattach it to the dryer.

NOTE

Insert the head of the screw on the back of the hinge into the hole above the cut-out in the frame, and then slide the door hinge down until it stops. Make sure the protrusion on the back of the hinge is pressed into the cut-out before you tighten the hinge screws.

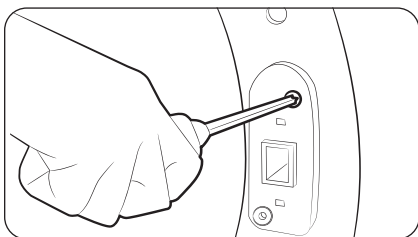

12. Push the lever holder into the cut-out on the other side of the door opening. Insert screws, and then tighten as shown.

Installation

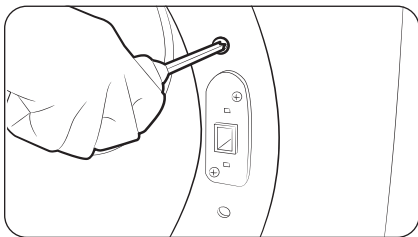

13. Re-attach the remaining screws to the remaining holes above and below the lever holder, and then tighten.

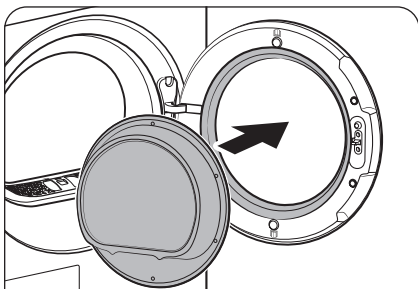

14. Attach the door on the opposite side and put the door glass back in its place.

15. Fasten the door glass with the six screws.

NOTE

Firmly hold the door glass to prevent from dropping it while you fasten it with the screws.

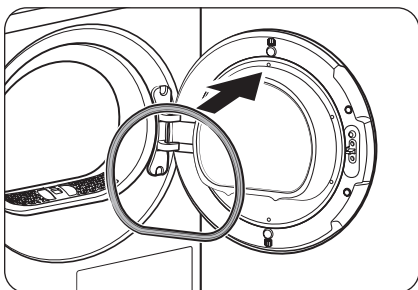
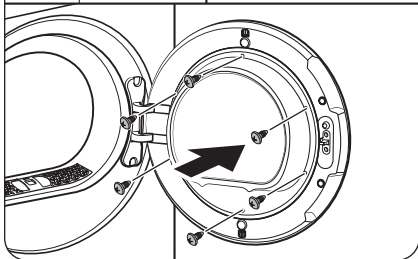

16. Assemble the door glass gasket back onto its place.

Before you start

Here are a few things you should know before starting your dryer.

Sort and load

- Put one wash load in the dryer at a time.
- Do not mix heavy and lightweight items.
- To improve drying efficiency for one or two items, add a dry towel to the load.
- For best results, untangle items before inserting them into the dryer. Tangled items may degrade the drying efficiency or cause the door to open.
- Overloading reduces the tumbling action, resulting in uneven drying and wrinkling.
- Unless recommended on the care label, do not dry woolens or fiberglass items.
- Avoid drying unwashed items.
- Do not dry items soiled with oil, alcohol, gasoline, etc.

Functional prerequisite

Lint filter

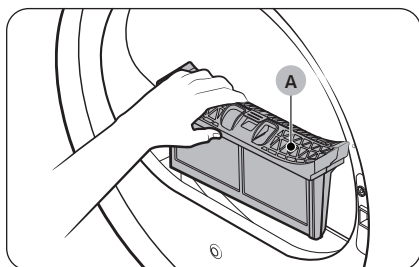

To prevent a risk of fire, make sure to clean the lint filter before or after every load.

1. Turn off the dryer.
2. Open the door and pull out the **lint filter (A)** from inside the drum.
3. Open the lint filter by separating it at the top. Remove the lint, and then clean the lint filter.
4. Close the lint filter, reinsert the lint filter into the dryer, and then close the dryer door.

CAUTION

- Do not operate the dryer without the lint filter in place.
- Do not use a damaged or broken lint filter. This may reduce performance and/or cause a fire.

Operations

⚠ WARNING

To reduce the risk of fire, electric shock, or injury, read the "Safety information" section before operating this appliance.

Control panel

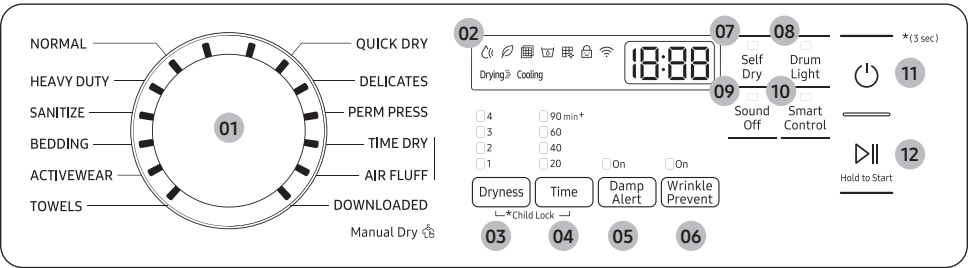

01 Cycle Selector	Turn the Cycle Selector to select a desired cycle. When a cycle is selected, the cycle indicator lights up.
02 Display	Displays all cycle information, including the cycle time, information code, and operating status.
03 Dryness	<p>Press to select a dry level. You can select from 4 different options (1 to 4). Please refer to the following recommendations to select the appropriate dryness.</p> <ul style="list-style-type: none">For larger or bulkier loads, select 4 for complete dryness.For items that need to lay flat or hang to dry, use 1 to partially dry items. <p>NOTE This option is unavailable with ACTIVEWEAR, SANITIZE, TIME DRY, and AIR FLUFF.</p>
04 Time	Press to adjust the drying time for the Manual Dry cycles. This option is unavailable with the Standard cycles because the dryer determines the drying time by sensing the current moisture level of the load.
05 Damp Alert	<p>Press to turn the Damp Alert option on or off.</p> <p>This option alerts you when items that require ironing (such as shirts) are suitably dried for ironing.</p> <p>NOTE This option is available with NORMAL, DELICATES, and PERM PRESS.</p>

06 Wrinkle Prevent	<p>Press to turn the Wrinkle Prevent option on or off.</p> <p>This option provides approximately 180 minutes of intermittent tumbling in unheated air at the end of the cycle to prevent items from wrinkling.</p> <p>You may remove items at any time during the Wrinkle Prevent process since this process, as this process begins after the items have been dried.</p>
07 Self Dry	<p>Press to select the Self Dry cycle.</p> <p>This cycle effectively dries every corner of the dryer, even those that cannot be seen.</p> <ul style="list-style-type: none"> • After selecting the Self Dry cycle, press and hold Start/Pause to start the cycle. • Remove all laundry first, and then run the Self Dry cycle. • The lamp on the Self Dry button blinks to remind you to run the Self Dry cycle. It will flash every 10 times up to the initial 30 times, and then every 25 times afterwards. <p>⚠ CAUTION</p> <p>The drum must be empty when you run the Self Dry cycle.</p>
08 Drum Light	<p>Press to turn the interior lamp on or off. The lamp stays lit for 2 minutes after it has turned on, regardless of whether the power is on or off or the door is open or closed, and then turns off automatically.</p>
09 Sound Off	<p>You can turn the sound from the dryer on or off.</p>
10 Smart Control	<p>After connecting the Tumble Dryer to your home network using the Samsung Smart Washer/Dryer app, you can control the dryer remotely. When started, the Smart Control indicator blinks. The dryer enters waiting mode and waits for remote commands.</p>
11 Power	<p>Press to turn the dryer on or off.</p>
12 Start/Pause	<p>Press and hold to start the operation or press to stop the operation temporarily.</p>

NOTE









Extremely tangled items may degrade the drying efficiency or cause the door to open. Untangle the items before putting them into the dryer. Also, do not put objects on the dryer.

⚠ CAUTION

Do not spray water directly onto the control panel. This may cause a system failure.

Operations

Icon description

	Sensor Dry	This icon appears when the dryer operates the cycle which senses the internal humidity to determine the drying time.
	AI Energy Mode	<p>You can save energy for your dryer through the AI Energy Mode provided by SmartThings Energy Service. When AI Energy Mode is applied, this icon is displayed and shows the saved energy compared to when AI Energy Mode was not used after the drying is completed.</p> <ul style="list-style-type: none">The predicted amount of energy saved may differ from the actual usage depending on the usage environment.
	Check Filter	<p>This icon appears after every load as a reminder to clean the lint filter. Clean the lint filter before every cycle and make sure the filter is properly inserted before starting a cycle.</p> <p>If this icon remains on the control panel display during the cycle and does not turn off, clean the Micro soft filter (Optional Filter) according to the "Micro soft filter (Optional Filter)" section on page 56.)</p>
	Check Water Tank	<p>This icon indicates that the water tank is full and needs to be emptied.</p> <ul style="list-style-type: none">Empty the water tank according to the "Emptying the water tank" section on page 49.
	Clean Heat Exchanger	<p>This icon indicates that the heat exchanger needs to be cleaned.</p> <ul style="list-style-type: none">Clean the dust on the heater exchanger according to the "Heat exchanger" section on page 54.
	Child Lock	<p>This icon indicates that Child Lock is on.</p> <ul style="list-style-type: none">For more information on Child Lock, refer to the "Child Lock 
	Wi-Fi	This icon indicates that the dryer is connected to Wi-Fi.

Simple steps to start

1. Press **Power** to turn the dryer on.
2. Turn the **Cycle Selector** to select a cycle.
3. Change the cycle settings (**Dryness**, and **Time**) as necessary.
4. Select desired options as necessary.
5. Press and hold **Start/Pause**.

NOTE

To change the cycle during the operation, press **Start/Pause** to stop the operation, and repeat steps 2 to 5.

Cycle overview

Standard cycles

The Standard cycles automatically adjust the drying time based on the moisture levels in the laundry.

Cycle	Description
NORMAL	For most fabrics including cottons and linens.
HEAVY DUTY	For drying items made of heavy fabrics, such as jeans, corduroys, or work clothes, with high-temperature heat.
SANITIZE	Use to sanitize items by applying high-temperature heat deeply to the fabric. Recommended Maximum Capacity <ul style="list-style-type: none">• Dry item: 4 kg / 8.8 lb• Wet item: 6 kg / 13.2 lb
BEDDING	For bulky items such as blankets, sheets, and comforters.
PERM PRESS	For drying wrinkle-free cottons, synthetic fabrics, and permanent press fabrics automatically.
DELICATES	For drying heat-sensitive items at a low temperature.
DOWNLOADED	<ul style="list-style-type: none">• You can select a desired cycle from the SmartThings app on your smartphone and download it to the dryer.• Available cycles: ECO NORMAL, SHIRTS, DENIM, WOOL, AIR BEDDING CARE, DOWN JACKET CARE, OUTDOOR CARE• Factory setting: ECO NORMAL
TOWELS	Use to dry loads such as bath towels.
ACTIVEWEAR	For exercise wear and outdoor wear such as sports jerseys, training pants, and other performance clothing.
QUICK DRY	For mixed loads consisting of cotton and synthetic fabrics that need quick drying.

Operations

Manual Dry cycles

The manual dry cycles allow you to manually change the drying settings to your preference.

Cycle	Description
TIME DRY	<p>You can dry items by setting the desired time rather than based on the dryness level.</p> <p>Turn the Cycle Selector to select TIME DRY. Then, press Time repeatedly until you have selected the desired drying time.</p> <ul style="list-style-type: none">You can set the desired time between 20 and 240 minutes. (20 / 40 / 60 / 90 / 120 / 150 / 180 / 240) <p> NOTE</p> <p>If you need additional drying after using one of the Standard cycles, set the drying time to the minimum (20 minutes). Excessive drying may cause damage or deformation to your items.</p>
AIR FLUFF	<p>Tumbles the load in room temperature air.</p> <p>Turn the Cycle Selector to select AIR FLUFF. Then, press Time repeatedly until you have selected the desired drying time.</p> <ul style="list-style-type: none">You can set the desired time between 20 and 240 minutes. (20 / 40 / 60 / 90 / 120 / 150 / 180 / 240)

Cycle chart

 NOTE

For best drying results, avoid overloading or underloading the dryer.

Cycle		Recommended items	Dry level
Standard	NORMAL	Cottons, work clothes, linens, mixed loads	3 (Adjustable)
	HEAVY DUTY	Heavy fabrics such as jeans, corduroys, heavy work clothes	3 (Adjustable)
	SANITIZE	Bedding, curtains, children's clothing	4 (Not adjustable)
	BEDDING	Bulky items such as blankets, sheets, comforters, pillows	3 (Adjustable)
	PERM PRESS	Shirts, synthetic fabrics, knits, wrinkle-free cottons, permanent press	2 (Adjustable)
	DELICATES	Underwear, blouses, lingerie	2 (Adjustable)
	TOWELS	Bath towels and similar items	3 (Adjustable)
	ACTIVEWEAR	Exercise wear, sports jerseys	2 (Not adjustable)
Manual Dry	QUICK DRY	Cotton, mixed loads of cotton and synthetic fabrics.	3 (Adjustable)
	TIME DRY	Any load	-
	AIR FLUFF	Foam, rubber, plastic	-

 NOTE

● : factory setting, ○ : can be selected

Cycle		Options		
		Time setting	Wrinkle Prevent	Damp Alert
Standard	NORMAL		○	○
	HEAVY DUTY		○	
	SANITIZE		○	
	BEDDING		○	
	PERM PRESS		○	○
	DELICATES		○	○
	TOWELS		○	
	ACTIVEWEAR		○	
Manual Dry	QUICK DRY		○	
	TIME DRY	●	○	
	AIR FLUFF	●	○	

Operations

Cycle guide

The best way to dry items is to follow the instructions on the care label. If no drying instructions are provided, see the following table for reference.

Cycle	Description
Bedspreads & Comforters	Follow the care label instructions or dry using the BEDDING cycle. <ul style="list-style-type: none">Make sure the item is thoroughly dry before using or storing it.May require repositioning in the drum to ensure even drying.
Blankets	Use the BEDDING cycle and dry only one blanket at a time for the best tumbling action. <ul style="list-style-type: none">Make sure blankets are thoroughly dry before using or storing.
Curtains & Draperies	Only use the AIR FLUFF cycle. Using cycles that use heat may cause a fire hazard. <ul style="list-style-type: none">Dry curtains and draperies in small loads for best results and remove as soon as possible.
Cloth Diapers	Use the NORMAL cycle for soft and fluffy diapers.
Down-filled Items (jackets, sleeping bags, comforters, etc.)	Only use the AIR FLUFF cycle. Using cycles that use heat may cause a fire hazard.
Foam Rubber (rug backs, stuffed toys, shoulder pads, etc.)	Only use the AIR FLUFF cycle. Using cycles that use heat may cause a fire hazard. ⚠ WARNING Drying a rubber item with heat may damage it or cause a fire.
Pillows	Use the NORMAL cycle. <ul style="list-style-type: none">Add a couple of dry towels and a pair of clean sneakers to help the tumbling action and to fluff the items.Use the AIR FLUFF cycles for the kapok or foam pillows.
Plastics (shower curtains, outdoor furniture covers, etc.)	Only use the AIR FLUFF cycle.

⚠ WARNING

Do not dry:

- Fiberglass items (curtains, draperies, etc.)
- Woolens, unless recommended on the label
- Items spotted or soaked with vegetable or cooking oils

Special features

Child Lock

The Child Lock feature disables all the buttons except the **Power** button to prevent children from unintentionally changing cycle settings.

To turn the Child Lock feature on or off, simultaneously press and hold **Dryness** and **Time** for 3 seconds.

NOTE

Once you turn on the Child Lock feature, it will remain on until you turn it off.

If the buttons other than the **Power** button do not respond, check if the Child Lock icon () is on. The, turn off the feature if it is on.

Sound Off

You can turn the sound from the dryer on or off. Please note that this setting does not affect the notification sounds for information codes and Damp Alert.

- To turn on or off the sound, press **Sound Off**.

Smart Control

To use this feature, you must first download the SmartThings app at the Play Store or the App Store and install it on a mobile device with a camera. The Smart Control feature is optimized for Galaxy & iPhone series (applicable models only).

If an information appears on the display, follow these steps:

1. Press Smart Control to enter the Smart Control mode.
2. Run the SmartThings app on your mobile device, and then tap Smart Control.
3. Put the mobile device's camera close to the dryer's display. The app automatically recognizes the information code.
4. When the information code is recognized correctly, the app provides detailed information about the problem with applicable solutions.

NOTE

- The function name, Smart Control, may differ depending on the language.
- If the light is reflected off the dryer's display, the app may fail to recognize the information code.
- If the app fails to recognize the information code, you can enter the code manually in the app.

DOWNLOADED cycle

You can choose from more cycles available on the SmartThings app on your smartphone.

1. On your smartphone, select the **DOWNLOADED** cycle.
You can choose from ECO NORMAL, SHIRTS, WOOL, DENIM, AIR BEDDING CARE, DOWN JACKET CARE, and OUTDOOR CARE.
2. Press **Power** on your dryer.
3. Turn the **Cycle Selector** to **DOWNLOADED**.
4. Press and hold **Start/Pause**.

Operations

SmartThings

Wi-Fi connection

On your smartphone or tablet, go to **Settings**, turn on the wireless connection, and then select your AP (Access Point).

- This appliance supports the Wi-Fi 2.4 GHz protocols.

Download

On an app market (Google Play Store, Apple App Store, Samsung Galaxy Apps), find the SmartThings app by searching for "SmartThings". Download and install the app on your device.

NOTE

The app is subject to change without notice for improved performance.

Log in

You must first log into SmartThings with your Samsung account. To create a new Samsung account, follow the instructions on the app. You don't need a separate app to create your account.

NOTE

If you have a Samsung account, use the account to log in. A registered Samsung smartphone or tablet user automatically logs in.

To register your appliance to SmartThings

1. Make sure your smartphone or tablet is connected to a wireless network. If not, go to **Settings** and turn on the wireless connection, and then select your AP (Access Point).
2. Open **SmartThings** on your smartphone or tablet.
3. If the "A new device is found." message appears, select **Add**.
4. If no message appears, select **+** and select your appliance from the list of devices available. If your appliance is not listed, select **Device Type** > **Specific Device Model**, and then add your appliance manually.
5. Register your appliance to the SmartThings app as follows.
 - a. Add your appliance to the SmartThings app. Make sure your appliance is connected to the app.
 - b. When the registration is complete, your appliance appears on your smartphone or tablet.

Maintenance

Emptying the water tank

Empty the water tank after each use to prevent leaks.

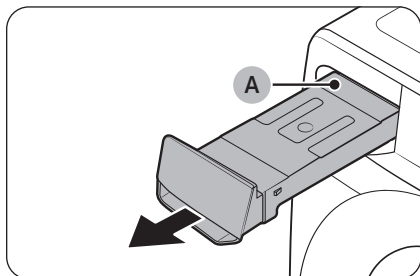

1. Remove the **water tank (A)** from the dryer.
 - Pull the water tank handle with one hand until the tank is halfway out.
 - Once the water tank is halfway out, support its bottom with the other hand and pull it slowly with both hands.

⚠ CAUTION

- The water tank is heavy. Slowly remove the water tank using both hands while keeping the tank at a level.
- Be careful when removing the full water tank. It is very heavy and can cause injury if you drop it.

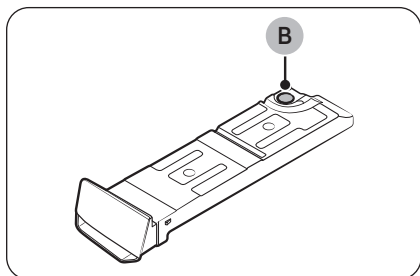

2. Empty the water through the **drain hole (B)**, and then clean inside the water tank.
 - Mix some neutral detergent in lukewarm water. Fill the water tank with the mixture through the **drain hole (B)** and leave it for 30 minutes. Then, rinse the tank with clean water and completely dry it.
3. Place the water tank back into place.

📖 NOTE

If the dryer stops during the drying process with the Check Water Tank icon (🚰) on the display, empty the water tank. Then, press and hold **Start/Pause** to resume drying.

Maintenance

Installing the Micro soft filter (Optional Filter)

You can install the provided Micro soft filter (Optional Filter) to prevent dust accumulation on the heat exchanger.

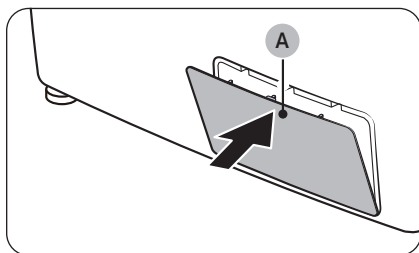

1. Gently press the top part of the **heat exchanger cover (A)** to open it.

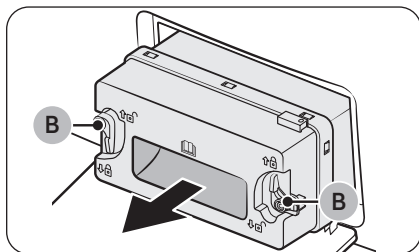

2. Unlock the **fixers (B)** on the heat exchanger's protection cover, and then pull the protection cover to remove it.

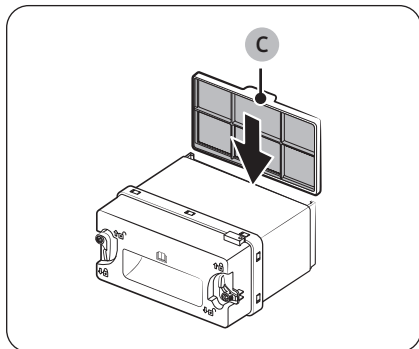

3. Insert the provided **Micro soft filter (Optional Filter) (C)** into the slot at the back of the protection cover as shown in the figure.
 - Make sure to install the filter in the correct position. (The tab on the top of the filter should face outward.)

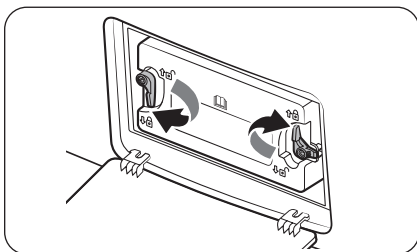

4. Reinsert the protection cover to its original position, and then lock the fixers.
5. Close the heat exchanger cover.

Cleaning

WARNING

- Do not clean the dryer by directly spraying water onto it.
- Do not clean the dryer with benzene, thinner, alcohol, or acetone, as these products may cause discoloration, deformation, damage, electric shock, or fire.
- Unplug the power cord before cleaning.

Exterior

Clean with a soft, damp cloth. Do not use abrasive cleaners. Avoid using or placing sharp or heavy objects near/on the dryer. Keep detergent and laundry supplies on the pedestal (sold separately) or in a separate storage container.

Control panel

Clean with a soft, damp cloth. Do not use abrasive cleaners. Do not spray cleaners directly on the panel. Immediately wipe up any spills or liquids from the control panel.

Drum

Clean with a damp cloth with a mild, non-abrasive cleaner suitable for stainless steel. Wipe the remaining residue with a clean, dry cloth.

Door

Foreign substances can contaminate or build up on the inside of the door. Clean the inside of the door using a soft piece of cloth or brush.

CAUTION

Do not detach the door's rubber sealing.

Maintenance

Lint filter

Clean the lint filter after each use.

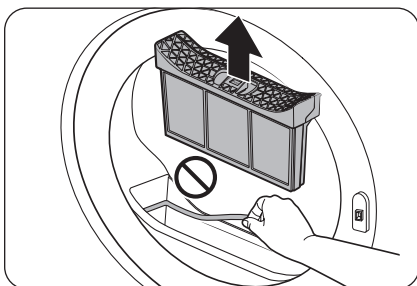

1. Open the dryer door.
2. Pull the top of the lint filter to remove it from the slot.
 - Do not detach the rubber sealing in the filter slot after removing the filter.

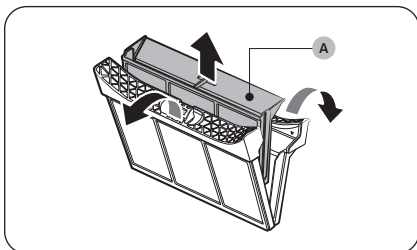

3. Open the outer filter and remove the **inner filter (A)**.

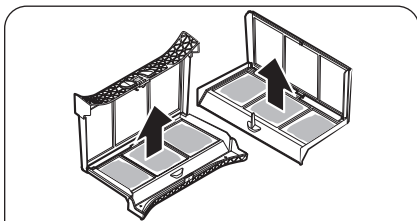

4. Spread open the outer filter and the inner filter.
5. Remove the lint from both filters, and then clean the filters with the cleaning brush.

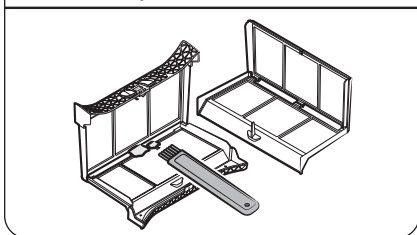

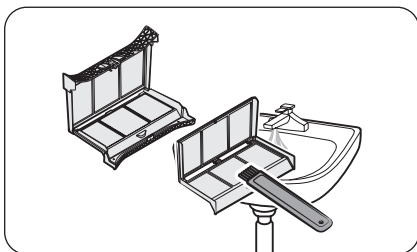

NOTE

To clean the filters thoroughly, clean them in running water, and then dry them completely.

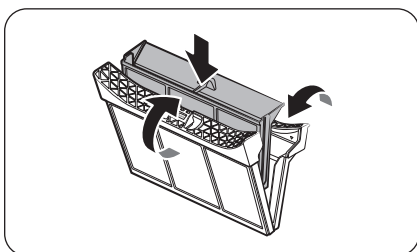

6. Put the inner filter into the outer filter, and then reinsert the lint filter into the original position.

CAUTION

- The dryer does not operate without the lint filter.
- Clean the lint filter after each load. Otherwise, the drying performance may decrease.
- If the filter surface is wet, allow it to dry completely before use.
 - Inserting the wet filter can cause mold, odor or poor drying result.
- Do not shake or tap the filter to clean lint or remove moisture. Doing so can damage the filter.
- Opening the outer and inner filters carelessly and with excessive force can damage the filters.

Maintenance

Heat exchanger

When it is time to clean the heat exchanger, the Clean Heat Exchanger icon (🧹) appears on the display. A dirty heat exchanger will hinder the product's performance and should be cleaned regularly.

NOTE

- Water droplets can form around the heat exchanger because of condensation from temperature differences. This is normal and does not indicate a leak.
- If you do not plan to use the dryer for an extended period, open the heat exchanger cover and ventilate.

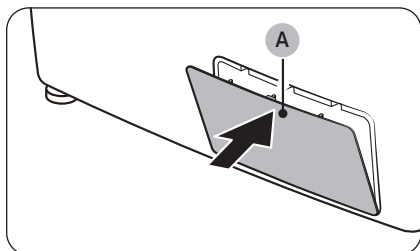

1. Gently press the top part of the **heat exchanger cover (A)** to open it.

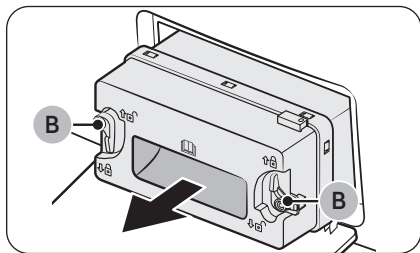

2. Unlock the **fixers (B)** on the heat exchanger's protection cover, and then pull the protection cover to remove it.

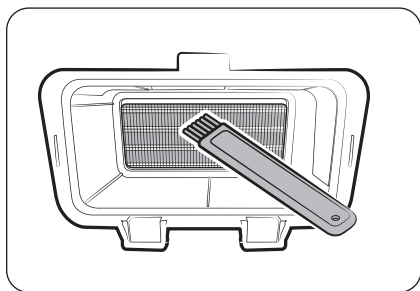

3. Clean the dust on the heat exchanger using the provided brush.
 - After cleaning with the brush, wipe off the remaining dust with a smooth, damp cloth.

CAUTION

- To avoid physical injury and burns, do not touch or clean the heat exchanger with bare hands.
- When cleaning the heat exchanger, be careful not to damage the fins.

NOTE

If the heat exchanger is hard to clean because it is completely dry, spray some water on it and use a brush to clean it.

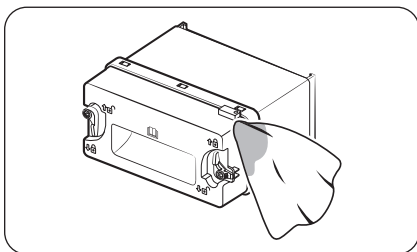

4. Clean the protection cover with a smooth, damp cloth.
 - There may be moisture or foreign substances around the protection cover.

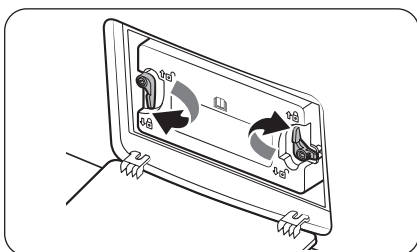

5. Reinsert the protection cover to its original position, and then lock the fixers.
6. Close the heat exchanger cover.

Maintenance

Micro soft filter (Optional Filter)

When it is time to clean the Micro soft filter (Optional Filter), the Check Filter icon (🧺) remains on the control panel display and does not turn off. A dirty Micro soft filter (Optional Filter) will hinder the product's performance and should be cleaned regularly.

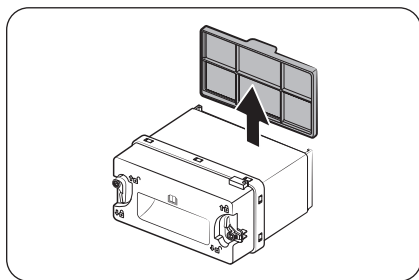

1. Open the heat exchanger cover, and then remove the protection cover. (Refer to the "Heat exchanger" section on page 54.)
2. Remove the Micro soft filter (Optional Filter) from the protection cover.

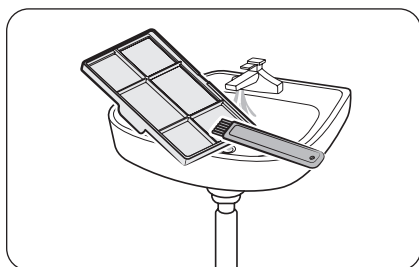

3. Clean the dust on the Micro soft filter (Optional Filter) with the provided brush, and then wash it in running water.
 - Completely dry the filter after a wash.

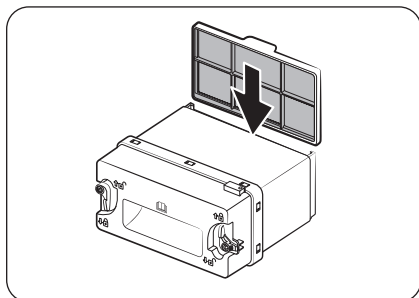

4. Insert the Micro soft filter (Optional Filter) into the slot at the back of the protection cover, and then insert the protection cover back into its place.
 - Make sure to install the filter in the correct position. (The tab on the top of the filter should face outward.)

NOTE

- Clean the Micro soft filter (Optional Filter) every 25 uses of the dryer.
 - Heavily soiled Micro soft filter (Optional Filter) may degrade the drying performance.
- When cleaning the Micro soft filter (Optional Filter), check the heat exchanger and clean it if it is dusted.

Troubleshooting

Checkpoints

If you encounter a problem with the dryer, first check the table below and try the suggestions.

Problem	Action
The dryer does not start.	<ul style="list-style-type: none">• Make sure the dryer is plugged in.• Make sure the door is properly closed.• Check the fuse or reset the circuit breaker.• If you opened the door during a cycle, press and hold Start/Pause again.• Clean the Micro soft filter.• Check if you have inserted the lint filter. The dryer does not operate without the lint filter.• Turn off the Child Lock feature if it is on.
The dryer does not warm up.	<ul style="list-style-type: none">• Check the fuse or reset the circuit breaker.• Check the lint filter and the heat exchanger. Clean them if necessary.• The dryer may be in the cooling down process of the cycle.
Items are not dried.	<p>Check all of the above. Additionally:</p> <ul style="list-style-type: none">• Do not overload the dryer. If the dryer is overloaded, it could take longer for items to dry.• Dry heavy fabrics separately from light fabrics.• The item(s) are too small and may not get enough spinning inside the drum.• Clean the lint filter.• Clean the heat exchanger.• If the Clean Heat Exchanger icon (🧺) appears on the display, clean the heat exchanger. (Refer to the "Heat exchanger" section on page 54.)• If the Check Filter icon (🧺) appears on the display and does not turn off, clean the Micro soft filter (Optional Filter). (Refer to the "Micro soft filter (Optional Filter)" section on page 56.)• If a drain hose is connected, make sure water is draining properly.
The dryer is too loud.	<ul style="list-style-type: none">• Look for coins, loose buttons, nails, and other objects, and remove them immediately.• Check the lint filter. Remove any items stuck inside the lint filter.• Make sure the dryer is level and standing firmly on the floor.• The dryer may hum because air moves through the drum and fan. This is normal.
Items are not dried evenly.	<ul style="list-style-type: none">• Seams, pockets, and other parts of clothing are harder to dry than others. This is normal.• Sort heavy and light items separately.

Troubleshooting

Problem	Action
There is a smell coming from the dryer.	<ul style="list-style-type: none">• The smell of paint, varnish, cleaning agents, and other household items could have circulated in the air and entered the dryer. If you notice such a smell, ventilate completely before using the dryer.• If drying in an enclosed area, the dryer could cause the ambient temperature to rise. Accordingly, make sure to open a window and ventilate the area.• Do not attempt to dry wet items after leaving them in the washing machine or dryer for a long time.
The dryer turns off before the items are dry.	<ul style="list-style-type: none">• The load is too small. Throw in a few additional items like towels and try drying again.
The clothes have lint on them.	<ul style="list-style-type: none">• Always make sure the lint filter is clean before putting items into the dryer. When drying items that generate a large amount of lint, you may need to clean the lint filter in the middle of a cycle.• Some fabrics (such as white towels) cause more lint and should be dried separately from fabrics that lint attaches easily (such as black linen pants).• Check the inside of the pockets to make sure they are empty before drying.
Items still wrinkled after Wrinkle Prevent (Wrinkle Away, Wrinkle Release).	<ul style="list-style-type: none">• Small loads of 1 to 4 items work best.• Load fewer items. Load similar-type items.• Take out the items immediately after drying is complete.
Extended time.	<ul style="list-style-type: none">• Standard cycles automatically senses the moisture in the load and shuts the dryer off when the selected dryness level is reached. The drying time can change according to the type and amount of laundry. See the cycle chart for reference.
The ambient temperature around the dryer rises or there is a damp, soggy smell.	<ul style="list-style-type: none">• Heat pump dryers circulate ambient air inside and outside the dryer during the drying process to cool the system. Using the dryer in a poorly ventilated area may, depending on the operating environment, raise the ambient humidity level and/or cause a damp, soggy smell to develop. Ensure proper ventilation when using the dryer.
Water is not draining.	<ul style="list-style-type: none">• Check the draining hose for twists and kinks. Straighten out the hose if it is twisted or kinked and securely connect it to the drain on the floor.• Check to see if the draining hose is frozen. If the hose is frozen, submerge it in warm water to allow the water inside the hose to melt and drain out. Reconnect the hose and check for proper draining.

If a problem persists, contact a local Samsung service center.

Information codes

If the dryer fails to operate, you may see an information code on the display panel. To determine what you should do, check the list of codes in the table below, and then try the suggested actions.

Code	Meaning/Action
dC	The dryer door is not properly closed. <ul style="list-style-type: none">Make sure the door is properly closed.Make sure laundry is not caught in the door.
AC	Electronic control problem (Invalid Communication). <ul style="list-style-type: none">Contact a Samsung service center.
HC	High-temperature heating check. <ul style="list-style-type: none">Clean the lint filter.If this information code remains, contact a Samsung service center.
9C1	The electronic control needs to be checked. <ul style="list-style-type: none">Check if power is supplied properly.If the information code remains, contact a Samsung service center.
9C9	Check for overheating around the power module (IPM). <ul style="list-style-type: none">Turn off the dryer and operate the dryer again.If the information code remains, contact a Samsung service center.
TC	The Thermistor1 resistance is either too low or too high. <ul style="list-style-type: none">Resistance of thermistors sensor is over limit.Turn off the dryer and contact a Samsung service center.
3C	The PBA needs to be checked. <ul style="list-style-type: none">Unplug the power plug and contact a Samsung service center.
5C	The water tank is full, or the drain pump is not working. <ul style="list-style-type: none">Check whether the water tank is full or not. Empty it if it is full.Check the drain pump.
NC	The lint filter or heat exchanger's protection cover is not inserted. <ul style="list-style-type: none">Check whether the lint filter or the heat exchanger's protection cover is inserted or not.
NC2	The heat exchanger's protection cover is not inserted. <ul style="list-style-type: none">Check whether the heat exchanger's protection cover is inserted or not.
BC2/BC4	Continuous pressing of a button is detected. <ul style="list-style-type: none">Check if a button is stuck.If the information code remains, contact a Samsung service center.



Contact a Samsung service centre if any information code keeps appearing on the control panel display.

Specifications





Fabric care chart

The following symbols provide garment care direction. The clothing care labels include symbols for drying. The use of symbols ensures consistency among garment manufacturers of domestic and imported items. Follow care label directions to optimize garment life and reduce laundering problems.

Tumble Dry Cycles

	Dry
	Normal
	Permanent Press
	Delicate/Gentle
	Do Not Dry (Used with Do Not Wash)
	Do Not Tumble Dry
	In the Shade (Added to Line Dry, Drip Dry or Dry Flat)
	Line Dry/ Hang to Dry
	Drip Dry
	Dry Flat

Tumble Dry Heat Setting

	Any Heat
	High
	Medium
	Low
	No Heat/ Air

Protecting the environment

This appliance is manufactured from recyclable materials. If you decide to dispose of this appliance, please observe local waste disposal regulations. Cut off the power cord so that the appliance cannot be connected to a power source. Remove the door so that animals and small children cannot get trapped inside the appliance.

Specification sheet

Type	Front loading dryer
Capacity (Cu.ft)	7.5
Water pressure (psi (kPa))	20-116 (137-800)
Weight (lb (kg))	154 (70)
Power consumption (W)	2750
Allowable temperature	5-35 °C

LIMITED WARRANTY (U.S.A.)

SAMSUNG DRYER

LIMITED WARRANTY TO ORIGINAL CONSUMER PURCHASER WITH PROOF OF PURCHASE AND/OR PROOF OF DELIVERY

This SAMSUNG brand product, as supplied and distributed by SAMSUNG ELECTRONICS AMERICA, INC. (SAMSUNG) and delivered new, in the original carton to the original consumer purchaser, is warranted by SAMSUNG against manufacturing defects in materials or workmanship for the following limited warranty periods, starting on the date of delivery to the original consumer purchaser:

One (1) Year All Parts and Labor

This limited warranty is valid only on products purchased and used in the United States that have been installed, operated, and maintained according to the instructions attached to or furnished with the product. To receive warranty service, the purchaser must contact SAMSUNG at the address or phone number provided below for problem determination and service procedures. Warranty service can only be performed by a SAMSUNG authorized service center. The original dated bill of sale and/or proof of delivery must be presented upon request to SAMSUNG or SAMSUNG's authorized service center to receive warranty service.

SAMSUNG will provide in-home service within the contiguous United States during the warranty period at no charge, subject to availability of SAMSUNG authorized servicers within the customer's geographic area. If in-home service is not available, SAMSUNG may elect, at its option, to provide transportation of the product to and from an authorized service center. If the product is located in an area where service by a SAMSUNG authorized servicer is not available, you may be responsible for a trip charge or required to bring the product to a SAMSUNG authorized service center for service.

To receive in-home service, product must be unobstructed and accessible to the service agent.

During the applicable warranty period, a product will be repaired, replaced, or the purchase price refunded, at the sole option of SAMSUNG. SAMSUNG may use new or reconditioned parts in repairing a product, or replace the product with a new or reconditioned product. Replacement parts and products are warranted for the remaining portion of the original product's warranty or ninety (90) days, whichever is longer. All replaced parts and products are the property of SAMSUNG and you must return them to SAMSUNG.

This limited warranty covers manufacturing defects in materials or workmanship encountered in normal household, noncommercial use of this product and shall not cover the following: damage that occurs in shipment, delivery, installation, and uses for which this product was not intended; damage caused by unauthorized modification or alteration of the product; product where the original factory serial numbers have been removed, defaced, changed in any way, or cannot be readily determined; cosmetic damage including scratches, dents, chips, and other damage to the product's finishes; damage caused by abuse, misuse, pest infestations, accident, fire, floods, or other acts of nature or God; damage caused by use of equipment, utilities, services, parts, supplies, accessories, applications, installations, repairs, external wiring or connectors not supplied or authorized by SAMSUNG; damage caused by incorrect electrical line current, voltage, fluctuations and surges; damage caused by failure to operate and maintain the product according to instructions; in-home instruction on how to use your product; and service to correct installation not in accordance with electrical or plumbing codes or correction of household electrical or plumbing (i.e., house wiring, fuses, or water inlet hoses). The cost of repair or replacement under these excluded circumstances shall be the customer's responsibility.

Visits by an authorized servicer to explain product functions, maintenance or installation are not covered by this limited warranty. Please contact SAMSUNG at the number below for assistance with any of these issues.

EXCLUSION OF IMPLIED WARRANTIES

IMPLIED WARRANTIES, INCLUDING THE IMPLIED WARRANTIES OF MERCHANTABILITY OR FITNESS FOR A PARTICULAR PURPOSE, ARE LIMITED TO ONE YEAR OR THE SHORTEST PERIOD ALLOWED BY LAW. Some states do not allow limitations on how long an implied warranty lasts, so the above limitations or exclusions may not apply to you. This warranty gives you specific rights, and you may also have other rights, which vary from state to state.

LIMITED WARRANTY (U.S.A.)

LIMITATION OF REMEDIES

YOUR SOLE AND EXCLUSIVE REMEDY IS PRODUCT REPAIR, PRODUCT REPLACEMENT, OR REFUND OF THE PURCHASE PRICE AT SAMSUNG'S OPTION, AS PROVIDED IN THIS LIMITED WARRANTY. SAMSUNG SHALL NOT BE LIABLE FOR SPECIAL, INCIDENTAL OR CONSEQUENTIAL DAMAGES, INCLUDING BUT NOT LIMITED TO TIME AWAY FROM WORK, HOTELS AND/OR RESTAURANT MEALS, REMODELING EXPENSES, LOSS OF REVENUE OR PROFITS, FAILURE TO REALIZE SAVINGS OR OTHER BENEFITS REGARDLESS OF THE LEGAL THEORY ON WHICH THE CLAIM IS BASED, AND EVEN IF SAMSUNG HAS BEEN ADVISED OF THE POSSIBILITY OF SUCH DAMAGES. Some states do not allow exclusion or limitation of incidental or consequential damages, so the above limitations or exclusions may not apply to you. This warranty gives you specific rights, and you may also have other rights, which vary from state to state.

SAMSUNG does not warrant uninterrupted or error-free operation of the product. No warranty or guarantee given by any other person, firm, or corporation with respect to this product shall be binding on SAMSUNG.

To obtain warranty service, please contact SAMSUNG at:

Samsung Electronics America, Inc.

85 Challenger Road

Ridgefield Park, NJ 07660

1-800-SAMSUNG (726-7864)

www.samsung.com/us/support

Warranty (CANADA)

SAMSUNG DRYER

LIMITED WARRANTY TO ORIGINAL PURCHASER

This SAMSUNG brand product, as supplied and distributed by SAMSUNG ELECTRONICS CANADA, INC. (SAMSUNG) and delivered new, in the original carton to the original consumer purchaser, is warranted by SAMSUNG against manufacturing defects in materials and workmanship for a limited warranty period of:

- One (1) year part and labor

This limited warranty begins on the original date of purchase, and is valid only on products purchased and used in the Canada.

To receive warranty service, the purchaser must contact SAMSUNG for problem determination and service procedures.

Warranty service can only be performed by a SAMSUNG authorized service center.

The original dated bill of sale must be presented upon request as proof of purchase to SAMSUNG or SAMSUNG's authorized service center.

SAMSUNG will provide in-home service during the warranty period at no charge, subject to availability within the Canada.

In-home service is not available in all areas.

To receive in-home service, product must be unobstructed and accessible to the service agent.

If service is not available, SAMSUNG may elect to provide transportation of the product to and from an authorized service center.

SAMSUNG will repair, replace, or refund this product at our option and at no charge as stipulated herein, with new or reconditioned parts or products if found to be defective during the limited warranty period specified above.

All replaced parts and products become the property of SAMSUNG and must be returned to SAMSUNG.

Replacement parts and products assume the remaining original warranty, or ninety (90) days, whichever is longer.

This limited warranty covers manufacturing defects in materials and workmanship encountered in normal, noncommercial use of this product and shall not apply to the following: damage that occurs in shipment; delivery and installation; applications and uses for which this product was not intended; altered product or serial numbers; cosmetic damage or exterior finish; accidents, abuse, neglect, fire, water, lightning, or other acts of nature or God; use of products, equipment, systems, utilities, services, parts, supplies, accessories, applications, installations, repairs, external wiring or connectors not supplied or authorized by SAMSUNG that damage this product or result in service problems; incorrect electrical line voltage, fluctuations and surges; customer adjustments and failure to follow operating instructions, maintenance and environmental instructions that are covered and prescribed in the instruction book; product removal and reinstallation; problems caused by pest infestations.

This limited warranty does not cover problems resulting from incorrect electric current, voltage or supply, light bulbs, house fuses, house wiring, cost of a service call for instructions, or fixing installation errors.

SAMSUNG does not warrant uninterrupted or error-free operation of the product.

Warranty (CANADA)

EXCEPT AS SET FORTH HEREIN, THERE ARE NO WARRANTIES ON THIS PRODUCT EITHER EXPRESS OR IMPLIED, AND SAMSUNG DISCLAIMS ALL WARRANTIES INCLUDING, BUT NOT LIMITED TO, ANY IMPLIED WARRANTIES OF MERCHANTABILITY, INFRINGEMENT OR FITNESS FOR A PARTICULAR PURPOSE. NO WARRANTY OR GUARANTEE GIVEN BY ANY PERSON, FIRM, OR CORPORATION WITH RESPECT TO THIS PRODUCT SHALL BE BINDING ON SAMSUNG.

SAMSUNG SHALL NOT BE LIABLE FOR LOSS OF REVENUE OR PROFITS, FAILURE TO REALIZE SAVINGS OR OTHER BENEFITS, OR ANY OTHER SPECIAL, INCIDENTAL OR CONSEQUENTIAL DAMAGES CAUSED BY THE USE, MISUSE, OR INABILITY TO USE THIS PRODUCT, REGARDLESS OF THE LEGAL THEORY ON WHICH THE CLAIM IS BASED, AND EVEN IF SAMSUNG HAS BEEN ADVISED OF THE POSSIBILITY OF SUCH DAMAGES. NOR SHALL RECOVERY OF ANY KIND AGAINST SAMSUNG BE GREATER IN AMOUNT THAN THE PURCHASE PRICE OF THE PRODUCT SOLD BY SAMSUNG AND CAUSING THE ALLEGED DAMAGE.

WITHOUT LIMITING THE FOREGOING, PURCHASER ASSUMES ALL RISK AND LIABILITY FOR LOSS, DAMAGE, OR INJURY TO PURCHASER AND PURCHASER'S PROPERTY AND TO OTHERS AND THEIR PROPERTY ARISING OUT OF THE USE, MISUSE, OR INABILITY TO USE THIS PRODUCT.

THIS LIMITED WARRANTY SHALL NOT EXTEND TO ANYONE OTHER THAN THE ORIGINAL PURCHASER OF THIS PRODUCT, IS NONTRANSFERABLE AND STATES YOUR EXCLUSIVE REMEDY.

Some provinces do not allow limitations on how long an implied warranty lasts, or the exclusion or limitation of incidental or consequential damages, so the above limitations or exclusions may not apply to you.

This warranty gives you specific rights, and you may also have other rights, which vary from province to province.

To obtain warranty service, please contact SAMSUNG at:

Samsung Electronics Canada Inc.

2050 Derry Road West,

Mississauga, Ontario L5N 0B9 Canada

1-800-SAMSUNG (726-7864)

www.samsung.com/ca/support (English)

www.samsung.com/ca_fr/support (French)

Visits by a Service Engineer to explain functions, maintenance, or installation is not covered by warranty. Please contact the Samsung call center at the number above for help with any of these issues.

Memo

SAMSUNG



Scan the QR code* or visit
www.samsung.com/spsn
to view our helpful
How-to Videos and Live Shows

*Requires reader to be installed on your smartphone

Scan this with your smartphone



This product qualifies for ENERGY STAR in the factory default
"NORMAL" setting.

If you change the factory default setting or enable other features,
power consumption could increase and exceed the limits qualified
for ENERGY STAR.

QUESTIONS OR COMMENTS?

COUNTRY	CALL	OR VISIT US ONLINE AT
U.S.A	1-800-SAMSUNG (726-7864)	www.samsung.com/us/support
CANADA	1-800-Samsung (726-7864)	www.samsung.com/ca/support (English) www.samsung.com/ca_fr/support (French)