

The Savant® In-Wall Wired Charging & Control Dock (ICC-T000) Quick Reference Guide provides the information necessary to install the In-Wall Wired Charging & Control Dock for Apple iOS devices.



Box Contents

- (1) In-Wall Wired Charging & Control Dock (ICC-T000)
- (1) Cut out template (009-0245-xx)
- (1) Installation Kit (075-0106-xx)
 - (1) 24V DC 60W power supply (025-0046-xx)
 - (1) Power Cable (2 ft) (064-0048-xx) or appropriate international cord
 - (4) #6 x 1.5 Screw (039-0173-xx)
 - (4) #6-32 x 2.25 Screw (039-0209-xx)
 - (2) 2-position, Phoenix Connector (028-9160-xx)
- (1) Quick Reference Guide (this document)

Accessories

- (1) In-Wall Bezel for iPod 1-Pack (BZB/W/A/P-1iPod-xx) Black/White/Almond/Primer
- (1) In-Wall Bezel for iPod 5-Pack (BZB/W/A/P-5iPod-xx) Black/White/Almond/Primer (Single color per 5-Pack)
- (1) Construction Box for In-Wall Dock (RIB-IT00)

Specifications

Environmental	
Operating Temperature	32° to 104° F (0° to 40° C)
Operating Humidity	10% to 90% Non-condensing
In-Wall Dock - Dimensions and Weight	
Dimensions (H x W x D)	6.3 in x 3.6 in x 2.5 in (16.3 cm x 9.1 cm x 6.4 cm)
Weight	1.0 lb/0.45 kg
In-Wall Dock Bezel - Dimensions and Weight	
Dimensions (H x W x D)*	6.4 in x 3.7 in x 0.14 in (16.3 cm x 9.4 cm x 0.35 cm)
Weight	0.25 lb/0.11 kg
Power	
Supply	24V DC, 120-230V AC, 50/60Hz
Maximum Power Draw	10 Watts
Power cable length	5 300 ft maximum AWG 20
Compliance	
Safety and Emissions	FCC Part 15/CE Mark/C-Tick
RoHS	Compliant

⚠️ SURGE PROTECTION: Use a surge-protected circuit for all components requiring 120/230V AC, 50/60 Hz source power.

⚠️ ELECTRICAL DISCONNECT: The 120/230V AC, 50/60 Hz source power outlet and input power sockets should be easily accessible in the event of an electrical hazard or malfunction condition.

⚠️ ELECTRICAL DISCONNECT: Remove power before working on the dock.

Wiring to Dock

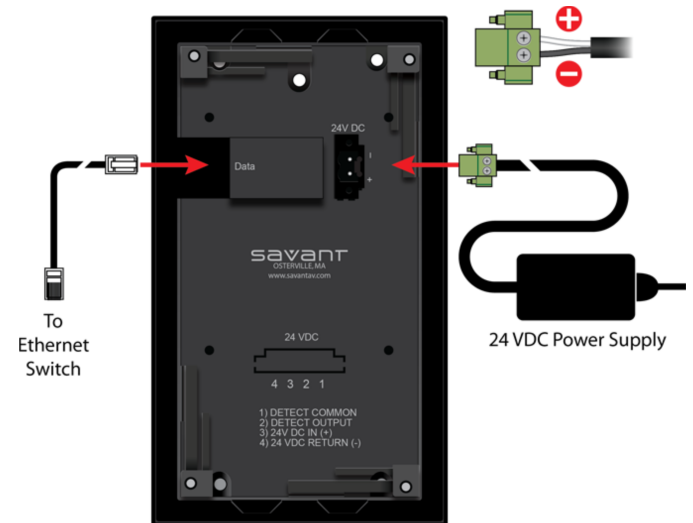

Wiring and Pinouts

In-Wall Wired Charging Dock 24V DC		
+ (Positive)	White	24V DC In
- (Negative)	Black	24V DC Return

Installation without RIB-IT00 Construction Box

Note: The iPod dock can be installed in either landscape or portrait orientation.

- Connect the 24V DC power supply to the In-Wall Dock and route inside the wall opening.
- Route the Cat5 cable to inside the wall opening.
- After making the connections to In-Wall Dock, position the unit in the opening and secure with the four rotating mounting tabs.
- Turn the tab screws clockwise; the tabs will grab the interior wall. Tighten until snug. **Do not over tighten.**

Caution: Do not use a powered screwdriver to tighten the tabs; the tabs can be easily over tightened.

- Position the bezel over the In-Wall Dock and press, ensuring that the wall plate seats properly. (See below)
- Configure the installation using RacePoint Blueprint™.

Note: The In-Wall Dock also has optional screw mounting holes for optional stud mounting.

Optional Pre/Post-Construction Box

Note: The In-Wall Dock Assembly is not a weather resistant unit. Do not locate in a damp or humid area.

The ICC-T000 can be installed with or without an in-wall construction box. The in-wall construction box (RIB-IT00) is optional and can be used pre- or post-construction to save the space required for the ICC-T000, ICC-TP00 or IDC-T000 and to terminate the roughed in wires.

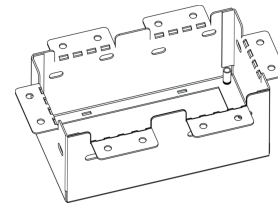

⚠️ Important: Always locate the studs and utilities (electrical wires, ducts, water and gas pipes) before cutting an opening in the wall. Ensure all required power and control cables have been routed to the site of construction box.

Installing the In-Wall Dock into the RIB-IT00

- Remove Retainer caps (4) from the back of the ICC-T000 with pliers.
- Remove tabs (4) by removing the screws.
- Place the ICC-T000 into the RIB-IT00 and use the 8-32 screws (4) to attach.

Caution: Do not use a powered screwdriver to tighten the tabs; the tabs can be easily over tightened.

Install the iPod touch® into the In-Wall Dock

1. Position the iPod into the In-Wall dock as shown below.
2. Ensure the iPod slides through the brackets and is inserted fully.
3. Tilt the iPod back until it stops.
4. Secure the iPod to the In-Wall dock with the captive screw.

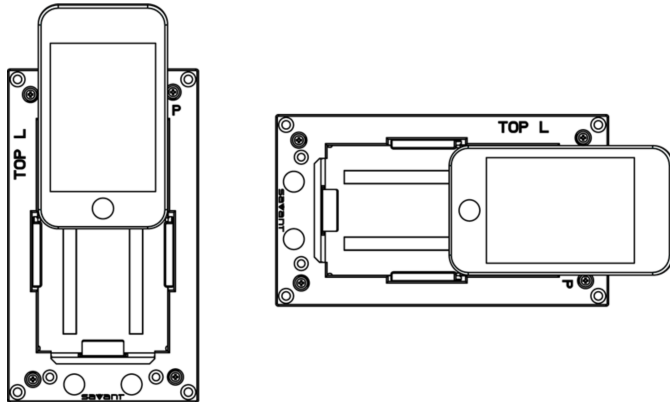

Install the Bezel

1. Position the bezel over the iPod in the In-Wall Dock.
2. Ensure the bezel seats properly.

Setting a Static IP Address on a Savant Controller

1. On the Savant Development Environment (SDE), go to the Apple OS X menu bar and locate **Spotlight** in the top right corner.



2. Enter **rpmembscanner**



3. The **Embedded Scanner** window will open and populate with the Savant IDs (UID) and associated IP addresses of all Savant controllers that reside on the same subnet as the SDE.
4. **Note:** The SDE must be connected to the same network as the Savant System.
5. Select the controller UID from the list and click **Edit**.
6. A settings drawer will open to the side allowing you to enter the settings for this controller.
7. Change the Configure option to **Manually** and enter the IP address. The **Subnet Mask** information will automatically complete. From the **Router** option, enter the Router IP Address.
8. Select **Save & Reboot**. After a short period of time, the controller will come back online with the new IP Address.

Note: When you need to ensure that a Savant controller's IP Address is static we recommend setting this by making a DHCP Reservation on your router. The method of setting the reservation may be different depending on the model of router on your network.

Additional Documentation

For more documentation, go to SavantSystems.com and navigate as follows:

> **Dealer Login** > **Knowledge Base** > **Products**

- Refer to the **Construction Box for In-Wall Dock (RIB-IT00) Quick Reference Guide**
- Refer to the **RacePoint Blueprint™ Programming Guide**