

ID-24FI



FEATURES

- Accepts custom panels for an integrated look within cabinetry or stainless-steel accessory panels and handles to match other Sub-Zero, Wolf, and Cove products*
- Controls temperature within one degree of setpoint
- Locks in cold air to ensure freshness with magnetic door seals
- Control brightness with soft-on LED lighting
- Yields ice automatically and “max ice” for additional production
- Open and close doors silently with soft-close technology
- Produces ice automatically into a removable ice container

ACCESSORIES

- Dual Installation Kit
- Reduced Toekick Divider
- Stainless Steel Pro Handles
- Stainless Steel Tubular Handles
- Stainless Steel Drawer Panels With Pro Handles - 4" Toe Kick
- Stainless Steel Drawer Panels With Tubular Handles - 4" Toe Kick
- Stainless Steel Dual Installation Kickplates

Accessories are available through an authorized dealer.
For local dealer information, visit subzero-wolf.com/locator.



HANDLE ACCESSORIES

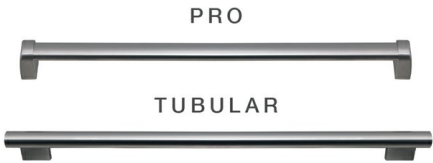

PRODUCT DETAILS

FREEZER

- Adjustable drawer dividers
- LED lighting

PRODUCT SPECIFICATIONS

Model	ID-24FI
Dimensions	24"W x 34 1/2"H x 24"D
Freezer Capacity	3.8 cu. ft.
Weight	185 lbs
Electrical Supply	115 VAC, 60 Hz
Electrical Service	15 amp dedicated circuit
Plumbing Supply	1/4" OD copper, braided stainless steel or PEX tubing
Plumbing Pressure	35–120 psi

ELECTRICAL

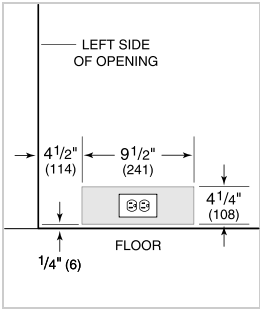

PLUMBING

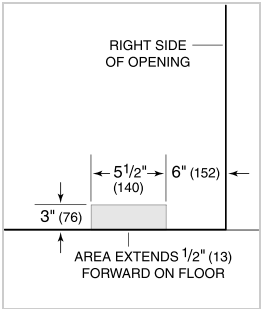

NOTE: The electrical outlet must be positioned with the grounding prong to the right of the thinner blades.

PANEL SPECIFICATIONS For complete panels specifications including width/height, weight requirements and thickness requirements visit subzero-wolf.com/reveal.

NOTE: Dimensions in parenthesis are in millimeters unless otherwise specified

INTERIOR VIEW

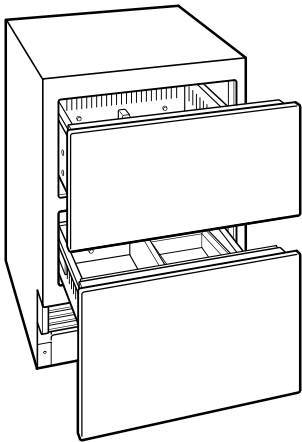

This illustration is intended for interior reference only and may not represent the exterior of the model being specified.

DIMENSIONS

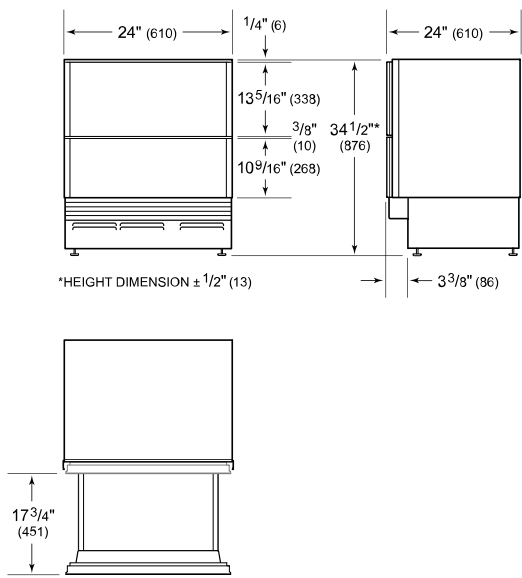

STANDARD INSTALLATION

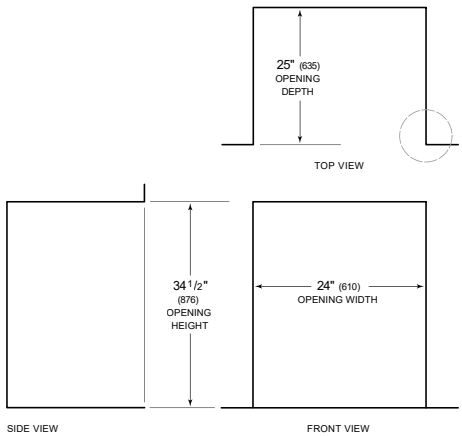

NOTE: 3 1/2" (89) finished returns will be visible and should be finished to match cabinetry

