

# TA83017COM

## ASSEMBLY INSTRUCTION

**P1** Headboard

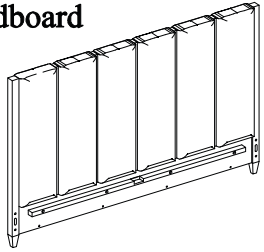

x 1

**P6** Post (short)



x 2

**P7** Support

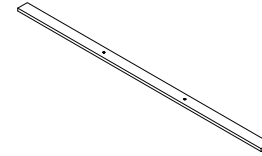

x 1

**P8** Slat

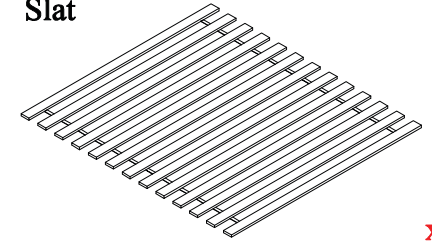

x 1

**P2** Footboard

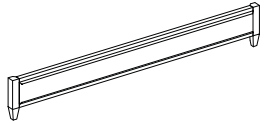

x 1

**01** Steel threaded bar

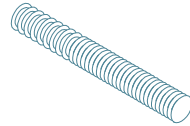

x 8

**02** Hexagonal nut & washer

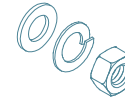

x 8

**03** Steel open wrench

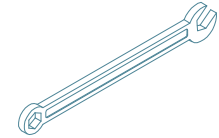

x 1

**P3** Side Rail (left)

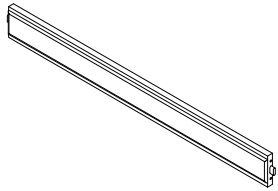

x 1

**P4** Side Rail (right)

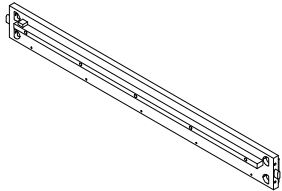

x 1

**P5** Post (long)



x 2

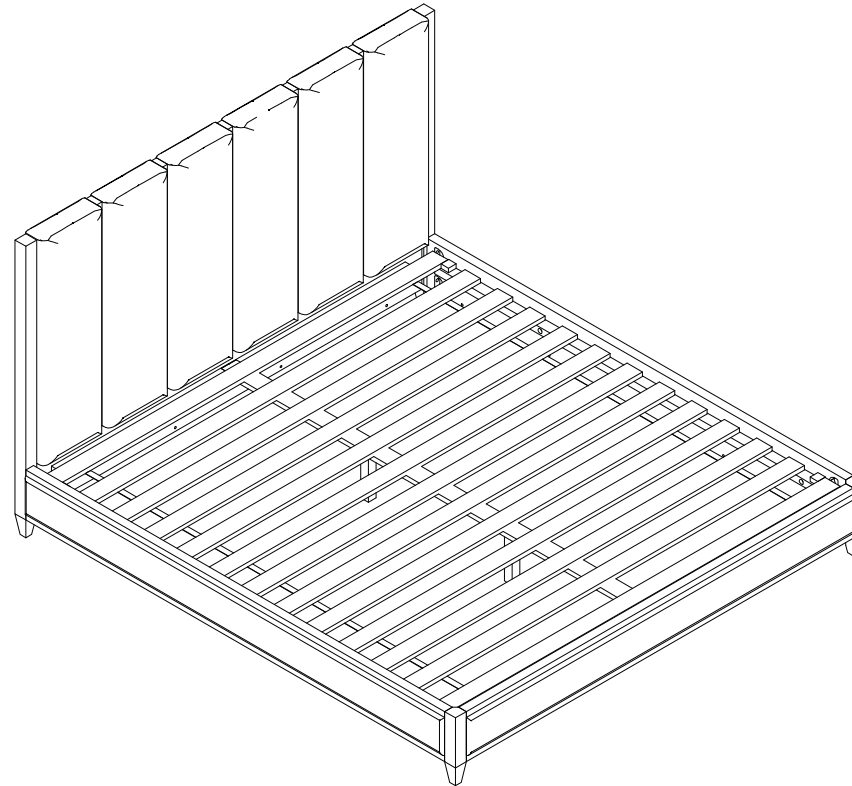

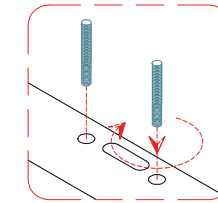
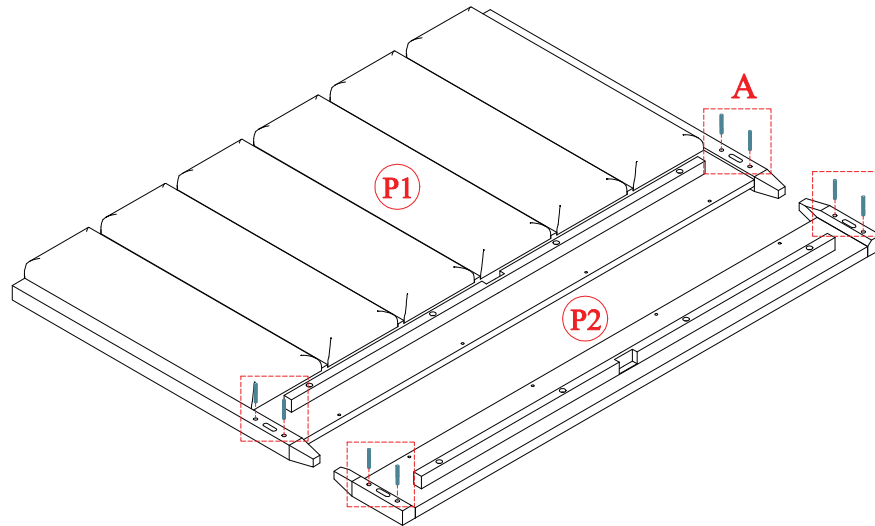
TA83017COM  
ASSEMBLY INSTRUCTION

Detail 'A'

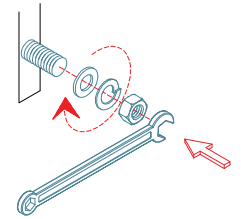

Detail 'B'

**INSTRUCTIONS :**

1. Assemble the threaded bar to the headboard (P1) and the footboard (P2) by turning it clockwise direction until it is tighten. Refer detail 'A'.
2. Assemble the side rail (P3) & (P4) to the headboard (P1) then insert hexagonal nut & washer, use steel open wrench and turn clockwise direction to tightened them. Refer detail 'B'.
3. Assemble the footboard (P2) to the side rail (P3) & (P4) then insert hexagonal nut & washer, use steel open wrench and turn clockwise direction to tightened them. Refer detail 'B'.

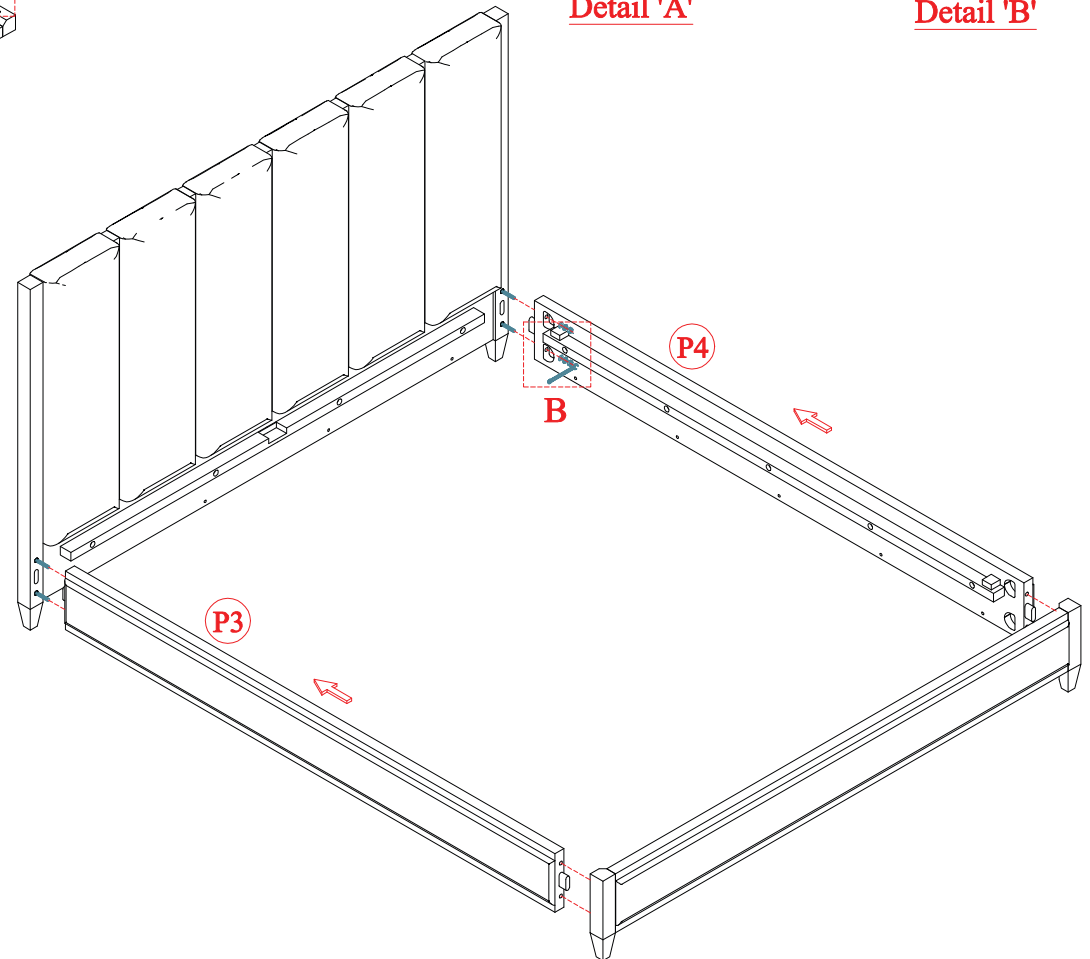

TA83017COM  
ASSEMBLY INSTRUCTION

## OPTION (1) :

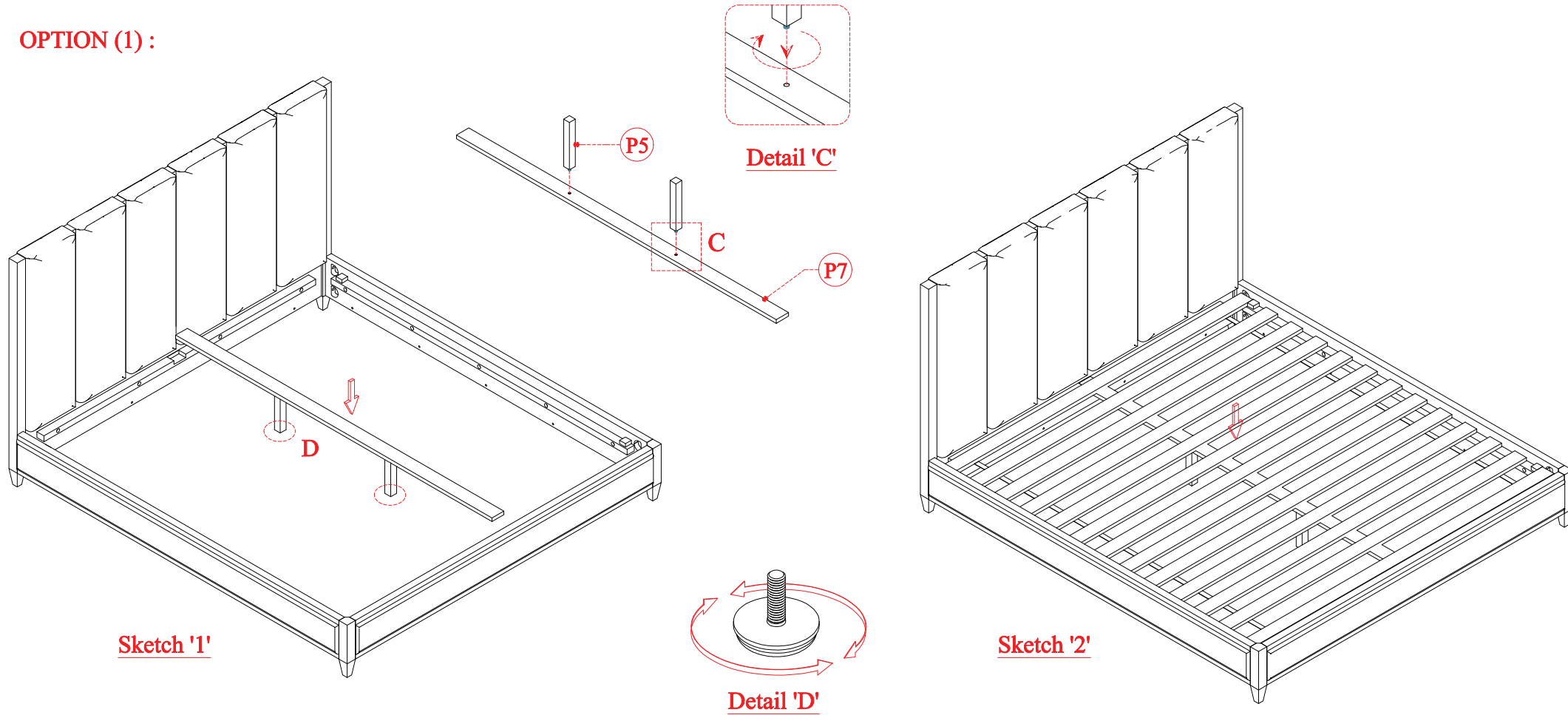
**OPTION 1: (WITHOUT BOX SPRING)**

4. Assemble the post (long) (P5) to the support (P7) by turning it clockwise direction until it is tighten. Refer detail 'C'.
5. Attach the support (P7) to the headboard and the footboard. See sketch '1'.
6. Attach the slat (P8) to the support (P7). See sketch '2'.
7. Item is ready to use. (Adjust all the glider for levelling if necessary. Refer detail 'D'.)

TA83017COM  
ASSEMBLY INSTRUCTION

## OPTION (2) :

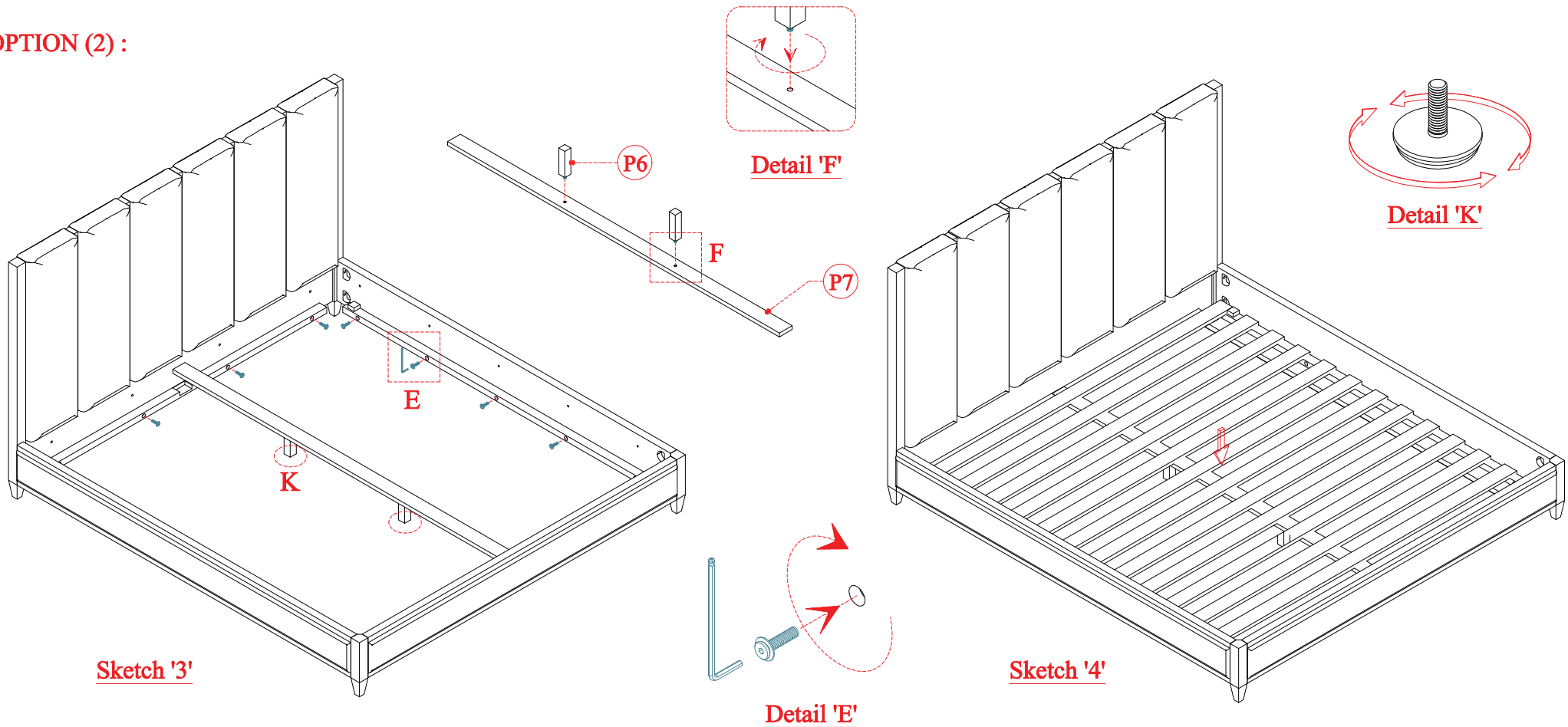
OPTION 2: ( BOX SPRING)

8. Move the beam downwards, then detach steel allen bolt & washer, use steel allen wrench and turn clockwise direction to tightened them. Refer detail 'E'.
9. Assemble the post (short) (P6) to the support (P7) by turning it clockwise direction until it is tighten. Refer detail 'F'.
10. Attach the support (P7) to the headboard and the footboard. See sketch '3'.
11. Attach the slat (P8) to the support (P7). See sketch '4'.
12. Item is ready to use. (Adjust all the glider for levelling if necessary. Refer detail 'K'.)