

ASSEMBLY INSTRUCTIONS

MODEL #

CM-BK1032-FF

Questions?

GIVE US A CALL: 1-888-980-5122
MON-FRI 8:30AM - 5:30PM (PT)

TOOLS REQUIRED

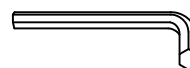

Allen Wrench

(Included)

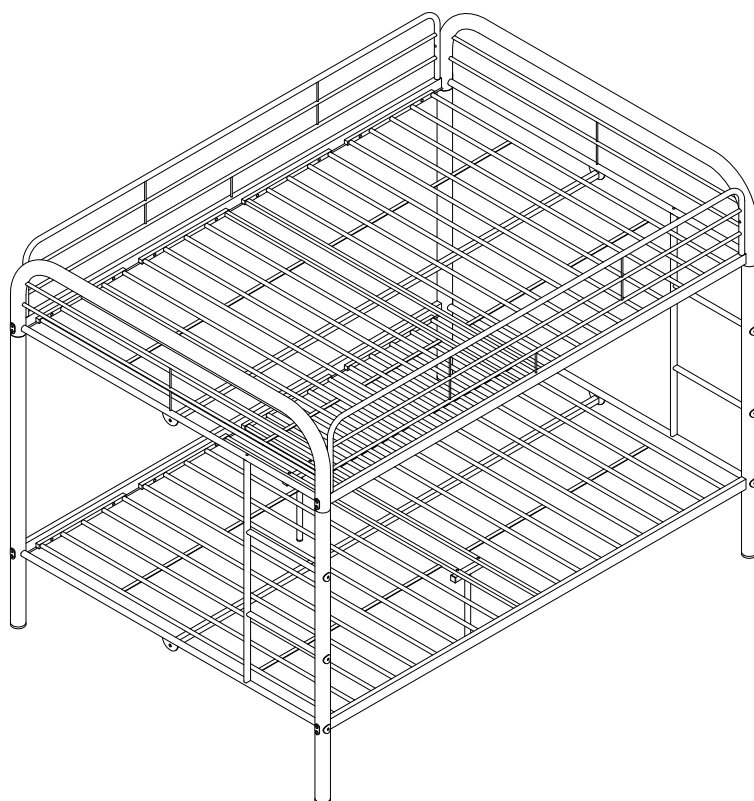

2 - Persons
Recommended

ASSEMBLY RATING



EASY ————— DIFFICULT

The Assembly Rating is a 5-point system showing the level of effort needed to assemble a specific product.



Thank you for your purchase!

We hope you enjoy this new addition to your home for many years to come.

Our commitment to providing quality products does not simply end when you purchase our product. We fully stand behind our products from start to finish. Our customer service department is available Monday – Friday 8:30 AM – 5:30 PM Pacific Time and can help with assembly questions as well as, if necessary, replacing damaged or missing parts. To help expedite our service, please have these assembly instructions readily available, along with your order receipt.



Consumer Hotline
Toll-Free 1-888-980-5122



Monday to Friday
8:30AM- 5:30PM (PT)



WEBSITE
www.foagroup.com



E-MAIL
cs.ec@foagroup.com



foagroup



FurnitureOfAmerica



CHECK BEFORE STARTING

☐

Are you missing anything?

Double-check all parts, hardware and accessories listed are all accounted for.

☐

Check out our Quick Tips!

We recommend reviewing the pre-assembly handouts. Even experts need a refresher now and then!

☐

Should we send any replacements?

Are there any irregularities or flaws in the parts? We can send replacements!

☐

Prep Time!

Please review the assembly instructions and all diagrams prior to assembling.

PRE ASSEMBLY INTRODUCTION

We understand building ready-to-assemble furniture can be a challenging experience for some. To help avoid confusion, we have provided some helpful tips that may speed up the process.

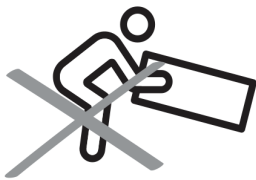

Teamwork

ALWAYS have at least two people to help with transporting and assembling the product to avoid potential injury and/or damage.

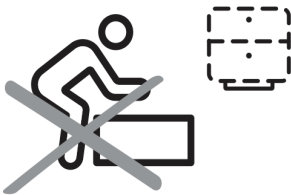

Suitable Location

Assembling near the area of the intended location is highly recommended.



Sufficient Space

Make sure you have enough space to move around during the assembly.



Avoid Scratches

Use cardboard, blankets or a carpeted area while assembling furniture to prevent to prevent scratches and damages.

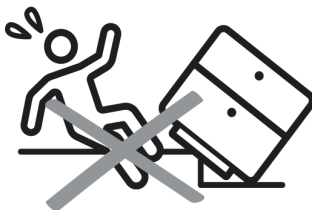

Flat Surface

Make sure the furniture rests on a flat and level surface with each leg evenly touching the floor.

ASSEMBLY AND CARE ADVICE



**FAILURE TO FOLLOW THE GUIDELINES BELOW MAY
RESULT IN INJURY AND/OR PROPERTY DAMAGE.**



Position each part correctly
and insert screws or bolts into
their respective holes.

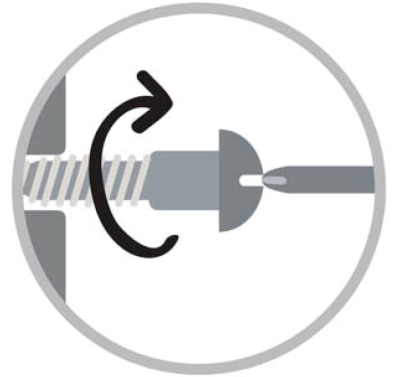

Turn clockwise to tighten and
only tighten when step is
completed or when instructed
to do so.



Save the instructions and store
any supplied tools for later
maintenance.

Use the appropriate hand tools
or power tools for assembly.
Select steps, such as tightening
screws and/or bolts, may require
hand tools to avoid causing
damage during assembly.



After two weeks, check and
tighten any loose hardware and
repeat again every six months
thereafter.

IT IS THE USER'S RESPONSIBILITY TO MAINTAIN THE FURNITURE. THE HARDWARE MAY LOOSEN OVER TIME AND MAY CAUSE THE FURNITURE TO BE WOBBLY AND UNABLE TO SUPPORT ITS INTENDED WEIGHT CAPACITY. THIS MAY LEAD TO COLLAPSE AND MAY CAUSE SERIOUS INJURY.

Metal Full/Full size Bunk bed

CM-BK1032-FF



- Please keep instructions for future reference.
- Check the quantity and irregularity of parts and hardware before you start.

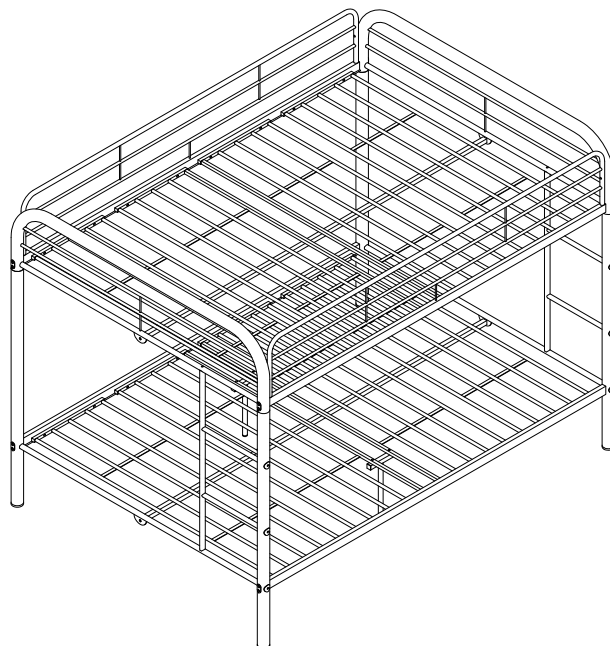

PARTS

1 1pc



Left Front Post

2 2pcs



Rear Post

3 1pc



Right Front Post

4 1pc

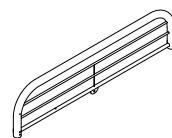

Left Bed End

5 1pc

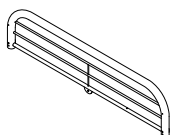

Right Bed End

6 2pcs

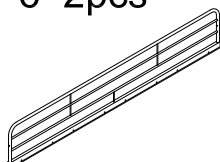

Guardrail

7 2pcs

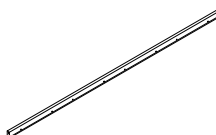

Lower Side Rail

8 2pcs



Ladder Post

9 2pcs

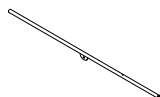

Lower Cross Bar

10 4pcs



Ladder Pedal

11 4pcs

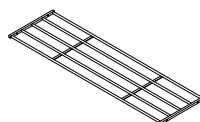

Side Board

12 2pcs

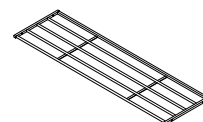

Up Middle Board

13 2pcs

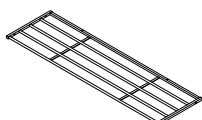

Down Middle Board

14 2pcs

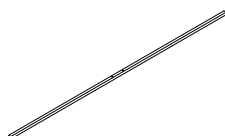

Cross Tube

15 2pcs



Support Legs

Metal Full/Full size Bunk bed

CM-BK1032-FF

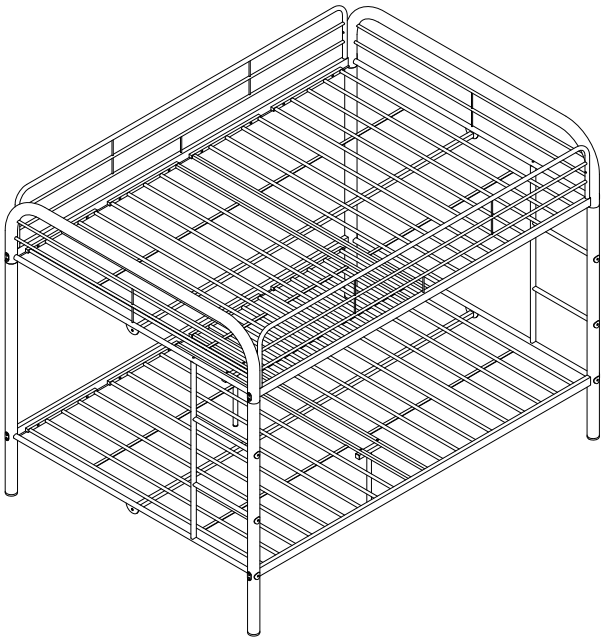
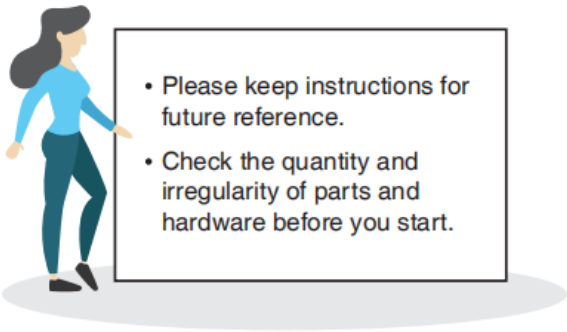

HARDWARE

A 4pcs



Bolt 1/4" x 5/8"

B 40pcs



Bolt 1/4" x 1"

C 4pcs



Bolt 1/4" x 1-1/8"

D 12pcs



Bolt 1/4" x 1-3/8"

E 4pcs



Bolt 1/4" x 3"

F 16pcs



Bolt 1/4" x 3"

G 8pcs



Washer Ø32xØ8x2.3

H 1pc



Allen Wrench M4

I 1pc



Paint

ASSEMBLY INSTRUCTIONS

1

Exploded View

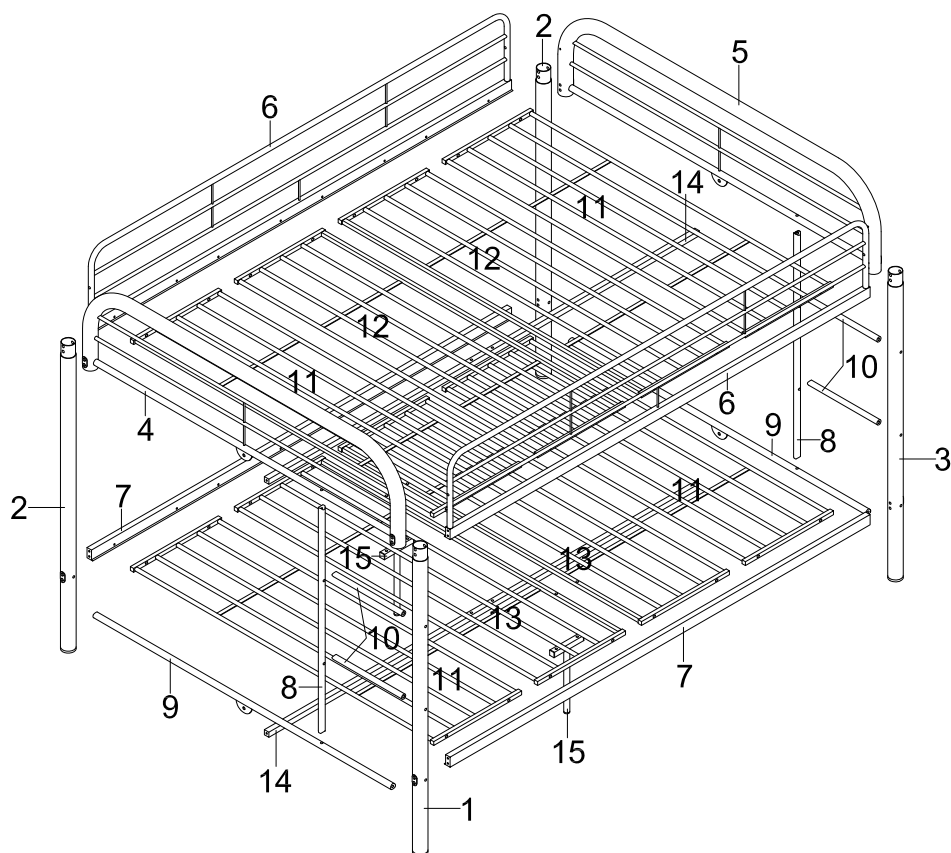

2

- Part 1 x 1pc
- Part 2 x 2pcs
- Part 3 x 1pc
- Part 4 x 1pc
- Part 5 x 1pc

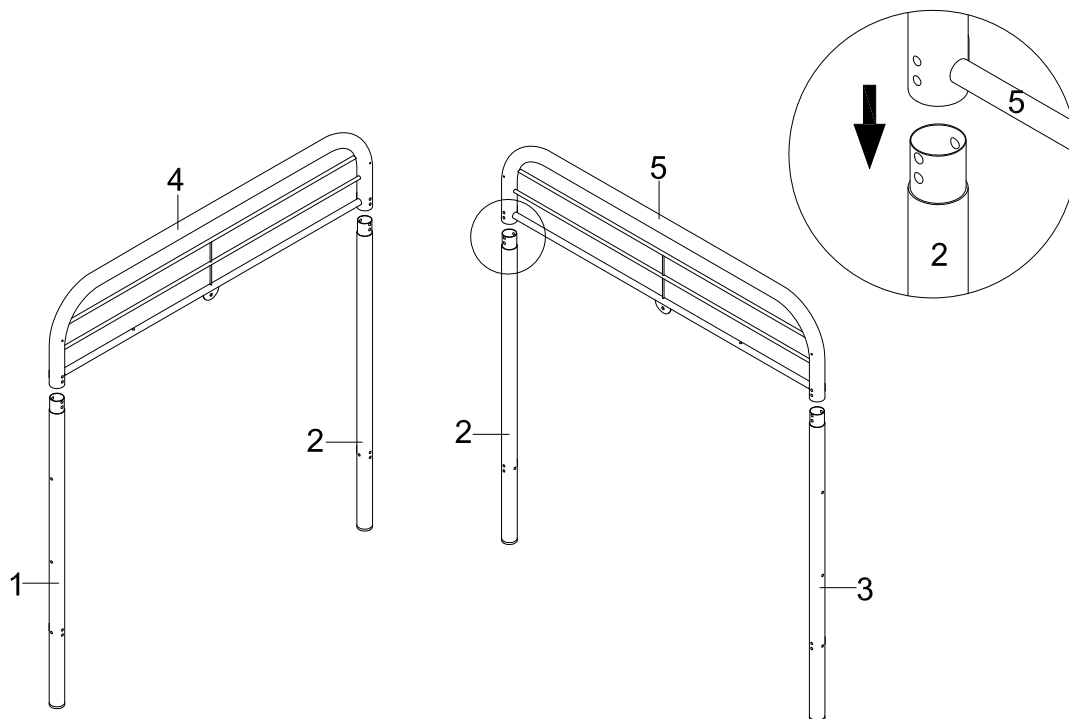

DO NOT TIGHTEN THE SCREWS UNTIL ASSEMBLING THE FINAL STEP.

ASSEMBLY INSTRUCTIONS

3

Part 8 x 2pcs
Part 9 x 2pcs
Part 10 x 4pcs
Hardware A x 4pcs
Hardware D x 8pcs
Hardware E x 4pcs
Hardware G x 8pcs
Hardware H x 1pc

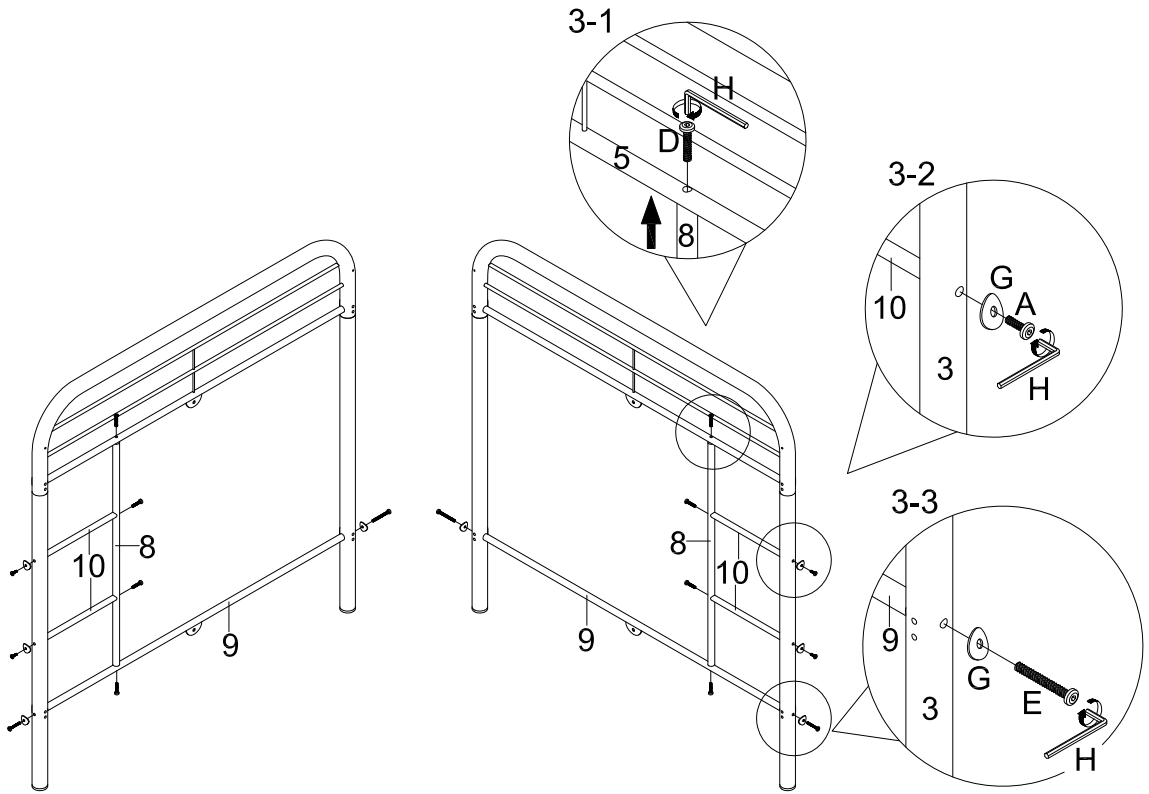

4

Part 6 x 2pcs
Part 7 x 2pcs
Hardware D x 4pcs
Hardware F x 16pcs
Hardware H x 1pc

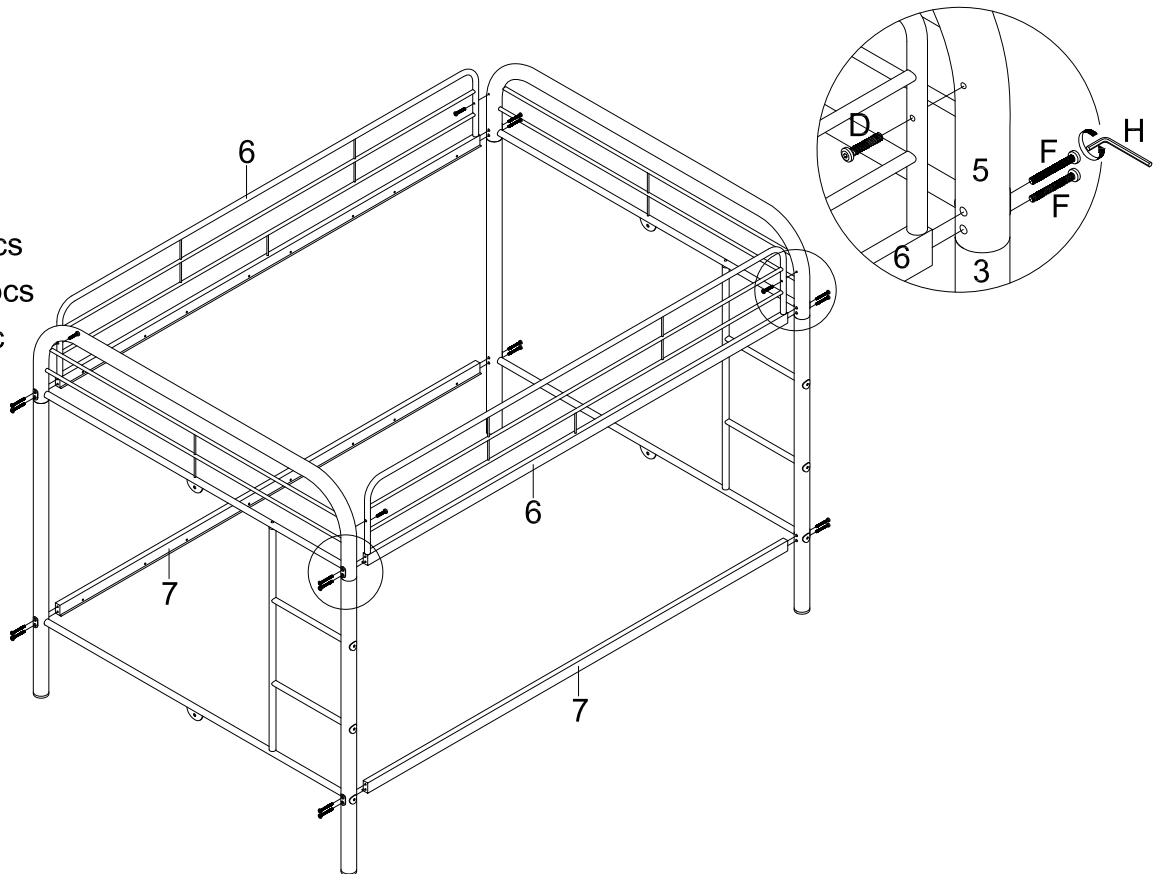

ASSEMBLY INSTRUCTIONS

5

Part 11 x 4pcs
Part 12 x 2pcs
Part 13 x 2pcs
Hardware B x 32pcs
Hardware H x 1pc

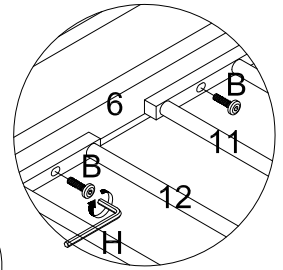
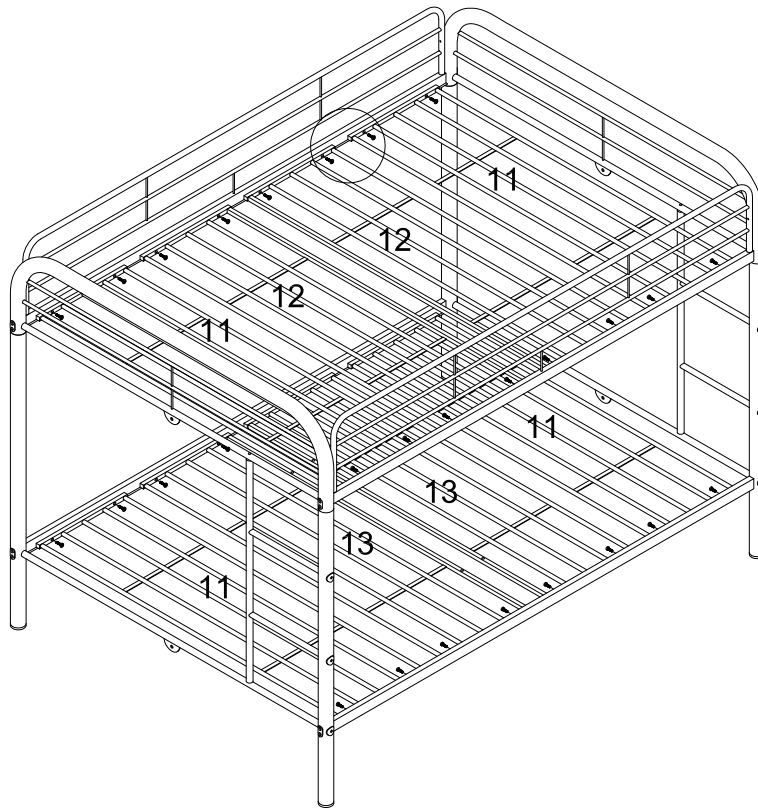

6

Part 14 x 2pcs
Hardware B x 4pcs
Hardware C x 4pcs
Hardware H x 1pc

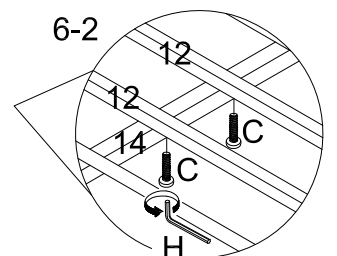
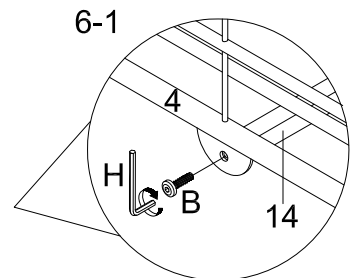
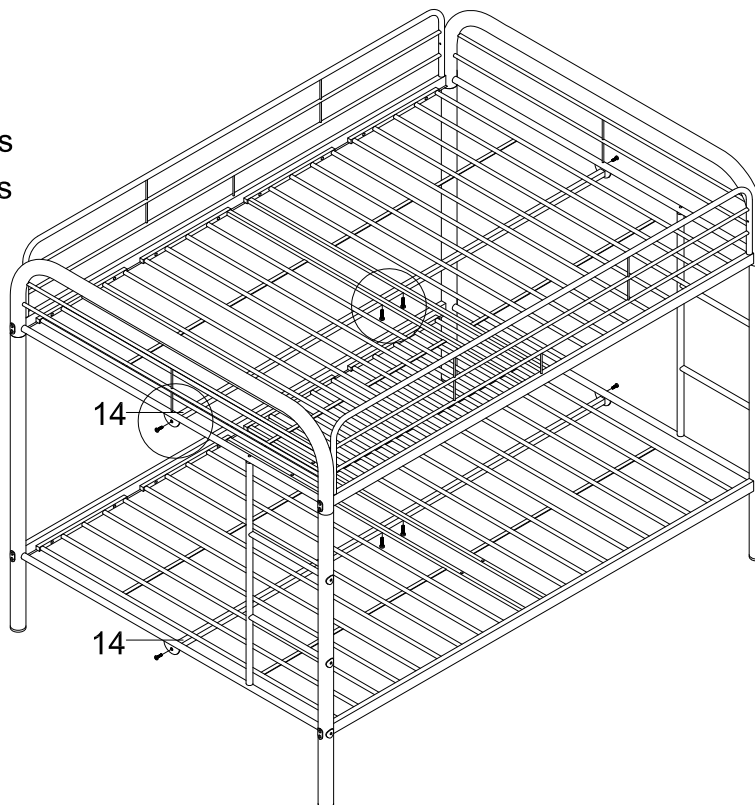

ASSEMBLY INSTRUCTIONS

7

Part 15 x 2pcs
Hardware B x 4pcs
Hardware H x 1pc

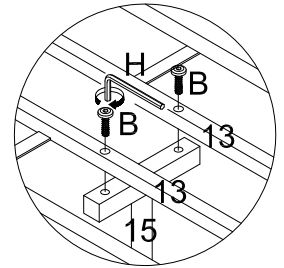
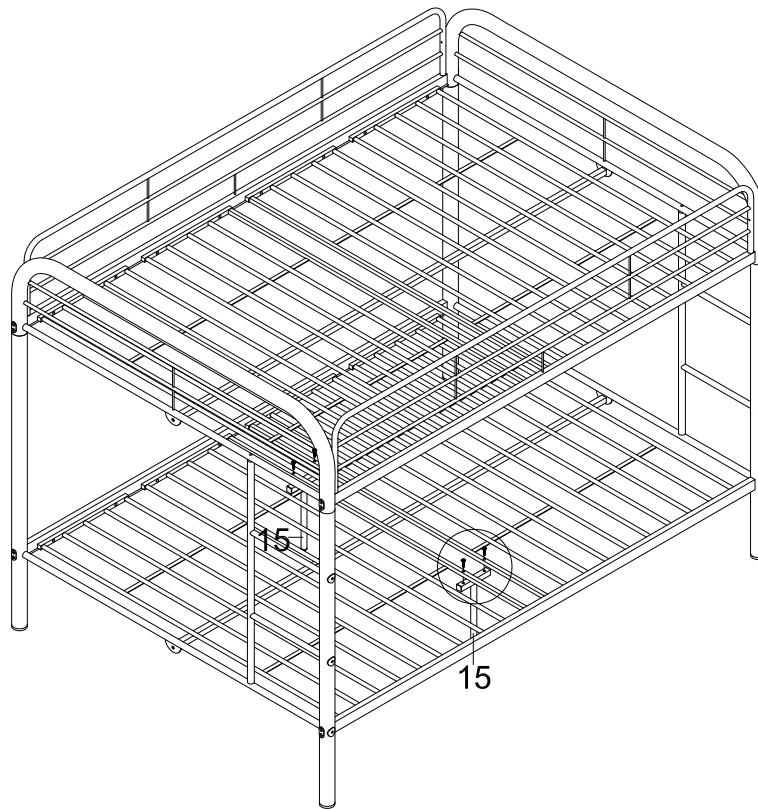

8

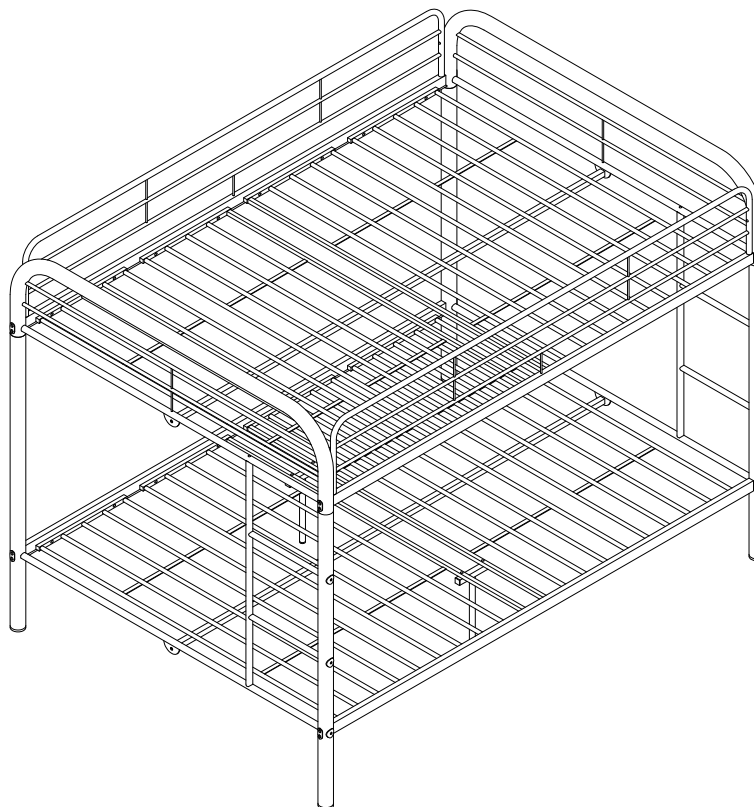

- ✓ **Keep this handy!**
Please retain this instruction manual and any order-related information for future reference.
- ✓ **Lift, don't drag!**
To avoid damage to product please always LIFT the product when transporting or adjusting the placement.

This product is intended for RESIDENTIAL USE ONLY and not for commercial use.

Safety Warnings

1. Follow the information on the warnings appearing on the upper bunk end structure and on the carton . Do not remove warning label from bed.
2. Always use the recommended size mattress or/and mattress support to help prevent the likelihood of entrapment or falls.
3. Surface of mattress must be at least 5 in. below the upper edge of guardrails .
4. Do not allow children less than 6 years of age to use the upper bunk.
5. Periodically check and ensure that the guardrail, ladder ,and other components are in their proper position ,free from damage ,and that all connectors are tight .
6. Prohibit horseplay on/or under the bed and prohibit jumping on the bed.
7. Always use the ladder for entering and leaving the upper bunk.
8. Do not use substitute parts ,Contact manufacturer or dealer for replacement parts.
9. Use of a night light may provide added safety precaution for a child using the upper bunk.
10. Always use guardrails on both long sides of the upper bunk.
11. If the bunk bed will be placed next to a wall, the guardrail that runs the full length of the bed should be placed against the wall to prevent entrapment between the bed and the wall.
12. The use of water or sleep flotation mattress is prohibited .
13. Keep these instructions for future reference.
14. Use only mattress which is 74 3/4"x54" x6" on upper bunk and for bottom bunk required 74 3/4"x54" x8"mattress.
15. Prohibit more than one person on upper bunk.

STRANGULATION HAZARD:

16. Never attach or hang items to any part of the bunk bed that are not designed for use with the bed for example, but not limited to hooks, belts, and jump ropes.