

## Initial commissioning

⚠ Before using the tumble dryer for the first time, ensure that it is correctly installed and connected.

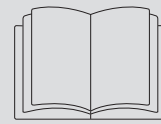

It is **essential** to read the operating instructions.

## Operation

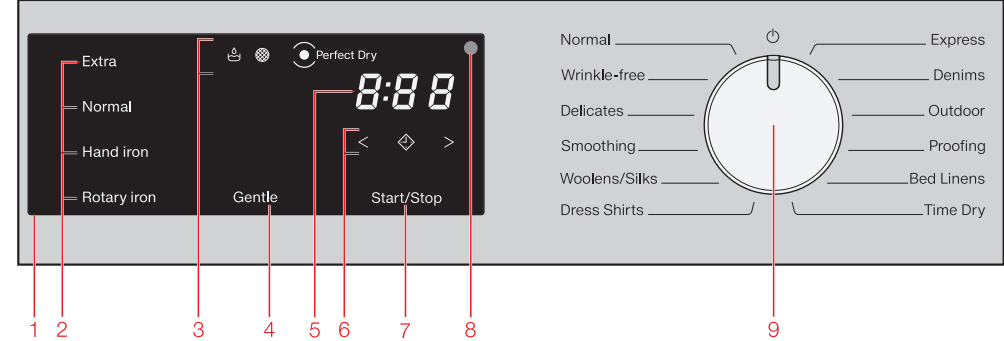

### 1 Display

The sensor buttons 2, 4, 6 and 7 react to fingertip contact. Selection is possible as long as the respective sensor button is illuminated.

- If a sensor button is **brightly** lit, this means: currently selected
- If a sensor button is **dimly** lit, this means: selection possible

### 2 Sensor buttons for the drying levels

After a drying level program is selected with the program selector, the proposed drying level lights up.

### 3 Indicator lights

- ☼ lights up if necessary: see "Frequently Asked Questions".
- ● **PerfectDry**:

The Perfect Dry system measures the residual moisture present in the laundry in programs with selectable drying levels and provides a more precise drying result.

This message ...  
... will flash until the program duration has been determined and then go out.  
... will light up again when the selected drying level is reached and remain on until the end of the program.

... remains off with the following programs: *Woolens/Silks*, *Time Dry*.

### 4 Gentle sensor button

For drying temperature-sensitive textiles with the ☼ symbol.

### 5 Time display

The remaining program duration will be displayed in hours and minutes.

### 6 < > sensor buttons

- After touching the < > sensor button, a later start time for the program (Delay Start) can be selected.
- The < > sensor buttons are used for selecting the duration of the delay start period or the duration of the Time Dry program.

### 7 Start/Stop sensor button

Touching the *Start/Stop* sensor button starts the selected program or cancels a program that has already been started. The sensor button flashes slowly as soon as it is possible for a program to be started and then lights up constantly after the program has started.

### 8 Optical interface

For service technicians.

### 9 Program selector

For selecting program and for switching off. The tumble dryer is switched on when you select a program and switched off by turning the program selector to the ☼ position.

For selecting program and for switching off. The tumble dryer is switched on when you select a program and switched off by turning the program selector to the ☼ position.

## Drying

### 1. Notes on correct laundry care

⚠ Remove foreign objects like detergent dispensing devices from the laundry. They can melt and damage the dryer and the laundry.

- Sort the laundry according to the type of fiber and weave, size, garment care label symbol, and the drying level required.
- Untangle the laundry.
- Check seams and stitching to ensure that padding and linings are intact.
- Fasten duvet covers and pillow cases to prevent small items from being rolled up inside them.
- Fasten hooks and eyes.
- Tie together textile belts and apron ties.
- Sew in or remove underwiring from bras.

### 3. Loading the tumble dryer

- Open the door.
- Unfold the laundry and load loosely into the drum.

⚠ Do not overload the drum. Overloading can cause unnecessary wear and tear to the laundry, give a disappointing drying result and cause more creasing.

⚠ If you are not using a fragrance flacon: The tab must be pushed down completely (see arrow).

⚠ When closing the door, make sure that laundry does not get trapped in the door opening.

- Shut the door with a gentle swing.

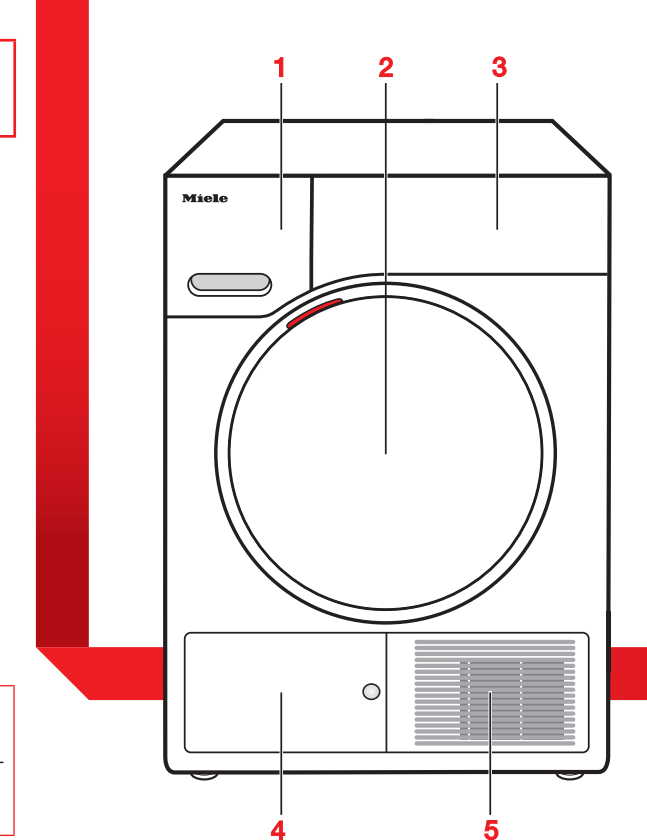

### 1 Condensed water container

– empty after every drying program

### 2 Door

### 3 Control panel

### 4 Access panel for the heat exchanger and plinth filter

– do not open during drying

### 5 Cold air intake grille

– do not obstruct with a laundry basket or other objects

### 3. Selecting a program and starting it

#### Selecting a program

- Turn the program selector.
- A drying level may light up and durations will appear on the time display

#### Programs with drying levels

– *Normal*, *Wrinkle-free*, *Delicates*, *Dress Shirts*, *Express*, *Denims*, *Bed Linens*, *Smoothing*

- Touch the sensor button for the drying level you want. It will then light up brightly.
- Any drying level can be selected for the *Normal*, *Express* and *Bed Linens* programs. A more limited range is available when using the other programs.

#### Time-controlled and other programs

– *Woolens/Silks*, *Proofing*

The drying result is preset by the dryer and cannot be altered.

– *Time Dry*

- Touch the > sensor button repeatedly until the required program duration appears on the time display. You can set the duration in ten-minute increments from 0:20 minutes to 2:00 h.

- You can change the time with the < sensor button.

### 4. Removing the laundry at the end of the program

#### Selecting *Gentle* (if necessary)

Delicate fabrics (with the ☼ symbol on the care label, e.g., acrylic garments) are dried at a lower temperature and the program duration is longer.

- Touch the *Gentle* sensor button. It will then light up brightly.

#### Selecting Delay Start (if necessary)

You can delay the start of a program from 0:30 minutes up to 24 h.

Delay Start cannot be used with the *Time Dry* program.

- Touch the < > sensor button. < > will light up brightly.

#### Starting a program

- Touch the flashing Start/Stop sensor button. The Start/Stop sensor button will light up.

Energy savings:  
After 10 minutes, the indicators dim and the *Start/Stop* sensor button starts flashing.

- Touch the *Start/Stop* sensor button to switch the indicators on again (this does not have any effect on a running program).

End of program: 0:00 lights up and the *Start/Stop* sensor button goes out:

- Energy savings: 10 minutes after the end of the program, the *Start/Stop* sensor button will begin to flash and the display will go out.
- The dryer will switch off automatically 15 minutes after the end of the Anticrease phase (with programs without an anti-crease phase, it will switch off 15 minutes after the end of the program)..

⚠ Only open the door when the drying process has finished..

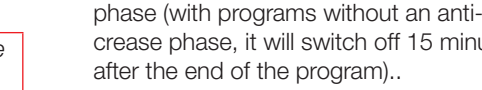

- Open the door.
- Remove the laundry.

⚠ Check that all items have been removed from the drum. If items are left in the dryer, they could be damaged by overdrying when the dryer is next used.

The inside of the drum lights up so that you don't forget any items of laundry when you empty it. The drum lighting switches off automatically (energy saving).

- Turn the program selector to ☼.
- Clean the lint filters.
- Close the drum door.
- Empty the condensed water container.

### Emptying the condensed water container

Empty the condensed water container after every drying program.

The ☼ indicator light will light up if the maximum level of the condensed water container is reached.

To turn the ☼ indicator light off: Open and close the door while the dryer is switched on.

- Remove the condensed water container.

To prevent water from running out, keep it in a horizontal position when carrying it. Hold the condensed water container at the front and towards the back.

- Empty the condensed water container.
- Replace the condensed water container in the dryer.

⚠ Do not drink condensed water.

## Changing the program

You cannot change to another program once a program has started (this prevents unintentional alterations).

If you try to change a program, -0- will light up until the original program is reset. You will need to cancel the current program before you can select a new one.

#### Cancelling the current program

- Touch the *Start/Stop* sensor button.

The items will be cooled down, depending on the temperature reached and how long they have been dried for. 0:00 will light up if you press the *Start/Stop* sensor button again during the cooling-down phase.

- Turn the program selector to the ☼ position.
- Turn the program selector to another program.
- Touch the *Start/Stop* sensor button.

#### Adding or removing laundry

- Touch the *Start/Stop* sensor button.

⚠ Risk of burns when touching hot laundry of the dryer drum.

- Pull open the door.
- Add or remove items.
- Close the door.
- Touch the *Start/Stop* sensor button. The program starts.

#### Program duration

Altering the program sequence can cause the program duration shown in the time display to be adjusted.

## Fragrance flacon

Tip: Using a fragrance flacon will add a pleasant fragrance to your laundry.

⚠ Before using a fragrance flacon, please read "IMPORTANT SAFETY INSTRUCTIONS – Using a fragrance flacon (optional accessory)" and "Fragrance flacon" in the operating instructions.

#### Inserting a fragrance flacon

1. Turn the outer ring clockwise.
2. Turn the outer ring counter-clockwise until marker ② is in position ①.

If you want to dry laundry occasionally without adding fragrance: Remove the fragrance flacon and store it in its original packaging until you want to use it again. See the following section.

3. Markers ① and ② must line up with one another.
4. Turn the outer ring clockwise a little.

Before cleaning the lint filters

- Remove the fragrance flacon (reverse points 3 and 4) and store it in its original packaging.

⚠ Never lay the fragrance flacon down on any surface as the fragrance will spill out.

CHANGING THE PROGRAM SEQUENCE

en - US

TWB120WP

Program guide

Program	Load (weight of dry laundry)	Laundry type										
			Normal	Extra	Normal	Hand iron	Rotary iron	Gentle				
Normal	Full load (17.6 lb)	T-Shirts, underwear, baby clothes, workwear, jackets, covers, aprons, overalls, hand towels, bath towels, bathrobes, bed linen For T-shirts, underwear, baby clothes: do not use Extra dry (laundry can shrink)	X	X	X	X	X	X				
Wrinkle-free	Half load (8.8 lb)	Workwear, overalls, pullovers, dresses, pants, table linen, leggings							X			
Delicates	Small load (5.7 lb)	Dress shirts, blouses, lingerie, appliquéd garments	X	X	X	X	X			always activated		
Smoothing	Very small load (2.2 lb)	Cotton pants, jackets, shirts								always activated		
Woolens/Silks	Small load (4.4 lb)	Pullovers, cardigans, socks, leggings										
Dress Shirts	Small load (4.4 lb)	Shirts, blouses						X				
Express	Half load (8.8 lb)	Resilient garments (such as those suitable for the Normal program)	X	X	X	X	X					
Denims	Kleine Beladung (6.6 lb)	Pants, jackets, skirts, shirts						X				
Outdoor	Small load (5.5 lb)	Outdoor clothing								always activated		
Proofing	Full load (17.6 lb)	Microfiber fabrics, skiwear, outdoor wear, fine, close weave cotton garments (poplin), tablecloths										
Bed Linens	Half load (8.8 lb)	Bed linen		X								
Time Dry	Full load (17.6 lb)	Thick jackets, pillows, sleeping bags, blankets							X			

Garment care label symbols

- Drying**
- ☐ Normal/higher temperature
  - ☐ Reduced temperature: Select Gentle (for delicate textiles)
  - ☐ Do not tumble dry
- Ironing**
- ☐ Very hot
  - ☐ Hot
  - ☐ Warm
  - ☐ Do not iron

Tips on drying

- Always observe the maximum recommended load for each program (see Program guide).
- Overloading can cause unnecessary wear and tear to the laundry, give a disappointing drying result and cause more creasing.
- Do not load the drum with items that are still soaking wet. Make sure your laundry is spun at the maximum spin speed before drying.
- Minimum iron fabric tends to crease more, the larger the load. This is particularly the case for garments made from very fine weave fabric, such as dress shirts or blouses.

X = yes, - = no

Cleaning and care

Lint filters

Removing visible lint

Clean both lint filters in the door opening after every drying cycle.

Remove the fragrance flacon (if fitted).

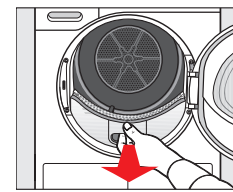

- Pull the upper lint filter forward to remove it.

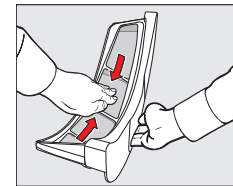

- Use your fingers or a vacuum cleaner to remove the lint from the surface of the filter.

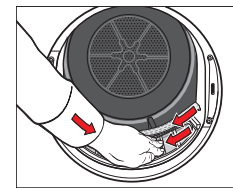

- Push the upper lint filter back into position until it clicks.
- Close the door.

Cleaning the lint filters and air flow openings thoroughly

If the drying duration has become longer or the surface of the filters is visibly compacted with lint, you should carry out the following cleaning procedure.

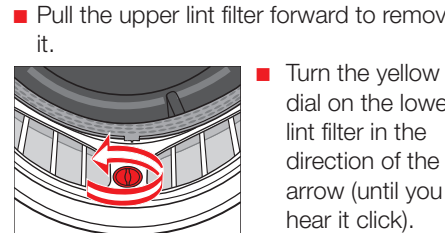

- Pull the upper lint filter forward to remove it.

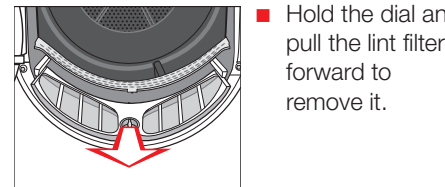

- Turn the yellow dial on the lower lint filter in the direction of the arrow (until you hear it click).

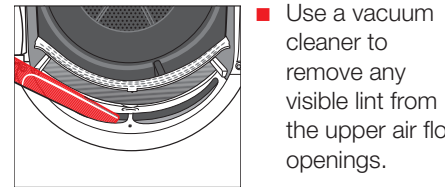

- Hold the dial and pull the lint filter forward to remove it.

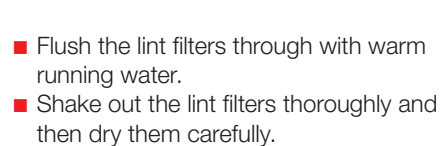

- Use a vacuum cleaner to remove any visible lint from the upper air flow openings.

- Flush the lint filters through with warm running water.
- Shake out the lint filters thoroughly and then dry them carefully.

Ensure the filters are dry before replacing them.

- Refit all of the lint filters and close the door.

Plinth filter

Only clean the plinth filter whenever the indicator light comes on.

To turn the message off: Open and close the door while the dryer is switched on.

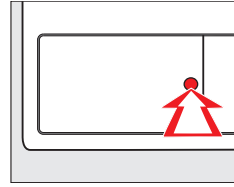

- Press the round, indented area on the heat exchanger access panel to open it. The access panel will spring open.
- Pull the plinth filter out by the handle.

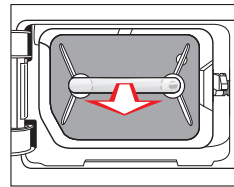

A guide pin in the dryer will come out which prevents the access panel from closing without the plinth filter.

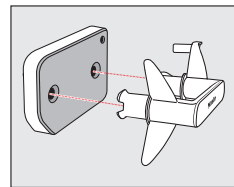

- Pull the handle out of the plinth filter.
- Clean the filter thoroughly under running water.

- Squeeze the water out of the plinth filter thoroughly.

The plinth filter must not be replaced dripping wet.

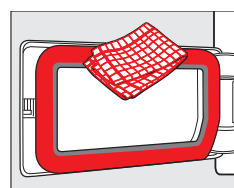

- Use a damp cloth to remove any lint.

Checking the heat exchanger unit

Danger of injury! Do not touch the cooling fins with your hands. You could cut yourself.

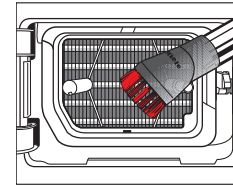

- Carefully vacuum up any visible fluff or dirt.

Refitting the plinth filter

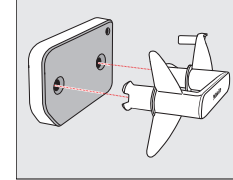

- Fit the filter back on the handle. Make sure it is the correct way round.

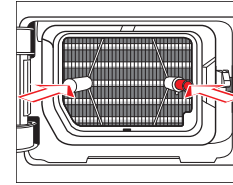

- First insert the handle with the plinth filter attached over the two guide pins.

The word Miele on the handle must be the correct way up.

- Close the heat exchanger access panel.

Frequently asked questions

Problem/Fault message	Possible cause and solution
<b>The indicator light comes on after a program has been cancelled and a signal sounds.</b>	The condensed water container is full or there is a kink in the drain hose. <ul style="list-style-type: none"><li>Empty out the condensed water container.</li><li>Check the drain hose.</li></ul> To switch off the message: <ul style="list-style-type: none"><li>Open and close the door while the dryer is switched on.</li></ul>
<b>The indicator light comes on at the end of the program.</b>	The condensed water container is full or there is a kink in the drain hose. <ul style="list-style-type: none"><li>Empty the condensed water container.</li><li>Check the drain hose.</li></ul> To switch off the message: <ul style="list-style-type: none"><li>Open and close the door while the dryer is switched on.</li></ul>
<b>-0- lights up.</b>	The program selector has been moved. <ul style="list-style-type: none"><li>Select the original program. The time left will appear on the display again.</li></ul>
<b>Bars flash on the display at the end of a program: L3...L3...L3...</b>	The program has finished but the laundry has not yet cooled down. <ul style="list-style-type: none"><li>Either remove the laundry and spread it out to cool down or leave it in the tumble dryer to cool down during the cooling phase.</li></ul>
<b>... flashes/lights up after the tumble dryer is switched on and a program cannot be selected.</b>	Access via a code has been activated. <ul style="list-style-type: none"><li>See "Programmable functions", "P07 Code" in the Operating Instructions.</li></ul>
<b>Only the Start/Stop sensor button is flashing.</b>	This is not a fault, but a normal function. <ul style="list-style-type: none"><li>Touch a sensor button to switch on the indicators. See "Programmable functions", "P11 Display switch-off status" in the Operating Instructions.</li></ul>

Problem/Fault message	Possible cause and solution
<b>The tumble dryer is switched off at the end of the program.</b>	The dryer switches off automatically to save energy. This is not a fault, but a normal function.
<b>The laundry is not sufficiently dry.</b>	The load consisted of different types of fabric. <ul style="list-style-type: none"><li>Finish drying using the Time Dry program.</li><li>Select a more suitable program next time.</li></ul> Useful tip: You can alter the drying levels for some programs. See "Programmable functions", sections "P01 Drying levels Normal" and "P02 Drying levels Wrinkle-free" in the Operating Instructions..
<b>Items made of synthetic fibers are charged with static electricity after drying</b>	Synthetic fibers tend to attract static charge. Static charge can be reduced by adding a fabric softener to the final rinse in the washing program.
<b>There is a build-up of lint</b>	Lint is principally the result of friction when garments are being worn and to some extent when they are being washed. Machine drying hardly causes any lint to form. Lint is collected by the <b>lint</b> and plinth filter and can be removed easily. See "Cleaning and care".
<b>You can hear operating noises (buzzing/humming)</b>	This is not a fault. The compressor (heat pump) is operating or you have selected the <i>SoftSteam</i> program. No action required. These noises are quite normal and can be heard when the compressor or the condensed water pump is operating.

Quick Start Guide Heat-pump dryer



These short instructions are not a substitute for the operating instructions supplied with the appliance! It is essential to familiarize yourself with the dryer before using it for the first time. Take note of the operating instructions, as well as the "IMPORTANT SAFETY INSTRUCTIONS".