

ASSEMBLY INSTRUCTIONS

TOOLS REQUIRED

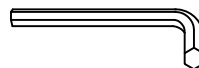

Allen Wrench

(Included)



Phillips Screwdriver

(Not Included)



**2 - People
Recommended**

ASSEMBLY RATING



EASY —————> DIFFICULT

The Assembly Rating is a 5-point system showing the level of effort needed to assemble a specific product.

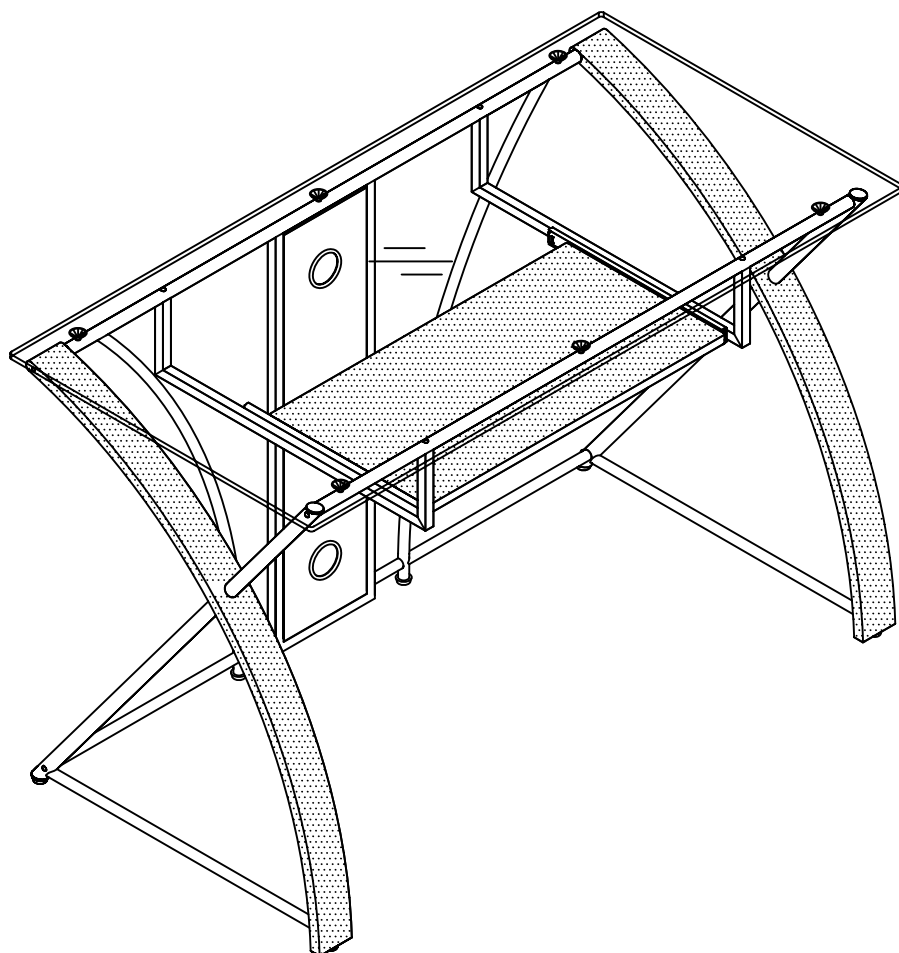



FOA Intro

Thank you for your purchase!

We hope you enjoy this new addition to your home for many years to come.

Our commitment to providing quality products does not simply end when you purchase our product. We fully stand behind our products from start to finish. Our customer service department is available Monday – Friday 8:30 AM – 5:30 PM Pacific Time and can help with assembly questions as well as, if necessary, replacing damaged or missing parts. To help expedite our service, please have these assembly instructions readily available, along with your order receipt.



Consumer Hotline
Toll-Free 1-888-980-5122



WEBSITE
www.foagroup.com



Monday to Friday
8:30AM- 5:30PM (PT)



E-MAIL
cs.ec@foagroup.com



foagroup



FurnitureOfAmerica



CHECK BEFORE STARTING

☐

Are you missing anything?

Double-check all parts, hardware and accessories listed are all accounted for.

☐

Check out our Quick Tips!

We recommend reviewing the pre-assembly handouts. Even experts need a refresher now and then!

☐

Should we send any replacements?

Are there any irregularities or flaws in the parts? We can send replacements!

☐

Prep Time!

Please review the assembly instructions and all diagrams prior to assembling.

PRE ASSEMBLY INTRODUCTION

We understand building ready-to-assemble furniture can be a challenging experience for some. To help avoid confusion, we have provided some helpful tips that may speed up the process.

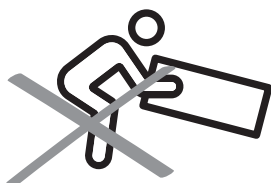

Teamwork

ALWAYS have at least two people to help with transporting and assembling the product to avoid potential injury and/or damage.

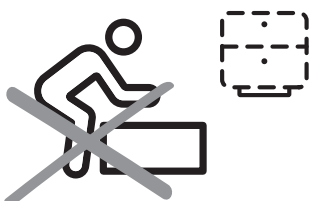

Suitable Location

Assembling near the area of the intended location is highly recommended.



Sufficient Space

Make sure you have enough space to move around during the assembly.

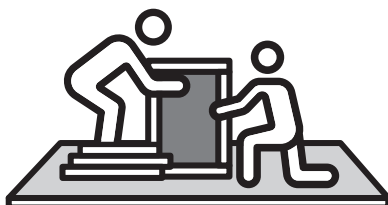

Avoid Scratches

Use cardboard, blankets or a carpeted area while assembling furniture to prevent to prevent scratches and damages.

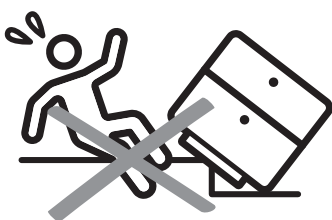

Flat Surface

Make sure the furniture rests on a flat and level surface with each leg evenly touching the floor.

ASSEMBLY AND CARE ADVICE



**FAILURE TO FOLLOW THE GUIDELINES BELOW MAY
RESULT IN INJURY AND/OR PROPERTY DAMAGE.**



Position each part correctly
and insert screws or bolts into
their respective holes.

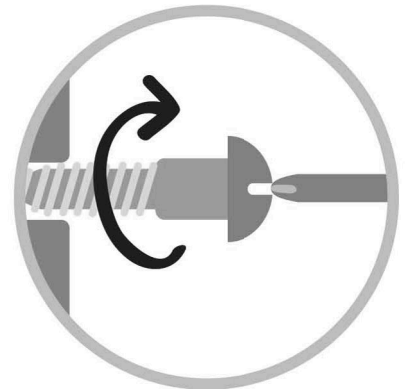

Turn clockwise to tighten and
only tighten when step is
completed or when instructed
to do so.



Use the appropriate hand tools
or power tools for assembly.
Select steps, such as tightening
screws and/or bolts, may require
hand tools to avoid causing
damage during assembly.



Save the instructions and store
any supplied tools for later
maintenance.

After two weeks, check and
tighten any loose hardware and
repeat again every six months
thereafter.

IT IS THE USER'S RESPONSIBILITY TO MAINTAIN THE FURNITURE. THE HARDWARE MAY LOOSEN OVER TIME AND MAY CAUSE THE FURNITURE TO BE WOBBLY AND UNABLE TO SUPPORT ITS INTENDED WEIGHT CAPACITY. THIS MAY LEAD TO COLLAPSE AND MAY CAUSE SERIOUS INJURY.

COMPUTER DESK WITH WOOD BOARD KEYBOARD

CM-DK6216

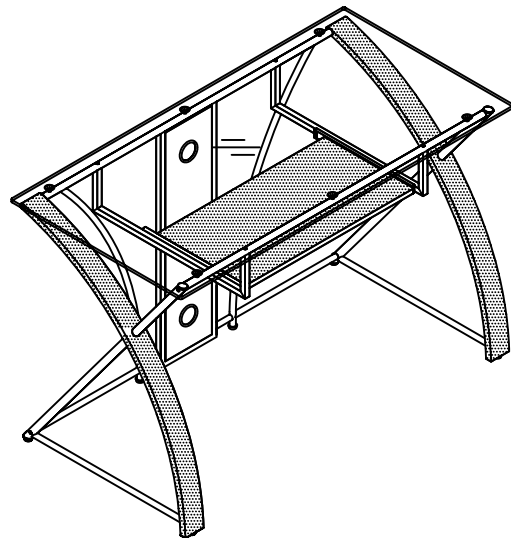
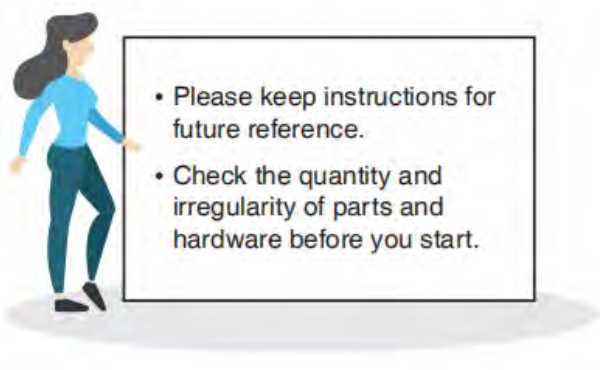

PARTS

#1 1pc

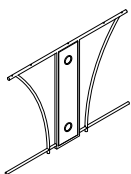

Back Panel

#2 2pcs

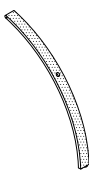

Arc Panel

#3 2pcs

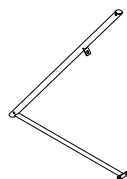

Side Panel

#4 1pc

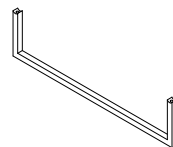

Left Frame for Keyboard

#5 1pc

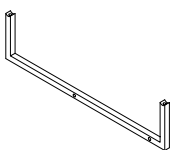

Right Frame for Keyboard

#6 1pc

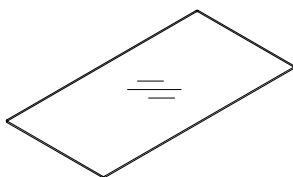
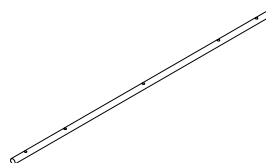

Table Top Glass

#7 1pc



Top Cross Bar

#8 1pc

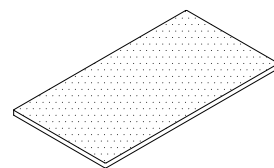

Wood Shelf

#9 1pc

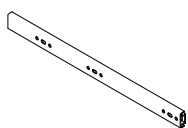

Left Slide

#10 1pc

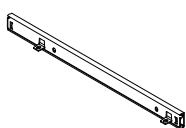

Right Slide

HARDWARE

#A 6pcs

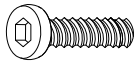

Bolt $\phi 1/4$ "x $5/8$ "
(White)

#B 4pcs

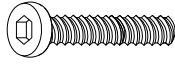

Bolt $\phi 1/4$ "x $1-1/2$ "
(White)

#C 4pcs



Bolt $\phi 1/4$ "x $1-1/2$ "
(White)

#D 2pcs

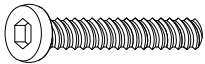

Bolt $\phi 1/4$ "x $3-1/4$ "
(White)

#E 8pcs



Bolt $\phi 3/16$ "x $1/2$ "
(White)

#F 4pcs



Screw M4 x13mm
(White)

#G 8pcs



Flat Washer $\phi 1/4$ "
(White)

#H 6pcs



Suction Cup

#I 4pcs



Leveler $1/4$ "

#J 1pc

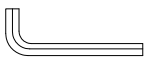

Allen Wrench
4x22x60mm
(White)

ASSEMBLY INSTRUCTIONS

1

ASSEMBLY

Do not fully tighten all bolts until assembly is complete. This will help all parts to assemble properly.

Part #3 x2pcs

Hardware #I x2pcs

Align leveler (#I) to the bottom hole of the side panel (#3).

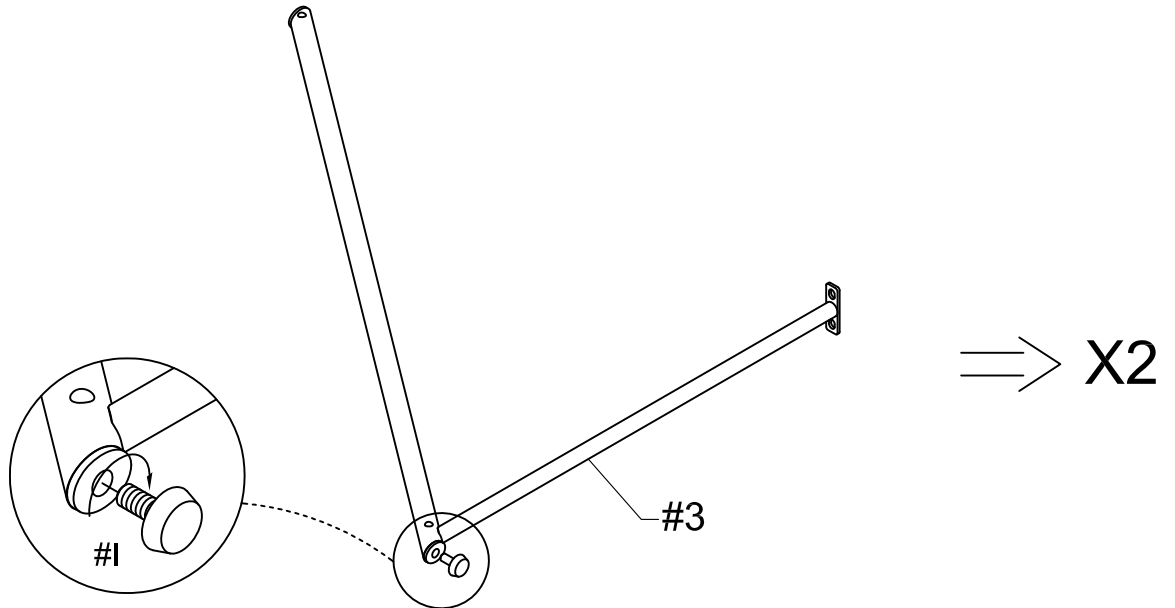

2

Part #2 x2pcs

Hardware #A x6pcs

Hardware #G x6pcs

Hardware #J x1pc

Align arc panel (#2) to side panel (#3), then secure by using bolt (#A) with washer (#G).

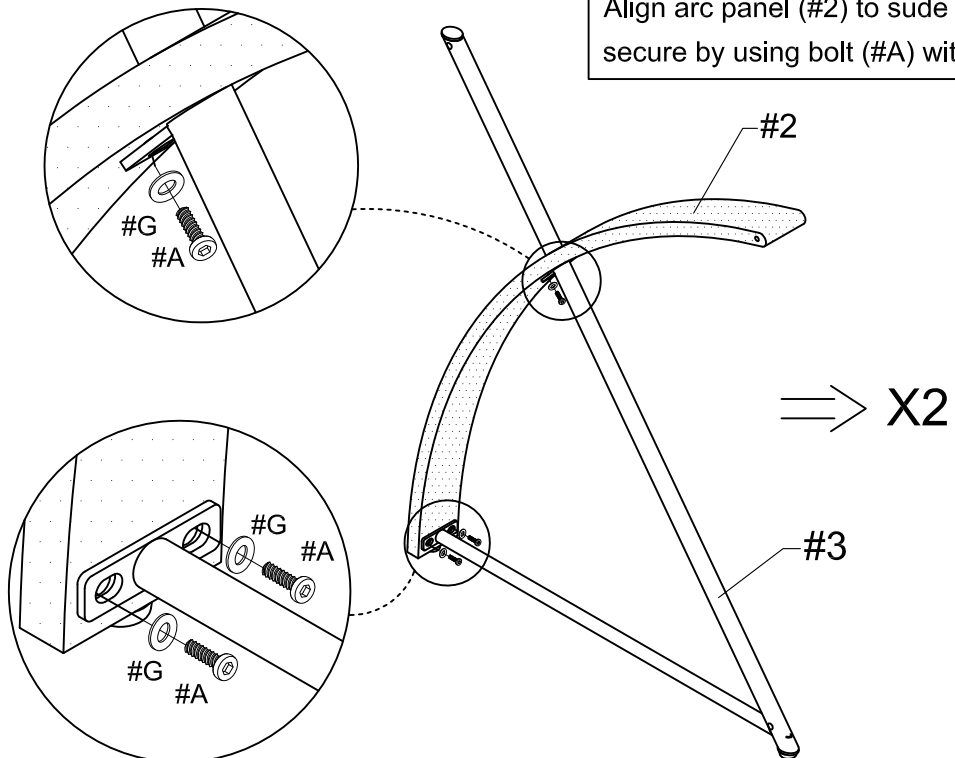

ASSEMBLY INSTRUCTIONS

3

Part #1 x1pc

Hardware #I x2pcs

Align leveler (#I) to the bottom hole of the back panel (#1).

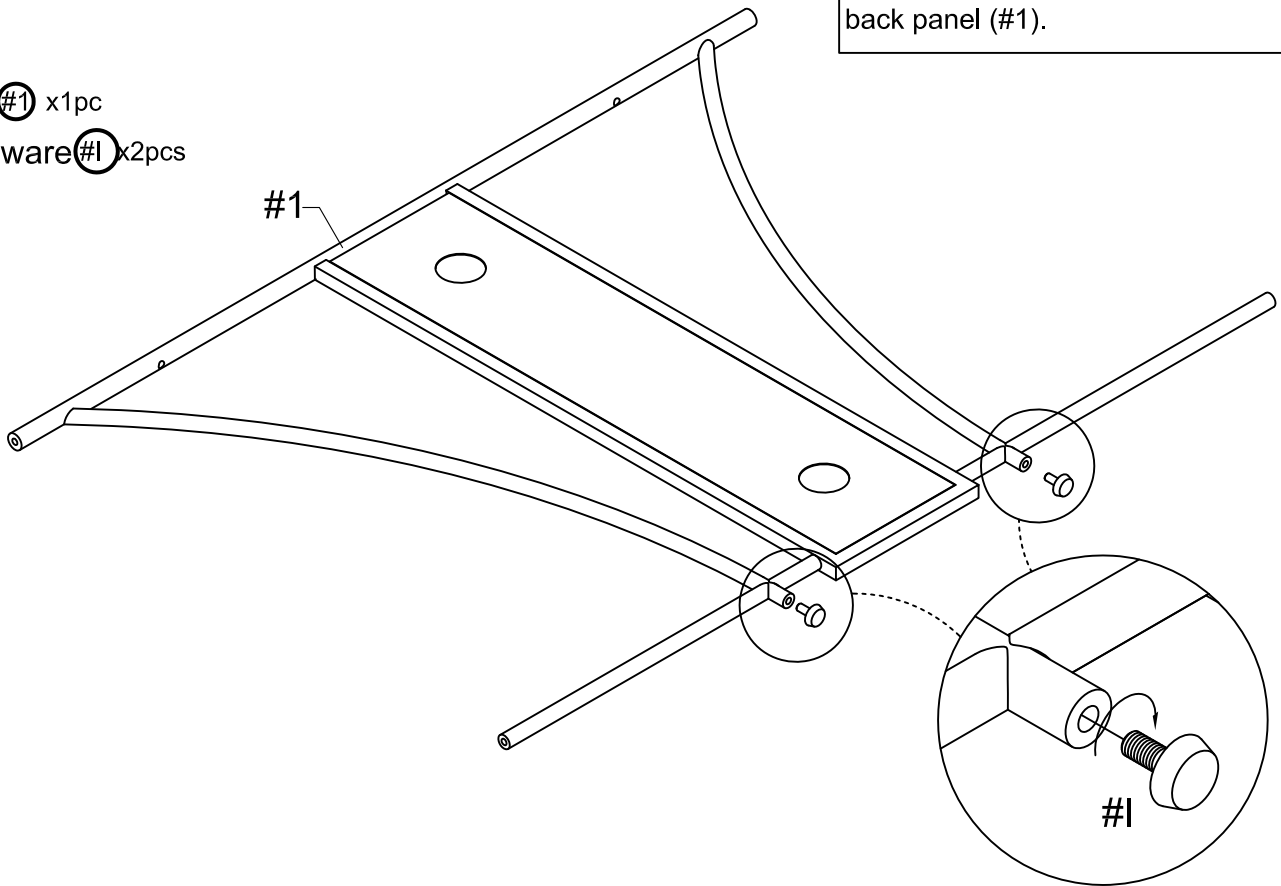

4

Part #7 x1pc

Hardware #B x4pcs

Hardware #D x2pcs

Hardware #G x2pcs

Hardware #J x1pc

Align back panel (#1), top cross bar (#7) to side panel (#3) and arc panel (#2), then secure by using bolt (#A, #D) with washer (#G).

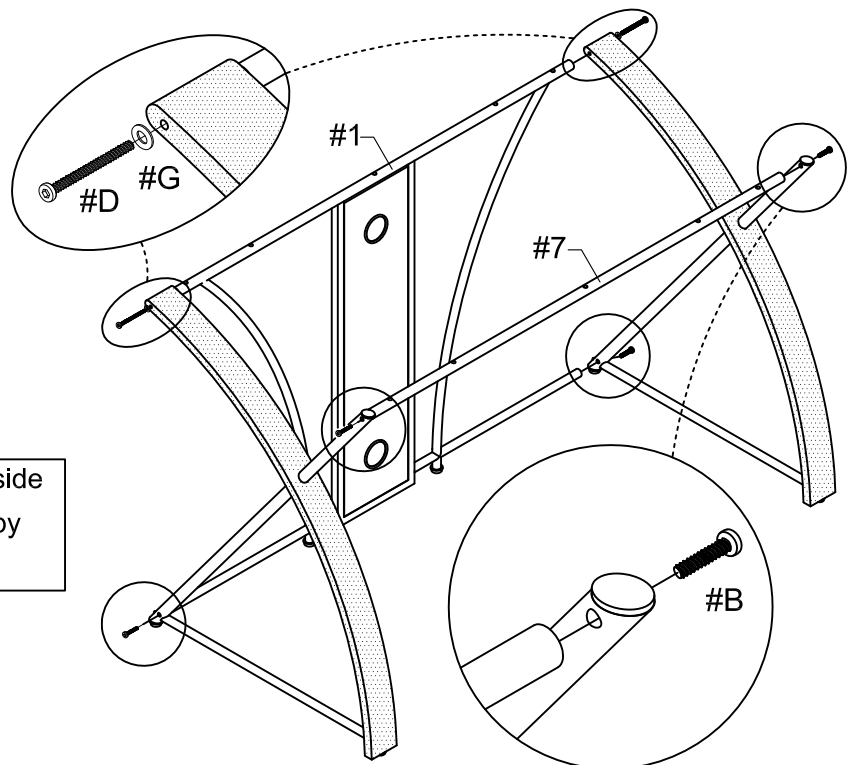

ASSEMBLY INSTRUCTIONS

5

Part **#4** x1pc

Part **#5** x1pc

Hardware **#C** x4pcs

Hardware **#J** x1pc

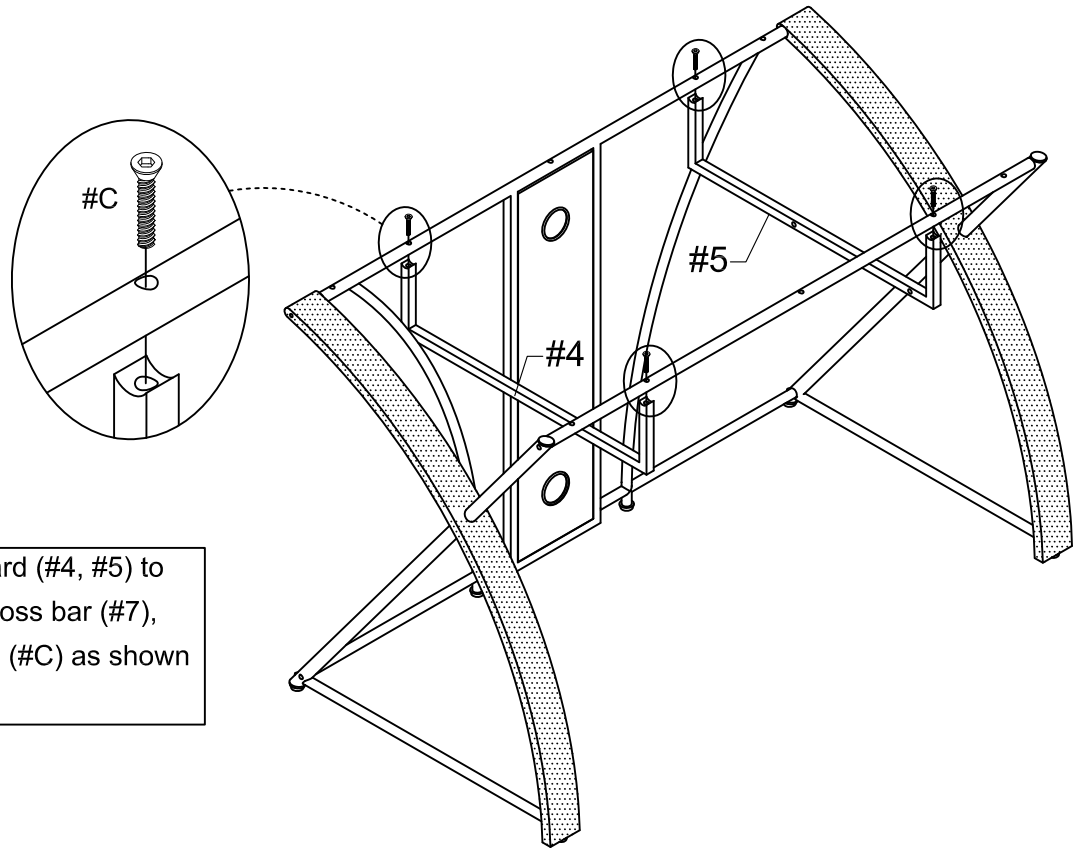

Align the frame for keyboard (#4, #5) to back panel (#1) and top cross bar (#7), then secure by using bolts (#C) as shown in the diagram.

6

Part **#9** x1pc

Part **#10** x1pc

Hardware **#E** x4pcs

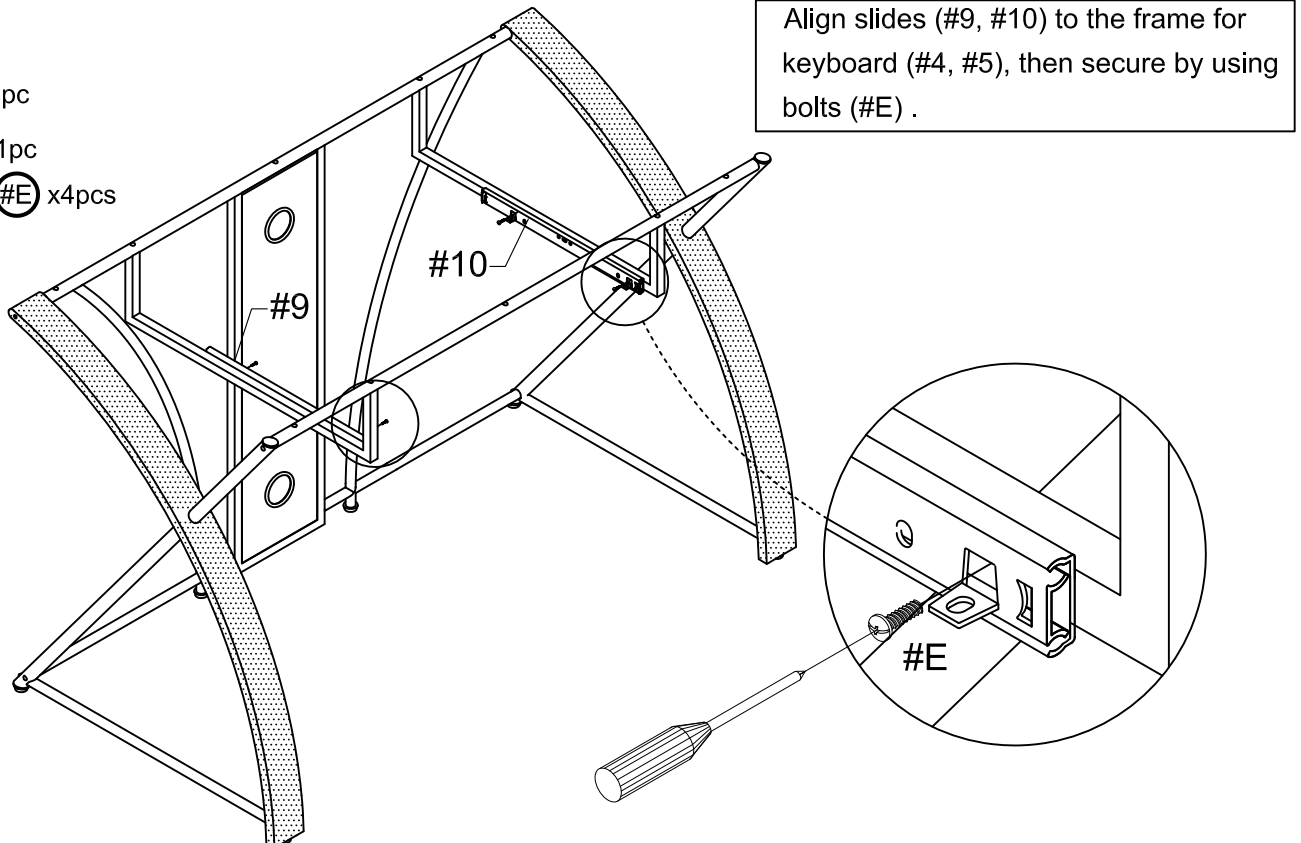

Align slides (#9, #10) to the frame for keyboard (#4, #5), then secure by using bolts (#E) .

ASSEMBLY INSTRUCTIONS

7

Part **#8** x1pc

Hardware **#F** x4pcs

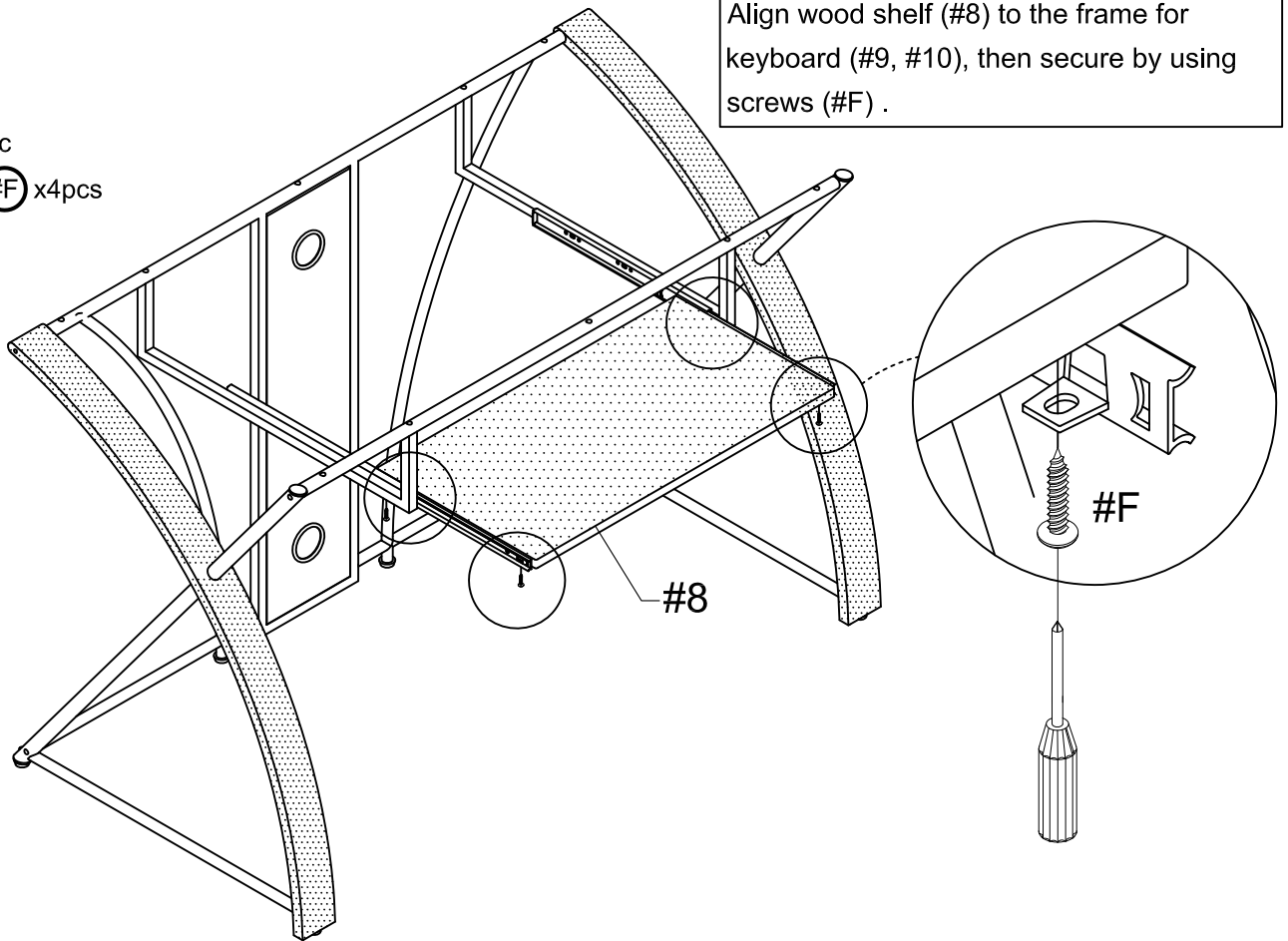

8

Part **#6** x1pc

Hardware **#H** x6pcs

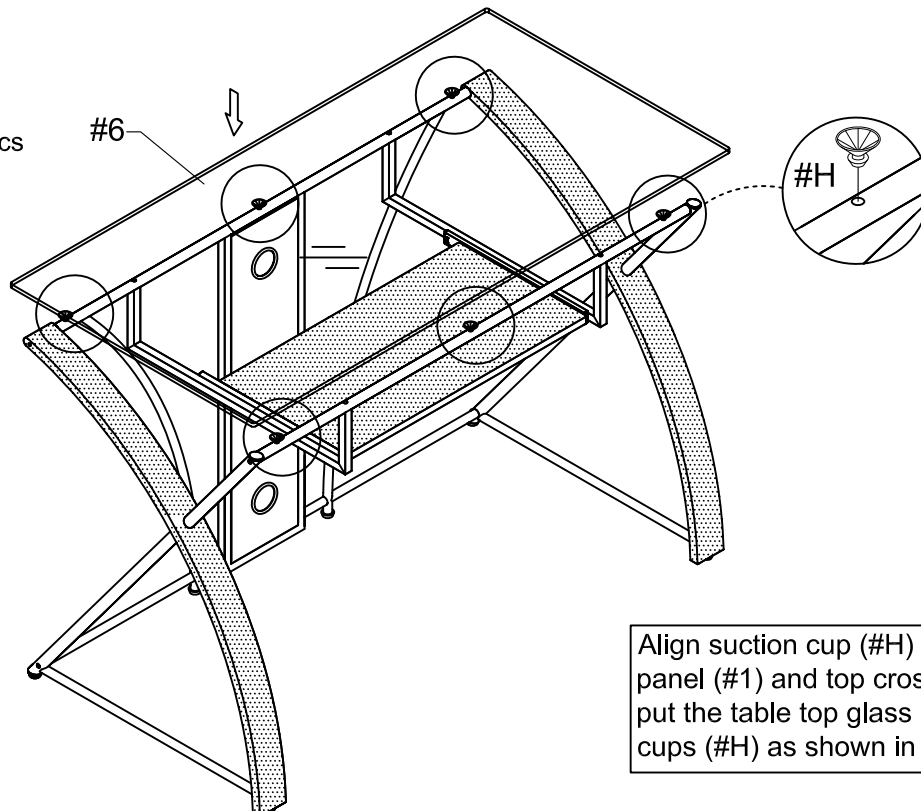

Align suction cup (#H) to the top of back panel (#1) and top cross bar (#7), then put the table top glass (#6) on suction cups (#H) as shown in the diagram.

ASSEMBLY INSTRUCTIONS

9

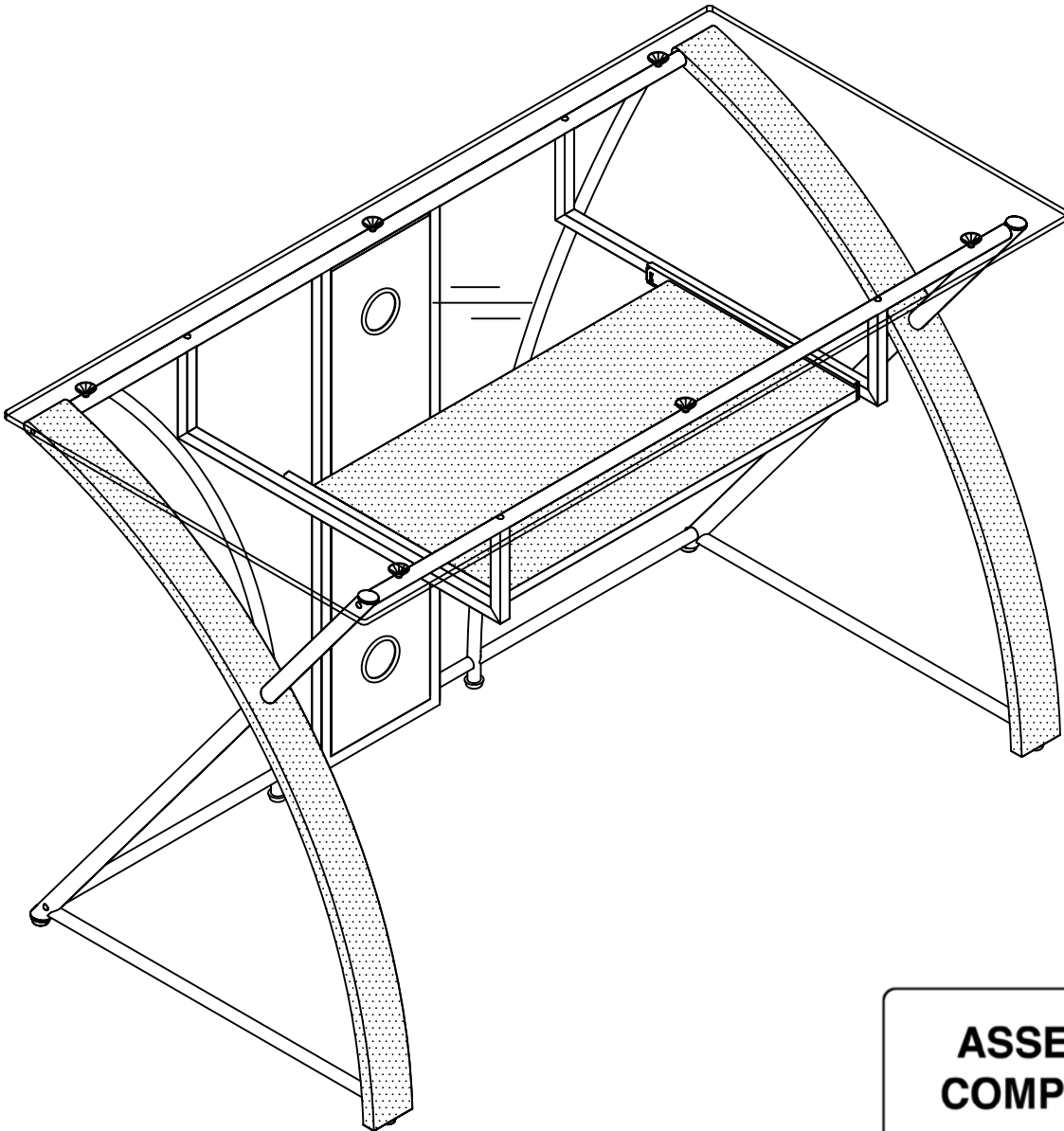

ASSEMBLY COMPLETED



Please ensure the furniture rests on an even and flat surface. If the product wobbles or feels loose, double-check all bolts and/or screws are properly tightened and secured.



Keep this handy!

Please retain this instruction manual and any order-related information for future reference.



Lift, don't drag!

To avoid damage to product please always LIFT the product when transporting or adjusting the placement.