



# Kitchenaid® 1-Horsepower Batch Feed Food Waste Disposer

KBDS100T

Available Finishes/Colours

	KBDS100T Red
---	-----------------

Dimensions		Features	
Height	16.0	Dishwasher Connection	Yes
Width	9.0	Quick Mounting System	Yes

Electrical		Specifications	
Amps	15	Country Of Origin	USA
Volts	120	Extended Service Plan Parent	EW02IW2Y, EW02IW4Y, EW02IW1Y

Details		Product To Product Pairs	
Motor Horsepower	1 HP		
Drain Chamber	Cast Aluminum		

Grinding Chamber Material	Stainless
Grinding Wheel	MultiGrind Plus
Jam Release	Anti-Jam Circuit
Shredder Ring	Stainless Steel
Starting Method	Electronic

A 1 HP motor allows this batch feed disposer to power through your toughest disposing challenges. The three-stage grinding technology combines with premium sound reduction features to help you quietly and efficiently reduce waste volume.

Top Features

1725 RPMs

Batch Feed

MultiGrind Plus™ Technology

Manuals & Literature:

-  [Dimension Guide](#)
-  [Installation Guide](#)
-  [Owner Manual](#)
-  [Warranty Information](#)

# KitchenAid® Food Waste Disposer

## PRODUCT MODEL NUMBER

KCDB250G      KCDS100T  
KCDI075V      KBDS100T  
KCDS075T

**Electrical:** This disposer is intended to be direct-wired to the electrical supply. If a junction box is used, connect the junction box to the switch on a separate 15- or 20-amp 115 Volt circuit with the appropriate cable. (Use 14 gauge wire with 15-amp circuit, and 12 gauge wire with 20-amp circuit.) This disposer requires a switch marked "Off" position (wired to disconnect all ungrounded supply conductors) installed within sight of the disposer sink opening. (1 hp minimum rating.)

## OVERALL DIMENSIONS

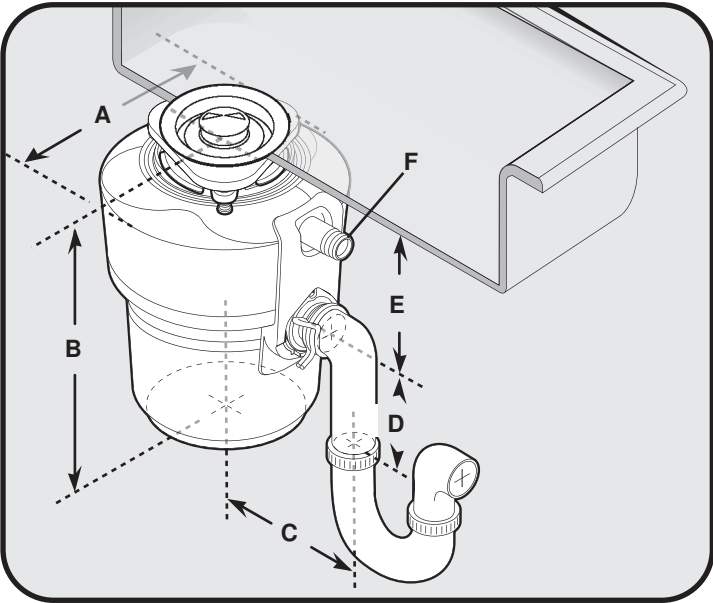

	KCDB250G	KCDI075V	KCDS075T	KCDS100T	KBDS100T
A	6 5/16" (16.0 cm)	8 1/2" (21.6 cm)	9" (22.9 cm)	9" (22.9 cm)	9" (22.9 cm)
B	11 3/8" (28.9 cm)	12 3/4" (30.5 cm)	12 3/4" (30.5 cm)	12 3/4" (30.5 cm)	15 1/2" (39.4 cm)
C	5 3/4" (14.6 cm)	5 3/4" (14.6 cm)	5 3/4" (14.6 cm)	5 3/4" (14.6 cm)	5 3/4" (14.6 cm)
D	4" (10.2 cm)	4" (10.2 cm)	4" (10.2 cm)	4" (10.2 cm)	4" (10.2 cm)
E	6" (15.2 cm)	6 11/16" (17 cm)	6 11/16" (17 cm)	6 11/16" (17 cm)	9 7/16" (24 cm)
F	Dishwasher Drain Connection				

Installations on thicker sinks (such as solid surface, porcelain, or cast iron) may require the use of alternate parts. See instructions below for installation with various thicknesses:

FIGURE A: Thin Sink  
All Models  
( $< \frac{3}{8}$ " )

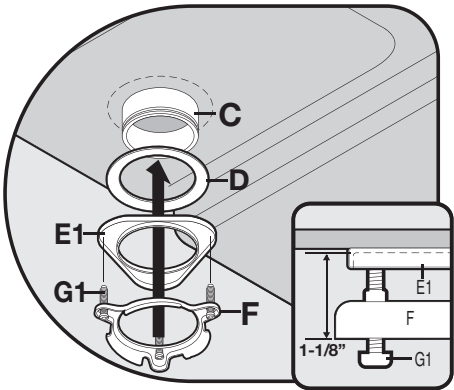

For thin sinks insert fiber gasket (D), backup flange (E1) and mounting ring (F). Hold in place while inserting the snap ring.

C = Standard Sink Flange  
G1 = 1 1/2" screws  
G2 = 1 1/8" screws

FIGURE B: Thick Sink  
All Models  
( $> \frac{3}{8}$ " )

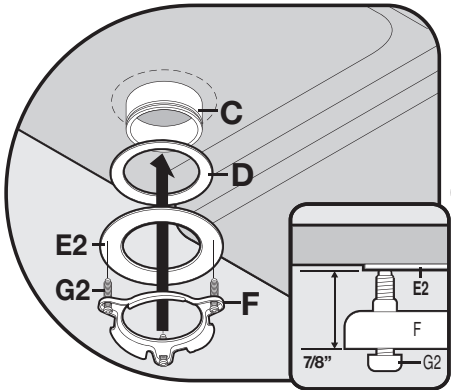

For thick sinks insert fiber gasket (D), backup flange (E2) and mounting ring (F). Hold in place while inserting the snap ring.

FIGURE C: Extra Thick Sink  
For Model KBDS100T Only  
( $> \frac{3}{4}$ " )

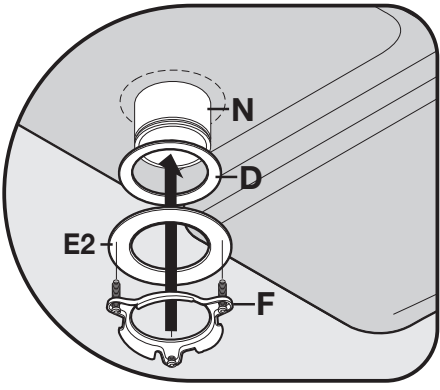

For extra thick sinks use extended sink flange (N), to order in US call 1-800-422-1230, in Canada call 1-800-6777. Insert fiber gasket (D), backup flange (E2) and mounting ring (F). Hold in place while inserting the snap ring.