

....

.....DF9D'H56 @'

---

PNC      MODEL

738G GWA SÔPT VĪ €€€

<b>Pag.</b>	<b>Indice</b>	<b>Index</b>
2	Disegni	Drawings
3	Lista ricambi	Spare parts list

**Brand / Marchio:** KELVINATOR

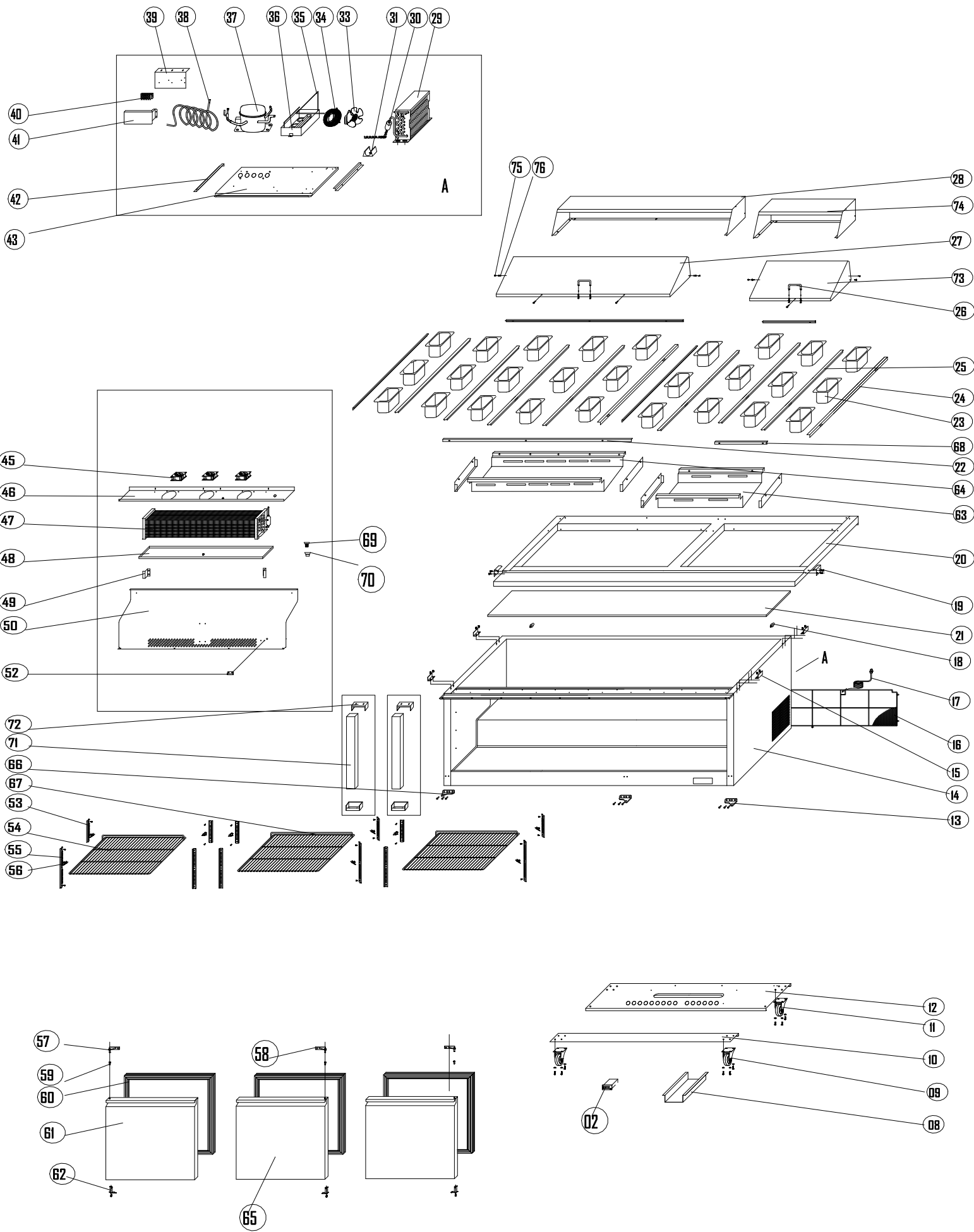

EXPLODE OF KCHMT72.30

## SPARE PARTS LIST OF KCHMT70.30

NO.	ELECTROLUX PNC	NAME	ERP	QUY.	MATERIAL	REMARK
2	0USF42	THERMOSTAT CONTROLLER	104020039	1PC		D20-001M
	0USC4C	Inner Chest Temperature Sensor Probe	XR20C-TempSensorProbe-738263	1PC		BLACK
8	0USK07	CABLE COVER	5202003668	1PC		
9	0USF03	BRAKE WHEEL	107050008	2PCS		
10	0USJ63	FRONT SUPPORT OF UNIT BOARD	5201006393	1PC		
11	0USH63	NORMAL WHEEL	107050007	2PCS		
	0USK99	Castor Mounting Bolt	107210131	16PCS	Galvanized STEEL	Hexagon Head
	0USL00	Castor Mounting Locking Washer	107210244	16PCS	Galvanized STEEL	
	0USL01	Castor Mounting Flat Washer	107210224	16PCS	Galvanized STEEL	
12	0USJ64	BACK SUPPORT OF UNIT BOARD	5201006394	1PC		
13	0USF81	RIGHT DOWN HINGE	114020122	2PCS		
14		BODY	5102003100	1PC		
15	0USL80	TOP CLIP	5201007056	4PCS		
16	0USI15	UNIT ROOM COVER	109040076	1PC		
17	0USH67	PLUG	104050013	1PC		
18	0USH46	LOCATION KNOB	114010039	2PCS	RUBBER	
19	0USG68	FIXED CLIP OF CUTTING BOARD	5202003562	2PCS		
20	0USN42	TOP	5108000369	1PC		
21	0USN43	CUTTING BOARD	106120020	1PC		
22	0USN44	PAN SUPPORT /FRONT/BACK(LEFT SIDE)	5203000302	2PCS		
23		STANDARD PAN	106070007	27PCS		
24	0USJ32	PAN SUPPORT /LEFT/RIGHT	5203000184	4PCS		
25	0USJ31	PAN SUPPORT	5203000183	7PCS		
26	0USH09	HANDLE OF COVER	107210314	2PCS	STAINLESS	
27	0USN45	LEFT MOVING COVER	5202003635	1PC		
	0USL33	LEFT MOVING COVER LINER	5202006451	1PC		
28	0USN46	LEFT FIXED COVER	5202003633	1PC		
	0USL34	LEFT FIXED COVER LINER	5202006450	1PC		
29	0USF34	CONDENSER	113010368	1PC		
30	0USG66	FILTER DRIER	107180004	1PC		
31	0USI78	DRIER SUPPORT	108300116	1PC		
33	0USF40	CONDENSER FAN	104030019	1PC		
	0USC4J	CONDENSER FAN BLADE	104040001	1PC		
34	0USI46	BASKET GUARD GRILLS	109030031	1PC	COATED STEEL	
35	0USG14	EVAPORATE PIPE	113110265	1PC	COPPER	
36	0USI29	WATER BOX	108140003	1PC	PLASTIC	
37	0USF28	COMPRESSOR	104010249	1PC		
38	0USN47	SUCTION PIPE	113100682	1PC	COPPER	
39	0USDEE	CONNECTOR SUPPORT	5202004245	1PC		
40	0USF09	CABLE CONNECTOR	104110005	1PC		
41	0USJ98	CONNECTOR COVER	5202003545	1PC	ZINC	
42	0USK50	GUIDE OF UNIT BOARD/LEFT	5203000284	1PC		
	0USK49	GUIDE OF UNIT BOARD/RIGHT	5203000283	1PC		
43	0USK32	UNIT BOARD	5202004723	1PC		
45	0USF14	CIRCLE FAN	104030041	3PCS		
46	0USL37	CIRCLE FAN SUPPORT	5202003714	1PC		
47	0USN48	EVAPORATOR	5112000502	1PC		
	0USC6R	Evaporator Temperature Sensor Probe	XR20C-TempSensorProbe-738264	1PC		WHITE
48	0USL40	EVAPORATOR WATER PAN	5202003716	1PC		
49	0USK05	FIXED SUPPORT OF EVAPORATOR COVER	5202003659	2PCS	STAINLESS	
50	0USL35	EVAPORATOR COVER	5202006449	1PC		
52	0USM10	SENSOR FIXED CLIP	108110315	1PC	PLASTIC	GRAY
53	0USI66	SHELF SUPPORT B	107100019	6PCS	STAINLESS	
54	0USC0M	SHELF	109020220	2PCS	COATED STEEL	
55	0USI44	SHELF SUPPORT A	107100018	6PCS	STAINLESS	
56	0USH19	K SHAPE CLIP	107090002	12PCS		

Nº.	ELECTROLUX PNC	NAME	ERP	QUY.	MATERIAL	REMARK
57	0USI16	UP HINGE/LEFT	114020126	1PC		
58	0USI17	UP HINGE /RIGHT	114020125	2PCS		
59	096268	BUSHING	108300029	3PCS	PLASTIC	
60	0USH00	GASKET	108270291	3PCS	PLASTIC	
61	0USM97	DOOR/LEFT	5107000944	1PC		
62	0USF83	DOOR SPRING HINGE	114030084	3PCS		
63	0USN49	CONDUCT BOARD(RIGHT SIDE)	5202006370	1PC		
	0USL14	CONDUCT BOARD SIDE PLATE	5202006371	2PCS		
64	0USN50	CONDUCT BOARD(LEFT SIDE)	5202006369	1PC		
	0USL14	CONDUCT BOARD SIDE PLATE	5202006371	2PCS		
65	0USM98	RIGHT DOOR	5107000463	2PCS		
66	0USF80	LEFT DOWN HINGE	114020121	1PC		
67	0USC0Q	MIDDLE SHELF	109020222	1PC		
68	0USN51	PAN SUPPORT /FRONT (right side)	5203000303F	1PC		
	0USDEK	PAN SUPPORT /BACK (right side)	5203000303B	1PC		
69	096263	DRAIN PIPE(B EXT)	108110136	1PC		
70	0USG04	DRAIN PIPE(A INT)	108300031	1PC		
71	0USC6K	MIDDLE GIRDER/ LEFT	5109000238P	1PC		
71	0USC6D	MIDDLE GIRDER/ RIGHT	5118000269P	1PC		
72	0USH59	MIDDLE GIRDER FIXER	108030547	4PCS		
73	0USN52	RIGHT MOVING COVER	5202003639	1PC		
	0USL38	RIGHT MOVING COVER LINER	5202006453	1PC		
74	0USN53	RIGHT FIXED COVER	5202003637	1PC		
	0USL47	RIGHT FIXED COVER LINER	5202006452	1PC		
75	0USG67	FIXED BOLT	107210320	4PCS		
76	0USG73	FIXED NUT	107070020	4PCS		
	0USM13	CAPILLARY	102050022	1PC		
	0USM14	Shelf Support Screw	108300165			

REV  
10.12.2020