

# UTTERMOST

## ASSEMBLY INSTRUCTIONS

### Assembly Instruction

### STYLE: 24198

Parts list		Hardware list	
A	GLASS TOP	1PC	SCREW ( size: M6X15MM) 16 PCS
B	GLASS SHELF	1PC	WRENCH 1PC
C	METAL BAR CART TOP FRAME	1PC	
D	METAL BAR CART SHELF FRAME	1PC	
E	METAL BAR CART LGE	4PCS	

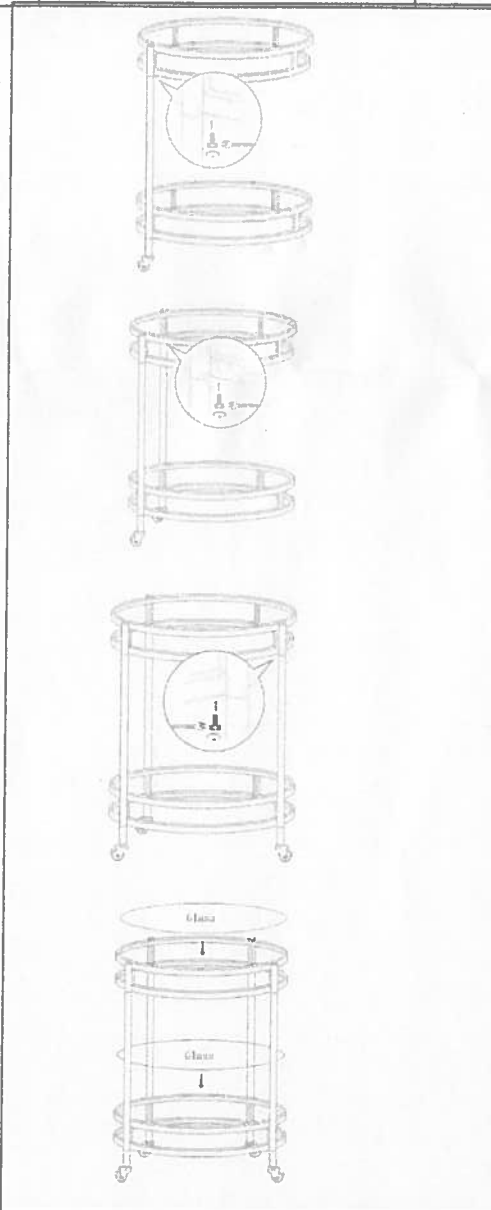

1. Take the parts carefully out of the carton, and place them on a flat surface. Make sure that the parts will not be damaged.

2. Use wrench to screw bar cart's first leg to the top frame and shelf frame.

3. Use wrench to screw bar cart's second leg to the top frame and shelf frame.

4. Use wrench to screw bar cart's third leg to the top frame and shelf frame.

5. Use wrench to screw bar cart's fourth leg to the top frame and shelf frame.

6. Place glass on top and shelf.  
To clean, wipe with soft dry cloth.