

# YMD241AS

Microwave Drawer | Built-In

**YALE**  
APPLIANCE



Are you ready for sleek, low-profile design, subtle, under-counter placement and ten power levels? This drawer-style microwave takes you to the next level of ease and convenience. Enjoy a clutter-free countertop and deluxe features like touch open and close, touch controls, stainless steel exterior, quick buttons, and more.



Standard Installation



Flush Mount Installation

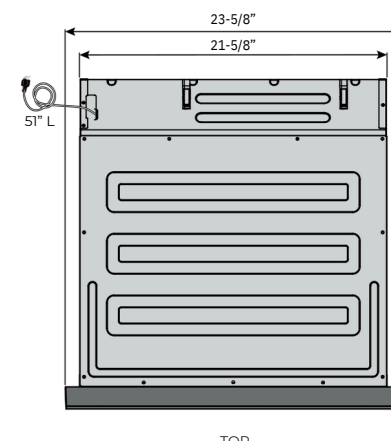
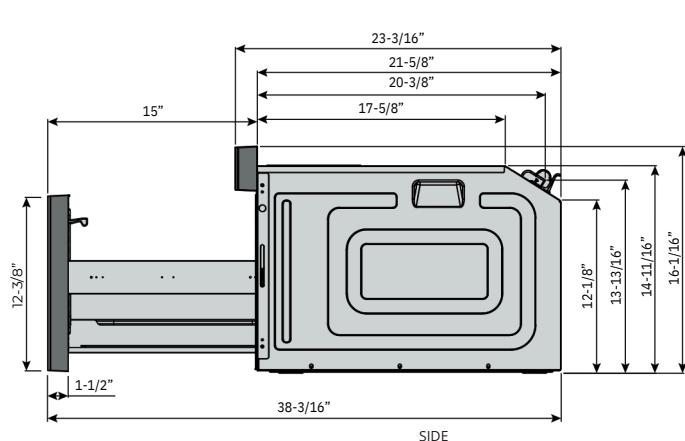

# YMD241AS

Microwave Drawer | Built-In



## SPECIFICATIONS

Size	Exterior	24"
Dimensions	Interior	23-5/8"W x 16-1/16"H x 23-3/16"D
Dimensions		17-1/4"W x 7-7/8"H x 17-1/2"D
Weight	Installation	70 lbs.
Type		Standard & Flush Mount Installation
Controls		Electronic touch with LCD
Built-in Clock		Yes
Exterior Finish		304-grade stainless steel
Interior Finish		White
Interior Lighting		Yes
Easy Clean Coating		Yes
ADA Compliant		Yes
Interior Capacity		1.2 cu/ft
Rated Output		1000W
AC Power		120v, 60hz at Max. 1.5A
Warranty		5 year parts, 5 year labor

Control Features	Touch open/close
	Mute on/off
	10 power levels
	+30 seconds button
	Controls lock
	Kitchen timer
	Popcorn
	Defrost: ground meat, steaks/ chops, poultry (no bone/in-bone), roast, casserole, soup
	Melt & soften: butter, chocolate, ice cream, marshmallow, cream cheese, sauces

CABINET CUT-OUT FOR FLUSH MOUNT INSTALLATION

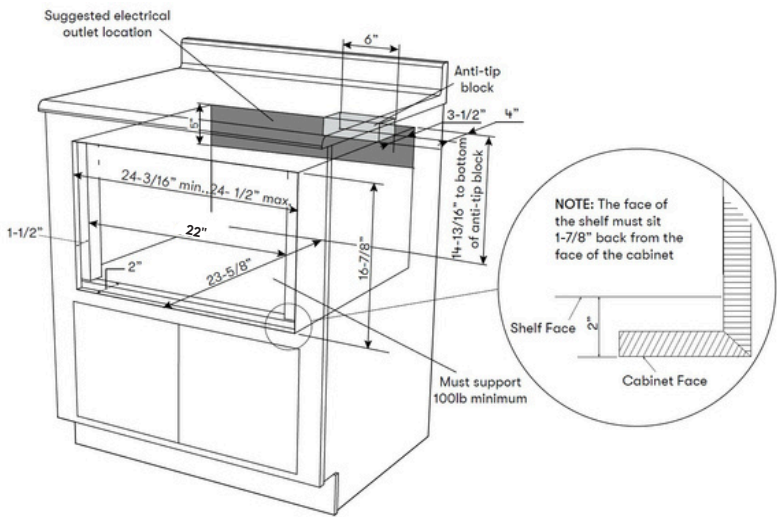

CABINET CUT-OUT FOR STANDARD INSTALLATION

