

SPEED QUEEN® MULTI-HOUSING LAUNDRY SOLUTIONS

Coin Slide Control Washers & Dryers

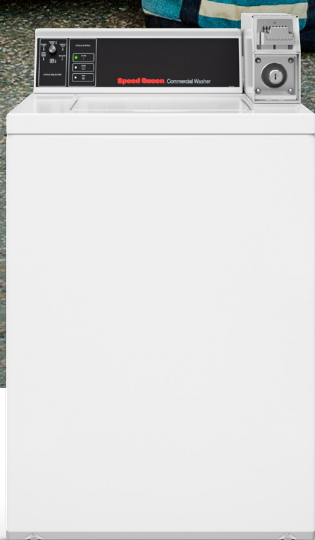

 **Speed Queen.**
The Proven Performer in Laundry

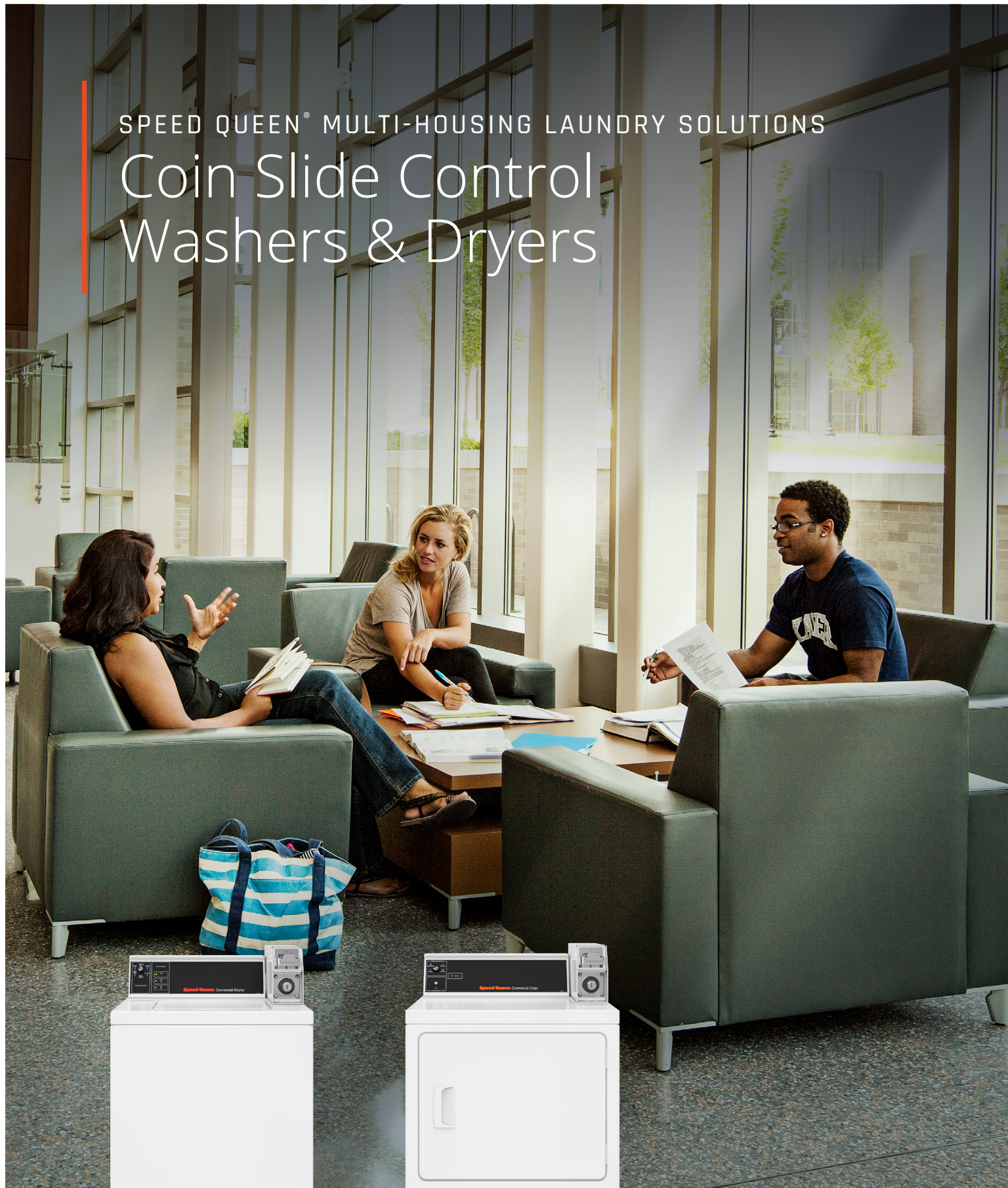
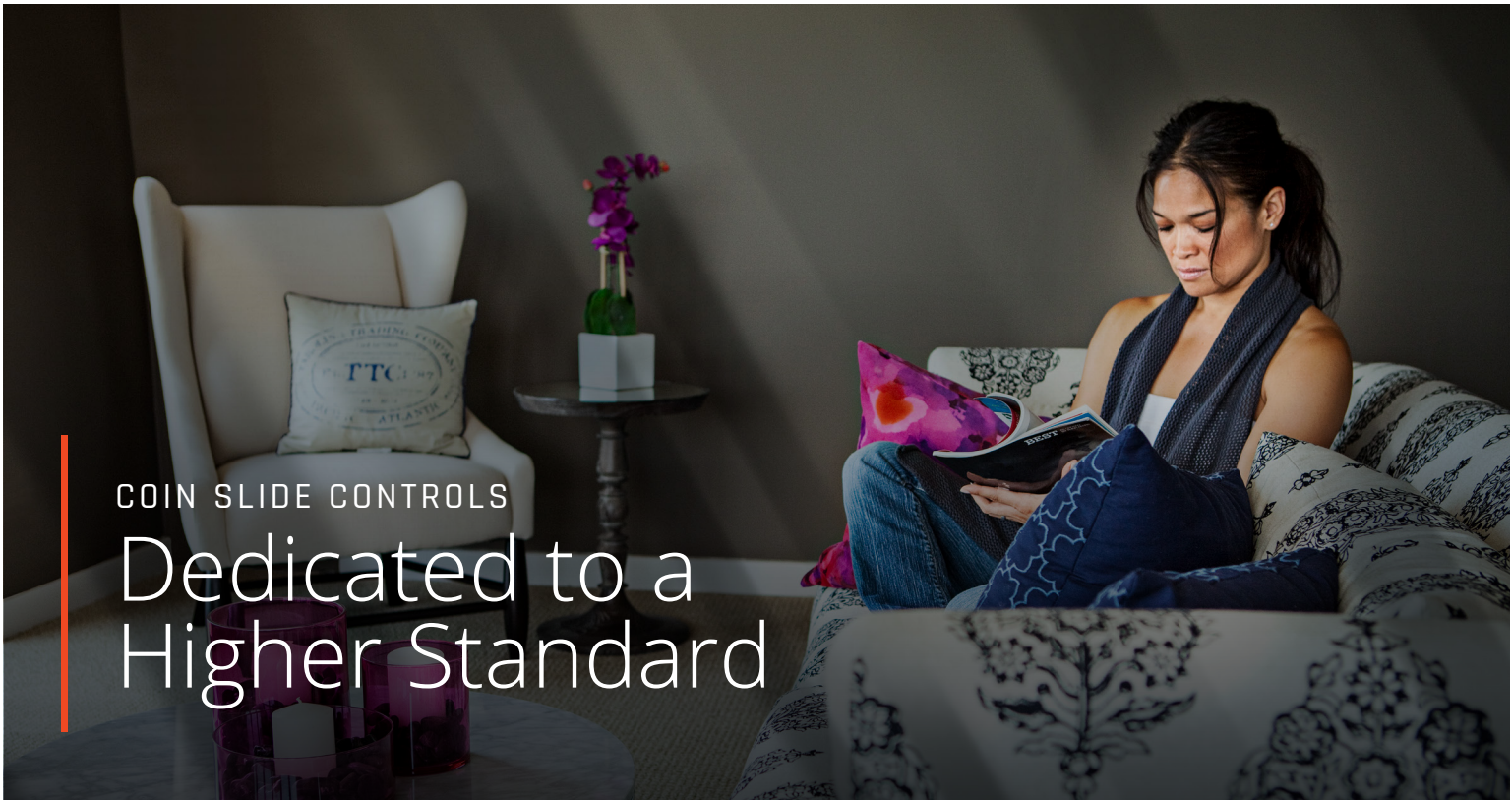

COIN SLIDE CONTROLS

Dedicated to a Higher Standard

We are the world's largest commercial laundry company, with an undeniable history of proven performance and reliability. Property owners rely on the practical ingenuity of features designed to make their lives simpler and more productive. Our commercial-grade construction is rugged, dependable and built to last.

As the commercial laundry industry leader, our valuable network of authorized laundry service providers is in place to provide you with the time and attention you deserve. Your local laundry service provider can assist you with laundry solutions for your property, including a space saving design, cost efficient equipment and business control systems.

Optimizing Laundry Room Efficiency

Our straight forward design and commercial-grade construction help make your life simpler and more productive, thanks to the practical ingenuity of features designed to reduce utility expenses without sacrificing performance. Coin slide controls are easy to use and offer the basic features needed for optimal coin-vended laundry room operations.

- **Six Wash Cycles:**
Features six total cycles, including three "water saver" cycles: Normal, Perm Press and Delicate.
- **Three Wash Temperatures:**
Offers user-selected options for Hot, Warm or Cold wash temperatures.
- **Four Dryer Heat Cycle Options:**
Choose from Normal, Perm Press, Delicate and No Heat.

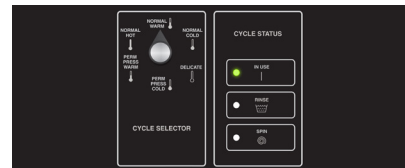

Top Load Washer - Two Speed Control

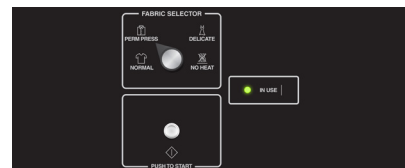

Single Load Dryer Control

COMMERCIAL WASHERS & DRYERS

Built for Reliable Performance.

Top Load Washer

Speed Queen® top load washers are constructed from heavy-duty components to ensure an extended life, including a stainless steel washtub, all-metal transmission and a commercial-grade cabinet finish.

- Commercial-grade stainless steel washtub standard.
- Curved four-vane agitator delivers an industry-best 210° wash stroke that produces unparalleled cleaning results.
- Extract speed of 710 RPM spins clothes out drier.
- Advanced suspension system eliminates the possibility of an unbalanced load issue.



Single Load Dryer

With an easy-to-clean large lint compartment and a reversible door to accommodate your laundry design, Speed Queen® single dryers are designed to suit any laundry's specific needs. The 2.06 sq. ft. door opening is the largest in the industry, providing easy loading and unloading for residents.

- Durable galvanized steel cylinder with an extra-large 7.0 cu. ft. capacity.
- High efficiency exhaust blower with superior airflow of 220 cfm.
- Secured and easy to clean upfront lint filter.
- Front access for easy serviceability.
- Reversible door for installation flexibility.

