

# GDE23GGH

## GE® ENERGY STAR® 23.2 Cu. Ft. Bottom-Freezer Refrigerator

### Dimensions and Installation Information (in inches)

Overall Dimensions	Height to top of crown (in.) <b>A</b>	69-3/4
	Height to top of hinge (in.) <b>B</b>	68-1/4
	Height to top of case (in.) <b>C</b>	67-7/8
	Case depth without door (in.) <b>D</b>	28-1/4
	Case depth less door handle (in.) <b>E</b>	32-3/8
	Case depth with door handle (in.) <b>F</b>	34-3/8
	Depth with fresh food door open 90° (in.) <b>G</b>	62-3/4
	Width (in.) <b>H</b>	32-3/4
	Width with door open 90° inc. door handle (in.) <b>I</b>	36
Air	Each side (in.)	1/8
	Top (in.)	1
	Back (in.)	2

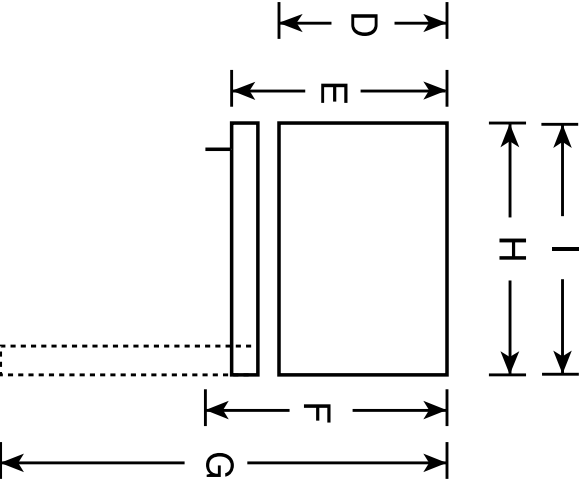
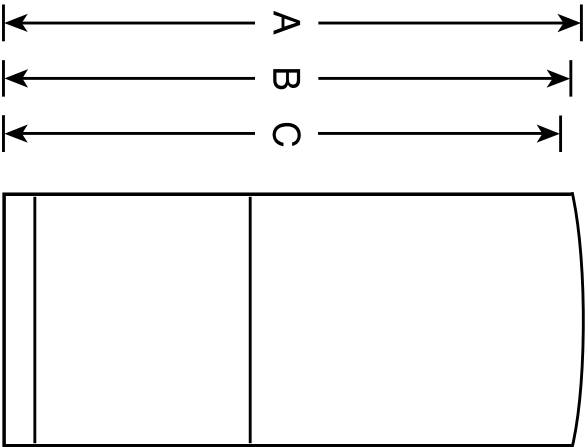

For answers to your Monogram®, GE Profile™ or GE® appliance questions, visit our website at [ge.com](http://ge.com) or call GE Answer Center® service, 800.626.2000.



imagination at work



Listed by  
Underwriters  
Laboratories



As an ENERGY STAR® partner, GE has determined that this product meets the ENERGY STAR guidelines for energy efficiency.

# GDE23GGH

GE® ENERGY STAR® 23.2 Cu. Ft. Bottom-Freezer Refrigerator

## Features and Benefits

- 33" wide
- Factory-installed icemaker - Refrigerator comes ready to automatically create ice
- Upfront temperature controls - Easy-to-use controls regulate both fresh food and freezer sections
- Adjustable humidity drawers - Keep fruits and vegetables fresh
- Adjustable glass shelves - A variety of shelf configurations provide additional options for food storage
- Two-level freezer baskets - Baskets allow easy access to frozen foods
- Model GDE23GGHWW - White
- Model GDE23GGHBB - Black

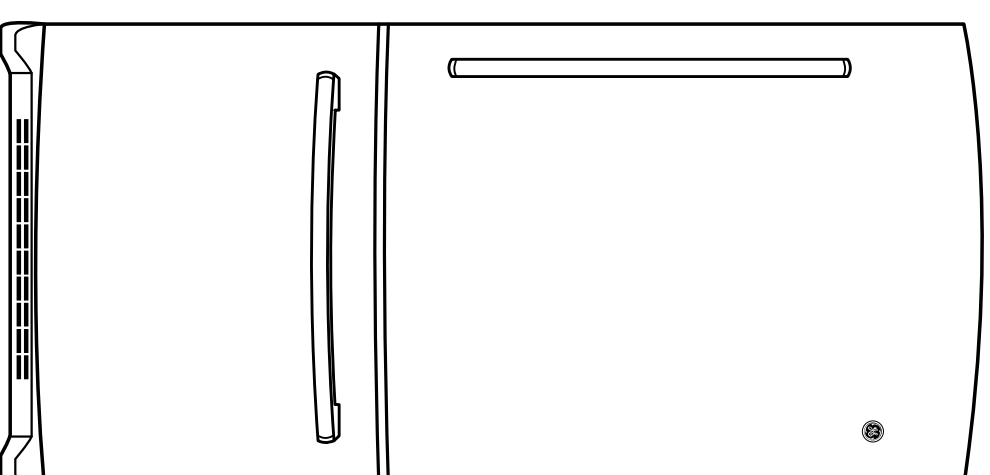

imagination at work



As an ENERGY STAR® partner, GE has determined that this product meets the ENERGY STAR guidelines for energy efficiency.

Specification Revised 7/14