



ASSEMBLY INSTRUCTIONS

I-EFP-C001

PRODUCT IMAGE SHOWN IS FOR ILLUSTRATIVE PURPOSES ONLY, SHOULD NOT BE TAKEN AS REFERENCE POINT

INSTRUCTIONS (A)

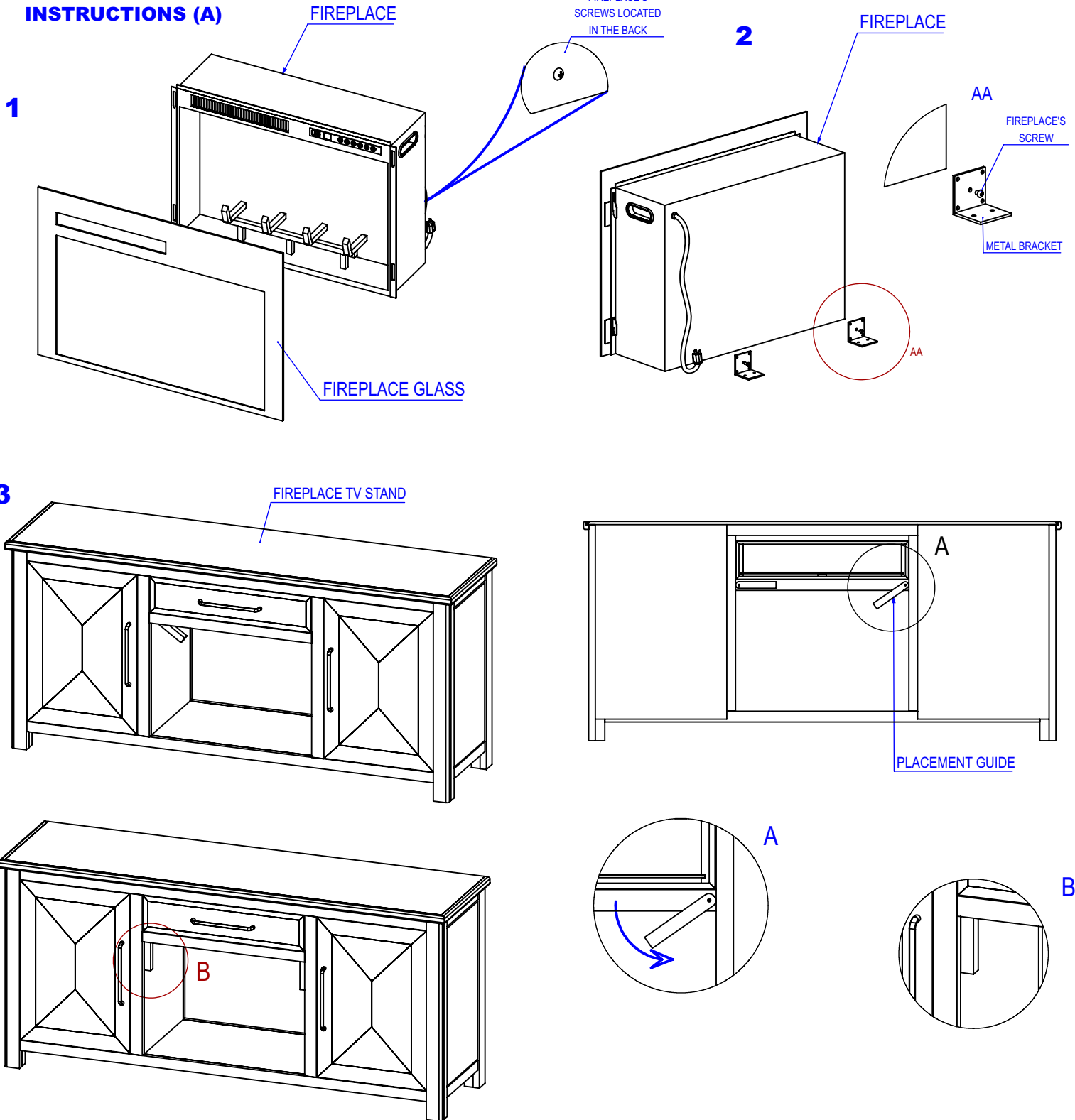

INSTRUCTION:

1. BEFORE START ASSEMBLING THE FIREPLACE IN THE FURNITURE, YOU MUST TAKE OUT THE FIREPLACE AND THE SCREWS, YOU WILL USE THEM LATER. SCREW THE METAL BRACKETS TO THE FIREPLACE BACK.
2. FOR INSTALL THE FIREPLACE IN THE TV STAND USE THE PLACEMENT GUIDE, IS LOCATED BEHIND THE FRONT BRACKET AS SHOWN IN PICTURE 2. TURN BOTH DOWN AND PLACE VERTICALLY AS SHOWN IN PICTURE "A" AND "B"



ASSEMBLY INSTRUCTIONS

I-EFP-C001

PRODUCT IMAGE SHOWN IS FOR ILLUSTRATIVE PURPOSES ONLY, SHOULD NOT BE TAKEN AS REFERENCE POINT

4

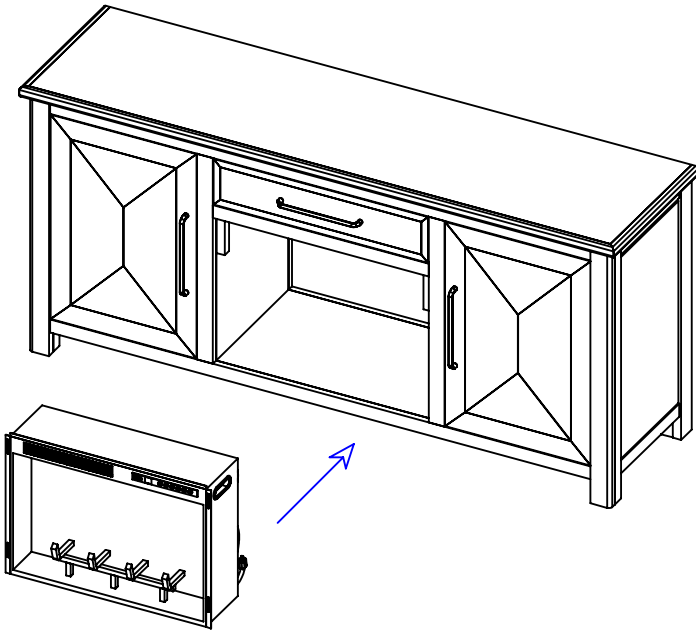

5

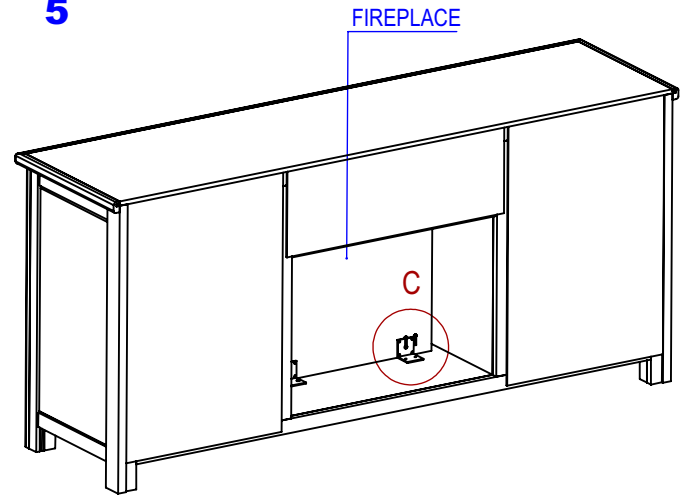

FLAT HEAD SCREW 6 x 3/4"

C

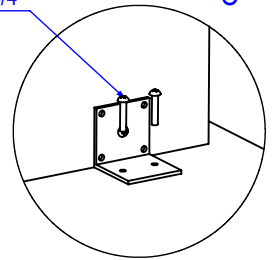

6

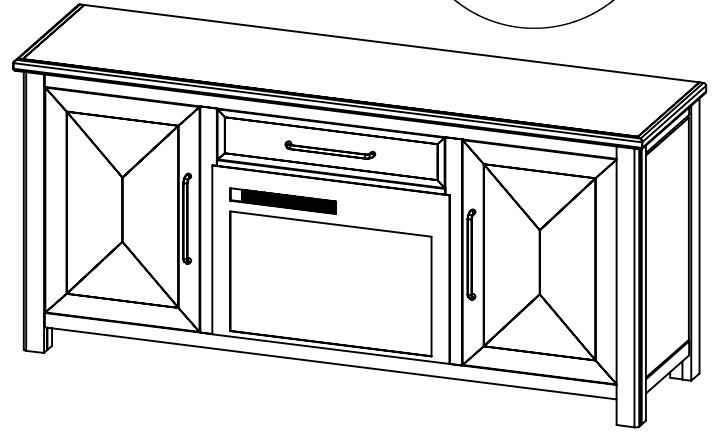
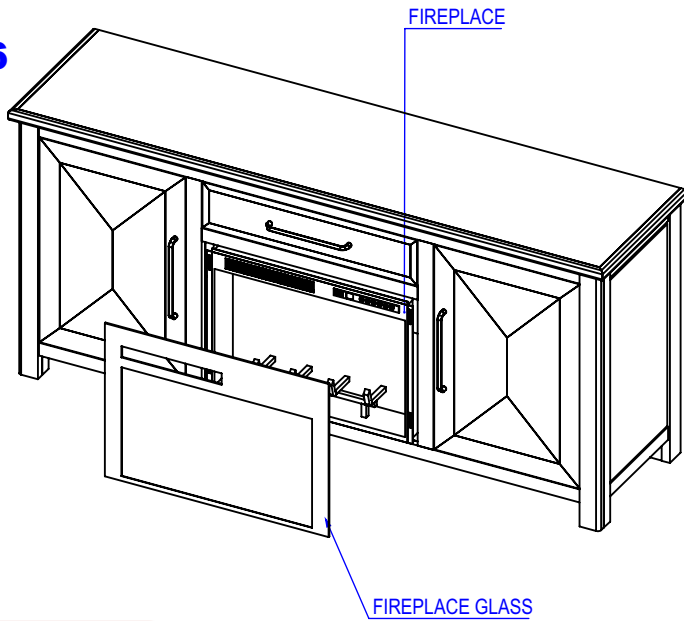

SCAN ME

TUTORIAL VIDEO



SCAN ME

TUTORIAL VIDEO

HARDWARE

DESCRIPTION	#PCS
FLAT HEAD SCREW 6 x 3/4"	4

INSTRUCTION:

- WITH SOMEONE HELP, PUT THE FIREPLACE IN THE FURNITURE AND SCREW THE METAL BRACKETS THAT GOES ON THE BACK TO THE FURNITURE AS SHOW IN PICTURE "C".
- PUT THE GLASS PANEL IN THE FIREPLACE.